

**SURVEY & REMONUMENTATION**

FEB 11 1998

Approved by Menominee County  
Land Survey Remonumentation  
Peer Group Under Act 345 Of  
P.A. of 1990 On 12/13 1997  
Ma Davis PLS  
Chairman

**SECTION**

**LAND CORNER RECORDATION CERTIFICATE**  
Filing Requirement of Act 74, Mich. P.A. 1970

For corners in  
MENOMINEE  
(County)

Located In:	Corner Code #
T <u>34N</u> R <u>27W</u>	<u>K-04</u>
T <u>    </u> R <u>    </u>	<u>    </u>
T <u>    </u> R <u>    </u>	<u>    </u>
T <u>    </u> R <u>    </u>	<u>    </u>
S <u>    </u> T <u>    </u> R <u>    </u>	<u>    </u>
S <u>    </u> T <u>    </u> R <u>    </u>	<u>    </u>
S <u>    </u> T <u>    </u> R <u>    </u>	<u>    </u>
S <u>    </u> T <u>    </u> R <u>    </u>	<u>    </u>

- 1. Public Land Survey
- 2. Property Controlling in Section
- 3. Miscellaneous Property in Sec.

REGISTERED FOR RECORD  
97 DEC 22 AM 11:28  
595 BKS  
BARBARA JOHNSON  
REGISTERED SURVEYORS  
Register of Deeds Stamp & File Number

- 4. Lot No. \_\_\_\_\_, Recorded Plat \_\_\_\_\_
- 5. Private Claims \_\_\_\_\_

I, William Lenca, in a field survey on June 11, 1997 do hereby state that under requirements of P.A. 74, Michigan P.A. of 1970, the corner points mentioned in lines 1 and 2 above were in conformance with regulations and rules therefore as required in the current manual of survey instructions of the United States Department of the Interior, Bureau of Land Management or by a decree of a Court of Law and for that the corner points mentioned in lines 3, 4 and 5 above were in conformance with the rules of the Michigan Board of Land Surveyors or by a Decree of a Court of Law; established, re-established, monumented, recovered, found as expressed below.

NOTE: Not more than 2 corners, all in the same town and range, may be recorded on this certificate.

	A	B	C	D	E	F	G	H	I	J	K	L	M
1													
2	6	5	4	3	2	1							
3													
4	7	8	9	10	11	12							
5													
6	18	17	16	15	14	13							
7													
8	19	20	21	22	23	24							
9													
10	30	29	28	27	26	25							
11													
12	31	32	33	34	35	36							
13													

A. Description of original monument and accessories and/or subsequent restoration:

1848: Original Survey by James H. Mullett - B.T.'s - Alder, 3" - N52°E - 22 lks.; Spruce, 6" - S03°W - 1.32 lks. All original evidence for this corner has been destroyed by county road improvements.

B. Description of corner evidence found and/or method applied in restoring or reestablishing corner:

My private records indicate that in a 1986 Survey, we set a 5/8" x 24" iron rod in line with ancient fences South - East and county road centerline to the North. We took the following ties: Elm, 8" - N45°E - 52.54' (Fd.); W. Ash, 4" - S52°E - 37.33' (Gone); Pole - S18°W - 26.63' (Gone); W. Ash, 5" - N08°W - 58.06' (Fd.). In our 1997 Remonumentation Survey, we found a 5/8" x 24" Iron in the centerline of a county road North and in line with old fences South and East. We also found two B.T.'s from a 1986 survey. This corner has been used by local surveyors for at least 11 years and is accepted as the best available evidence of the position of the original corner.

C. Description of monument for corner and accessories established to perpetuate locating the position of the corner:

Set 2" dia. Aluminum Pipe/3-1/4" dia. Alum cap stamped for corner location:

12" dia. Elm	N45°E	52.54 feet	Scr. NBT
5" dia. White Ash	N85°E	85.66 feet	Scr. NBT
9" dia. Elm	S30°W	49.56 feet	Scr. NBT
7" dia. White Ash	N13°W	58.06 feet	Scr. NBT
5/8" x 24" Iron Rod/2" dia. Alum. cap marked "WITNESS MARKER"	S04°W	27.16 feet	
Metal Survey Sign Post	S04°W	27.8 feet	

NOTE: All bearings are magnetic bearings. All distances are measured with steel tape. Distances to trees are to nail in side of tree.

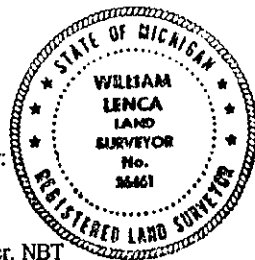

Signed by William Lenca  
Surveyor's Michigan License No. 26461

Date Nov. 18, 1997

595