

SURVEY & REMONUMENTATION

FEB 11 1998

Approved by Menominee County
Land Survey Remonumentation
Peer Group Under Act 345 Of

P.A. of 1990 On 12/18 199 2
McL Davis RLS
Chairman

SECTION

LAND CORNER RECORDATION CERTIFICATE

Filing Requirement of Act 74, Mich. P.A. 1970

For corners in
MENOMINEE
(County)

Located In:	Corner Code #
T <u>34N</u> R <u>27W</u>	<u>K-05</u>
T ___ R ___	_____
T ___ R ___	_____
T ___ R ___	_____
S ___ T ___ R ___	_____
S ___ T ___ R ___	_____
S ___ T ___ R ___	_____
S ___ T ___ R ___	_____

97 DEC 22 AM 11:28
BUREAU 596, BKS
REGISTERED LAND SURVEYOR
MICHIGAN STATE BOARD OF PROFESSIONAL SURVEYORS
Register of Deeds Stamp & File Number

4. Lot No. _____, Recorded Plat _____
5. Private Claims _____

I, William Lenca, in a field survey on Aug. 06, 19 97 do hereby state that under requirements of P.A. 74, Michigan P.A. of 1970, the corner points mentioned in lines 1 and 2 above were in conformance with regulations and rules therefore as required in the current manual of survey instructions of the United States Department of the Interior, Bureau of Land Management or by a decree of a Court of Law and/or that the corner points mentioned in lines 3, 4 and 5 above were in conformance with the rules of the Michigan Board of Land Surveyors or by a Decree of a Court of Law; established, re-established, monumented, recovered, found as expressed below:

NOTE: Not more than 2 corners, all in the same town and range, may be recorded on this certificate.

	A	B	C	D	E	F	G	H	I	J	K	L	M
1													
2	6		5		4		3		2		1		
3													
4	7		8		9		10		11		12		
5													
6	10		17		16		15		14		13		
7													
8	19		20		21		22		23		24		
9													
10	30		29		28		27		26		25		
11													
12	31		32		33		34		35		36		
13													

A. Description of original monument and accessories and/or subsequent restoration:

- 1848: Original Survey by James H. Mullett - B.T.'s - Tamarack, 10" - S47°W - 21 lks.; Tamarack, 12" - N64°E - 10 lks. All original evidence for this corner has been destroyed by county road improvements.
- 1987: L.C.R.C. No. 770, recorded by William Lenca, RLS No. 26461, states "Found Railroad Spike in c/l of E - W Co. Rd. and in line with old fence to the North. This corner had been established and used by George B. Wilson, a registered land surveyor." TIES: 8" Ironwood - N28°E - 44.10'; Power Pole - S48°E - 55.35'; 12" W. Pine - S47°W - 62.16'; 6" Ironwood - N44°W - 49.32'.

B. Description of corner evidence found and/or method applied in restoring or reestablishing corner:

We found a railroad spike in the centerline of an East - West County Road and 4" below the surface of the pavement. This corner position fits well with long standing lines of occupation, matches well with measurements to other corners, and is accepted as the best available evidence of the position of the original corner.

C. Description of monument for corner and accessories established to perpetuate locating the position of the corner:

Set 5/8" x 24" Iron Rod/3-1/4" dia. Alum. cap stamped for corner location in Monument Box:

5" dia. Cedar	N20°E	31.05 feet	Scr. NBT
8" dia. Cedar	S21°E	56.65 feet	Scr. NBT
12" dia. White Pine	S47°W	62.20 feet	Scr. NBT
5" dia. White Ash	N49°W	60.94 feet	Scr. NBT
Metal Survey Sign Post	S02°W	26.3 feet	

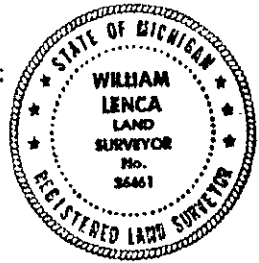

NOTE: All bearings are magnetic bearings. All distances are measured with steel tape. Distances to trees are to nail in side of tree.

Signed by William Lenca
Surveyor's Michigan License No. 26461

Date Nov. 18, 1997

596