

REMONUMENTATION

FEB 11 1998

Approved by Menominee County
Land Survey Remonumentation
Peer Group Under Act 345 Of
P.A. Of 1990 On 12/18 1997

SECTION

LAND CORNER RECORDATION CERTIFICATE Filing Requirement of Act 74, Mich. P.A. 1970

Mc Lewis RLS
Chairman
97 DEC 22 11:28
MICHIGAN STATE BOARD OF PROFESSIONAL SURVEYORS
REGISTERED LAND SURVEYORS

For corners in
MENOMINEE
(County)

Located In:	Corner Code #
T <u>34</u> N R <u>27</u> W	K-07
T ___ R ___	_____
T ___ R ___	_____
T ___ R ___	_____
S ___ T ___ R ___	_____
S ___ T ___ R ___	_____
S ___ T ___ R ___	_____
S ___ T ___ R ___	_____

- Public Land Survey
- Property Controlling in Section
- Miscellaneous Property in Sec.

Register of Deeds Stamp & File Number

4. Lot No. _____, Recorded Plat _____
5. Private Claims _____

I, William Lenca, in a field survey on July 23, 1997 do hereby state that under requirements of P.A. 74, Michigan P.A. of 1970, the corner points mentioned in lines 1 and 2 above were in conformance with regulations and rules therefore as required in the current manual of survey instructions of the United States Department of the Interior, Bureau of Land Management or by a decree of a Court of Law and /or that the corner points mentioned in lines 3, 4 and 5 above were in conformance with the rules of the Michigan Board of Land Surveyors or by a Decree of a Court of Law; established, re-established, monumented, recovered, found as expressed below:

NOTE: Not more than 2 corners, all in the same town and range, may be recorded on this certificate.

1	A	B	C	D	E	F	G	H	I	J	K	L	M
2		6	5		4		3		2		1		
3													
4		7		8		9		10		11		12	
5													
6		18		17		16		15		14		13	
7													
8		19		20		21		22		23		24	
9													
10		30		29		28		27		26		25	
11													
12		31		32		33		34		35		36	
13													

A. Description of original monument and accessories and/or subsequent restoration:

- 1848: Original Survey by James H. Mullett - B.T.'s - Tamarack, 14" - N69°E - 15 lks.; Tamarack, 12" - S51.5°E - 29 lks. All original evidence for this corner has been destroyed by county road improvements.
- 1978: L.C.R.C. No. 176 by George B. Wilson, RLS No. 17607, states "Found old fence line running South and North from corner - Used this as best evidence available." Set 4" square conc. mon. 33 feet S. of corner - set 1/2" iron pin at corner.
- 1981: L.C.R.C. No. 310 by William Lenca, RLS 26461, states, "Found P.K. in centerline of East - West County Road and found 4" square monument 33' south and in line with ancient fence line to the south." - Set railroad spike - TIES: W. Ash, 8" - S08°E - 22.75'; W. Ash, 10" - S64°W - 54.03'; W. Birch, 6" - N64°W - 69.95'; Aspen, 6" - N48°E - 64.73'.

B. Description of corner evidence found and/or method applied in restoring or reestablishing corner:

We found a P.K. Nail set over the top of a Railroad Spike 1 foot North of the centerline of an East - West County Road and 33.04 feet North of an existing 4 inch square concrete monument as described in L.C.R.C. 176. This corner falls in line with an ancient fence lines running North and South, fits well with measurements to other corners in the area, has been accepted and used by local surveyors for many years and is accepted as the best available evidence of the position of the original corner.

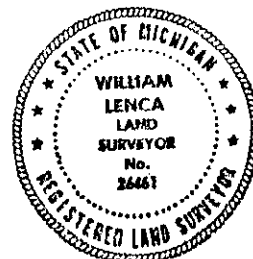

C. Description of monument for corner and accessories established to perpetuate locating the position of the corner:

Set 5/8" x 24" Iron Rod/3-1/4" dia. Alum. cap stamped for corner location in Monument Box:

12" dia. White Ash	N49°E	73.01 feet	Scr. NBT
4" Square Concrete Monument	South	33.04 feet	
8" dia. Double Maple	S66°W	70.96 feet	Scr. NBT
6" dia. White Ash	N44°W	50.14 feet	Scr. NBT
Metal Survey Sign Post	South	34.1 feet	

NOTE: All bearings are magnetic bearings. All distances are measured with steel tape. Distances to trees are to nail in side of tree.

Signed by William Lenca
Surveyor's Michigan License No. 26461

Date Nov. 18, 1997