

P.A. Of 1990 On 10/20 199 95
Chairman
Mike Smith BUS

LAND CORNER RECORDATION CERTIFICATE
Filing Requirement of Act 74, Mich. P.A. 1970

For corners in
MENOMINEE
(County)

Located In: 34N 27W Corner Code K-12

1. Public Land Survey	T	_____	R	_____	_____
	T	_____	R	_____	_____
	T	_____	R	_____	_____
	T	_____	R	_____	_____
2. Property Controlling in Section	S	_____	T	_____	R
	S	_____	T	_____	R
3. Miscellaneous Property in Sec.	S	_____	T	_____	R
	S	_____	T	_____	R

4. Lot No. _____, Recorded Plat _____

5. Private Claims _____

RECEIVED FOR RECORD
DEC 27 PM 3:30
ARSENIA RAMBERSON
REGISTERED CLERK
MENOMINEE COUNTY

Register of Deeds Stamp & File Number

I, William Lenca, in a field survey on Jun. 19 1995, do hereby certify that under requirements of P.A. 74, Michigan P.A. of 1970, the corner points mentioned in lines 1 and 2 above were in conformance with regulations and rules therefore as required in the current manual of survey instructions of the United States Department of the Interior, Bureau of Land Management or by a decree of a Court of Law and/or that the corner points mentioned in lines 3, 4 and 5 above were in conformance with the rules of the Michigan Board of Land Surveyors or by a Decree of a Court of Law; established, re-established, monumented, re-monumented, recovered, found as expressed below:

A	B	C	D	E	F	G	H	I	J	K	L
2	6	5	4	3	2						
3											
4	7	8	9	10	11	12					
5											
6	16	17	18	15	14	13					
7											
8	19	20	21	22	23	24					
9											
10	30	29	28	27	26	25					
11											
12	31	32	33	34	35	36					
13											

NOTE: Not more than 4 corners, all in the same town and range, may be recorded on this certificate.

- A. Description of original monument and accessories and/or subsequent restoration:
- 1848: Original Survey by James H. Mullett - B.T.'s - Cedar, 10" - S13°W - 17 lks; Hemlock, 14" - N40°E - 14 lks. All original evidence for this corner has been destroyed by county road improvements.
 - 1981: Certified Survey No. 215 recorded by William Lenca, RLS No. 26461, shows this corner in relation to other corners in Sections 35 and 36. The corner is shown as being at a single proportionate position. No corner monument or ties were established.
 - 1982: Certified Survey No. 303 recorded by George B. Wilson, RLS No. 17607, shows this corner in relation to other corners in Section 35. The corner is shown as being at a single proportionate position. The corner monument is not described and no ties are given.

B. Description of corner evidence found and/or method applied in restoring or reestablishing corner:

In a 1995 survey in Section 36, T34N-R27W, we recovered the NW and SW Corners of said section and measured the distance between them. We found that this distance matched with the recorded distance shown in Certified Surveys 215 and 303. We established the single proportioned position and searched this area. We found no corner monument or occupation which would indicate a corner position. We therefore established the corner at the single proportionate position as shown in Certified Surveys 215 and 303, and accepted this location as a careful and faithful reestablishment of the position of the original corner.

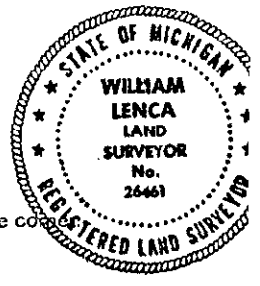

- C. Description of monument for corner and accessories established to perpetuate locating the position of the corner:
- Set 5/8" x 24" Iron Rod/3-1/4" dia. Alum. cap stamped for corner location:
- | | | | |
|---|-------|------------|----------|
| 9" dia. Cedar | S36°E | 64.58 feet | Scr. NBT |
| North Gate Post - (3-1/2" dia. iron pipe) | S23°E | 56.83 feet | |
| 5" dia. Cedar | S68°W | 27.48 feet | Scr. NBT |
| 6" dia. Cedar | N21°W | 54.67 feet | Scr. NBT |
| Metal Survey Sign Post | S71°E | 34.0 feet | |

NOTE: All bearings are magnetic bearings. All distances are measured with a steel tape. Distances to trees are to nail in side of tree.

Signed by William Lenca Date Nov. 04, 1995
Surveyor's Michigan License No. 26461