

SURVEY & REMONUMENTATION

FEB 11 1998

Approved by Menominee County
 Land Survey Remonumentation
 Peer Group Under Act 345 Of
 P.A. of 1990 On 12/18 1997
Mac Davis PLS
 Chairman

SECTION

LAND CORNER RECORDATION CERTIFICATE Filing Requirement of Act 74, Mich. P.A. 1970

For corners in
MENOMINEE
 (County)

Located In:	Corner Code #
T <u>34</u> N R <u>27</u> W	<u>L-03</u>
T _____ R _____	_____
T _____ R _____	_____
T _____ R _____	_____
S _____ T _____ R _____	_____
S _____ T _____ R _____	_____
S _____ T _____ R _____	_____
S _____ T _____ R _____	_____

REGISTERED FOR RECORD
 97 DEC 22 PM 11:28
 600, BK 5
 REGISTERED FOR RECORD
 Register of Deeds Stamp & File Number

4. Lot No. _____, Recorded Plat _____
 5. Private Claims _____

I, William Lenca, in a field survey on July 31, 1997 do hereby state that under requirements of P.A. 74, Michigan P.A. of 1970, the corner points mentioned in lines 1 and 2 above were in conformance with regulations and rules therefore as required in the current manual of survey instructions of the United States Department of the Interior, Bureau of Land Management or by a decree of a Court of Law and for that the corner points mentioned in lines 3, 4 and 5 above were in conformance with the rules of the Michigan Board of Land Surveyors or by a Decree of a Court of Law; established, re-established, monumented, recovered, found as expressed below:

	A	B	C	D	E	F	G	H	I	J	K	L	M
1													
2	6		5		4		3		2		1		
3													
4	7		8		9		10		11		12		
5													
6	13		17		16		15		14		13		
7													
8	19		20		21		22		23		24		
9													
10	30		29		28		27		26		25		
11													
12	31		32		33		34		35		36		
13													

NOTE: Not more than 2 corners, all in the same town and range, may be recorded on this certificate.

A. Description of original monument and accessories and/or subsequent restoration:

1848: Original Survey by James H. Mullett - B.T.'s - Cedar, 10" - N80°W - 14 lks.; Cedar, 10" - S68°W - 22 lks. All original evidence for this corner has been destroyed by county road improvements.

B. Description of corner evidence found and/or method applied in restoring or reestablishing corner:

We recovered a railroad spike in the centerline of an East - West County Road and in line with an old fence running North. This position fits within a few feet of being M.P.O.L., has been used by local surveyors for several years and is accepted as the best available evidence of the position of the original corner.

C. Description of monument for corner and accessories established to perpetuate locating the position of the corner:

Set 5/8" x 24" Iron Rod/3-1/4" dia. Alum. cap stamped for corner location in Monument Box:

5" dia. Cedar	N07°E	45.98 feet	Scr. NBT
5" dia. White Ash	N46°E	50.59 feet	Scr. NBT
4" dia. Balsam	S19°E	32.07 feet	Scr. NBT
10" dia. Double White Ash	S56°W	53.72 feet	Scr. NBT
Metal Survey Sign Post	S05°W	27.3 feet	

NOTE: All bearings are magnetic bearings. All distances are measured with steel tape. Distances to trees are to nail in side of tree.

Signed by William Lenca
 Surveyor's Michigan License No. 26461

Date Dec. 03, 1997

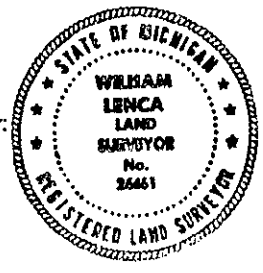

600