

FEB 11 1998

Approved by Menominee County Land Survey Remonumentation Peer Group Under Act 345 Of P.A. Of 1990 On 12/18, 199 2  
McC. Davis, PLS  
Chairman

SECTION

LAND CORNER RECORDATION CERTIFICATE  
Filing Requirement of Act 74, Mich. P.A. 1970

For corners in  
MENOMINEE  
(County)

Located In: Corner Code #  
T34N R 27W M-08  
T 34 R 26 A-08  
T     R          
S     T     R          
S     T     R          
S     T     R          
S     T     R        

REGISTERED LAND SURVEYOR  
97 DEC 22 AM 11:29  
PAGE # 609 BKS  
REGISTERED LAND SURVEYOR  
Register of Deeds Stamp & File Number

4. Lot No. \_\_\_\_\_, Recorded Plat \_\_\_\_\_  
5. Private Claims \_\_\_\_\_  
(SAME AS CORNER A-08, T34N - R26W)

I, William Lenca, in a field survey on July 02, 1997 do hereby state that under requirements of P.A. 74, Michigan P.A. of 1970, the corner points mentioned in lines 1 and 2 above were in conformance with regulations and rules therefore as required in the current manual of survey instructions of the United States Department of the Interior, Bureau of Land Management or by a decree of a Court of Law and for that the corner points mentioned in lines 3, 4 and 5 above were in conformance with the rules of the Michigan Board of Land Surveyors or by a Decree of a Court of Law; established, re-established, monumented, recovered, found as expressed below:

NOTE: Not more than 2 corners, all in the same town and range, may be recorded on this certificate.

1	A	B	C	D	E	F	G	H	I	J	K	L	M
2	6		5		4		3		2		1		
3													
4	7		8		9		10		11		12		
5													
6	18		17		16		15		14		13		
7													
8	19		20		21		22		23		24		
9													
10	30		29		28		27		26		25		
11													
12	31		32		33		34		35		36		
13													

A. Description of original monument and accessories and/or subsequent restoration:

1847: Original Survey by H. Floyd - B.T.'s - Y. Birch, 6" - N55°W - 22 lks.; Cedar, 8" - S70°W - 21 lks. All original evidence for this corner has been destroyed by county road improvements.

B. Description of corner evidence found and/or method applied in restoring or reestablishing corner:

No evidence of the original corner accessories, or evidence of a subsequent restoration was found. We therefore set this corner midway between the Northeast and Southeast corners of Section 24, T34N - R27W and in the centerline of a North - South County Road, and accepted this location as the best available evidence of the position of the original corner.

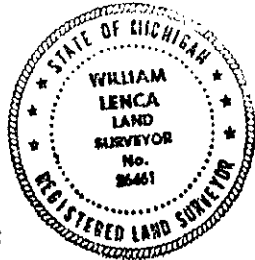

C. Description of monument for corner and accessories established to perpetuate locating the position of the corner:

Set 5/8" x 24" Iron Rod/3-1/4" dia. Alum. cap stamped for corner location in Monument Box:

5/8" x 24" Iron Rod/2" dia. Alum. cap marked "WITNESS MARKER"	N50°E	39.55 feet	1.0' S. of P.P.
5/8" x 24" Iron Rod/2" dia. Alum. cap marked "WITNESS MARKER"	S42°E	44.19 feet	3.0' S.W. of Tel. Box
8" dia. White Ash	S47°W	84.88 feet	Scr. NBT
4" dia. Double White Ash	N39°W	68.00 feet	Scr. NBT
Metal Survey Sign Post	N50°E	40.5 feet	

NOTE: All bearings are magnetic bearings. All distances are measured with steel tape. Distances to trees are to nail in side of tree.

Signed by William Lenca  
Surveyor's Michigan License No. 26461

Date Dec. 12, 1997