

SURVEY & REMONUMENTATION

FEB 11 1998

SECTION

Approved by Menominee County
Land Survey Remonumentation
Peer Group Under Art 345 Of
P.A. Of 1990 On 12/13, 1992
Mike Davis P.L.S.
Chairman

LAND CORNER RECORDATION CERTIFICATE
Filing Requirement of Act 74, Mich. P.A. 1970

For corners in MENOMINEE (County)	Located In:	Corner Code #
1. Public Land Survey	T <u>34</u> N R <u>27</u> W	<u>M-09</u>
	T <u>34</u> N R <u>26</u> W	<u>A-09</u>
2. Property Controlling In Section	S <u> </u> T <u> </u> R <u> </u>	<u> </u>
3. Miscellaneous Property in Sec.	S <u> </u> T <u> </u> R <u> </u>	<u> </u>

97 DEC 22 11:29
610, BKS
REGISTER OF DEEDS
MENOMINEE COUNTY
Register of Deeds Stamp & File Number

4. Lot No. _____, Recorded Plat _____
5. Private Claims _____
(SAME AS CORNER A-09 T34N-R26W)

William Lenca, in a field survey on July 02, 1997 do hereby state that under requirements of P.A. 74, Michigan P.A. of 1970, the corner points mentioned in lines 1 and 2 above were in conformance with regulations and rules therefore as required in the current manual of survey instructions of the United States Department of the Interior, Bureau of Land Management or by a decree of a Court of Law and for that the corner points mentioned in lines 3, 4 and 5 above were in conformance with the rules of the Michigan Board of Land Surveyors or by a Decree of a Court of Law, established, re-established, monumented, recovered, found as expressed below.

NOTE: Not more than 2 corners, all in the same town and range, may be recorded on this certificate.

A	B	C	D	E	F	G	H	I	J	K	L	M
1												
2	6	5	4	3	2	1						
3												
4	7	8	9	10	11	12						
5												
6	18	17	16	15	14	13						
7												
8	19	20	21	22	23	24						
9												
10	30	29	28	27	26	25						
11												
12	31	32	33	34	35	36						
13												

A. Description of original monument and accessories and/or subsequent restoration:

- 1847: Original Survey - Township Boundary by H. Floyd - B.T.'s - Tamarack, 8" - N25°W - 10 lks.; Tamarack, 11" - S26°W - 07 lks. All original evidence for this corner has been destroyed by county road improvements.
- 1848: Original Survey - Sectional Subdivision by James H. Mullett - B.T.'s - Cedar, 10" - S38°E - 17 lks.; Tamarack, 12" - N35°W - 06 lks. All original evidence for this corner has been destroyed by county road improvements.
- 1922: County Surveyor Edward Paulsen used this corner in his survey and states it is in the center of a county road intersection.
- 1997: Plat of Survey by William Lenca shows this corner in relation to other corners in Section 25, T34N - R27W and describes it as "Ex. 5/8" iron".

B. Description of corner evidence found and/or method applied in restoring or reestablishing corner:

We recovered a 5/8 inch diameter iron rod in the centerline of county roads running North - South - East - West. This corner position fits well with other corners in the area, has been used by local surveyors for several years, and is accepted as the best available evidence of the position of the original corner.

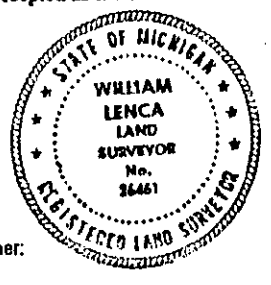

C. Description of monument for corner and accessories established to perpetuate locating the position of the corner:

Set 5/8" x 24" Iron Rod/3-1/4" dia. Alum. cap stamped for corner location in Monumental Box:

7" dia. Elm	N58°E	82.82 feet	Scr. NBT
5/8" x 24" Iron Rod/2" dia. Alum. cap marked "WITNESS MARKER"	S26°E	89.98 feet	3' N.W. of Tcl. Box
8" dia. White Ash	S40°W	94.74 feet	Scr. NBT
5/8" x 24" Iron Rod/2" dia. Alum. cap marked "WITNESS MARKER"	N38°W	45.11 feet	1' N. of Road Sign
Metal Survey Sign Post (2' N.W. of Tcl. Box)	S26°E	91.0 feet	

NOTE: All bearings are magnetic bearings. All distances are measured with steel tape. Distances to trees are to nail in side of tree.

Signed by William Lenca Date Dec. 12, 1997
Surveyor's Michigan License No. 26461

610