

FEB 11 1998

SECTION

Approved by Menominee County Land Survey Remonumentation Peer Group Under Act 345 Of P.A. of 1990 On 12/13/97 Chairman

LAND CORNER RECORDATION CERTIFICATE Filing Requirement of Act 74, Mich. P.A. 1970

For corners in MENOMINEE (County)

Table with columns: Located In, Corner Code #. Includes entries for T34N R 27W (M-10) and T34 R 26W (A-10).

Register of Deeds Stamp & File Number. Includes stamp: 97 DEC 22 AM 11:29 and handwritten file number 611 BK5.

4. Lot No. _____, Recorded Plat _____
5. Private Claims _____
(SAME AS CORNER A-10 T34N-R26W)

Grid table with columns A-L and rows 1-13. Contains numerical data for each cell.

I, William Lenca, in a field survey on Nov. 25, 1997 do hereby state that under requirements of P.A. 74, Michigan P.A. of 1970, the corner points mentioned in lines 1 and 2 above were in conformance with regulations and rules therefore as required in the current manual of survey instructions of the United States Department of the Interior, Bureau of Land Management or by a decree of a Court of Law and for that the corner points mentioned in lines 3, 4 and 5 above were in conformance with the rules of the Michigan Board of Land Surveyors or by a Decree of a Court of Law, established, re-established, monumented, recovered, found as expressed below.

NOTE: Not more than 2 corners, all in the same town and range, may be recorded on this certificate.

A. Description of original monument and accessories and/or subsequent restoration:

- 1847: Original Survey by H. Floyd - B.T.'s - Elm, 6" - N85°W - 19 lks.; Elm, 8" - S64°W - 55 lks. All original evidence for this corner has been destroyed by county road improvements.
1895: Plat of Survey by Justus Little shows this corner in relation to other corners in Section 30, T34N - R26W. No monument is described and no witnesses are given.
1997: Plat of Survey by William Lenca shows this corner as it relates to other corners in Section 25, T34N-R27W, and states that a railroad spike was set.

B. Description of corner evidence found and/or method applied in restoring or reestablishing corner:

We recovered a railroad spike 4.5' West of the centerline of a North - South county road. This corner was established in the centerline of county roads North, South, and East, but new construction has moved the North - South centerline 4.5' to the East. The corner falls in line with the centerline of a county road running East and fits with the 1/16 fence to the North. We accepted this location as the best available evidence of the position of the original corner.

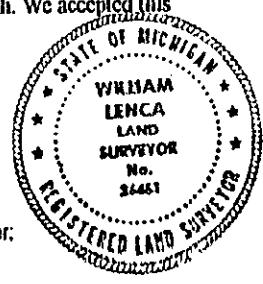

C. Description of monument for corner and accessories established to perpetuate locating the position of the corner:

Set 5/8" x 24" Iron Rod/3-1/4" dia. Alum. cap stamped for corner location in Monument Box:

Table listing monument details: 6" dia. White Ash (N58°E, 64.25 feet, Scr. NBT), 5/8" x 24" Iron Rod/2" dia. Alum. cap marked "WITNESS MARKER" (S52°E, 44.90 feet, 1' S. of Road Sign), 9" dia. White Ash (S62°W, 52.34 feet, Scr. NBT), 7" dia. White Ash (N37°W, 59.37 feet, Scr. NBT), Metal Survey Sign Post (West, 34.6 feet).

NOTE: All bearings are magnetic bearings. All distances are measured with steel tape. Distances to trees are to nail in side of tree.

Signed by William Lenca, Surveyor's Michigan License No. 26461

Date Dec. 12, 1997

611