

LAND CORNER RECORDATION CERTIFICATE
Filing Requirement of Act 74, Mich. P.A. 1970

For corners in
Menominee

(County)

Located In:

Corner Code =//

- 1. Public Land Survey T 35N R 25W M1
2. Property Controlling in Section S 11 T 35N R 25W 8
3. Miscellaneous Property in Sec. S T R

Register of Deeds Stamp & File Number

- 4. Lot No. Recorded Plat
5. Private Claims

8 February 28, 1996

I, Paul R. Bressette, in a field survey on M1 January 25, 1996, do hereby certify that under requirements of P.A. 74, Michigan P.A. of 1970, the corner points mentioned in lines 1 and 2 above were in conformance with regulations and rules therefore as required in the current manual of survey instructions of the United States Department of the Interior, Bureau of Land Management or by a decree of a Court of Law and/or that the corner points mentioned in lines 3, 4 and 5 above were in conformance with the rules of the Michigan Board of Land Surveyors or by a Decree of a Court of Law; established, re-established, monumented, re-monumented, recovered, found as expressed below:

NOTE: Not more than 4 corners, all in the same town and range, may be recorded on this certificate.

Grid table with columns A-M and rows 2-13. A dot is marked at the intersection of column I and row 4.

A. Description of original monument and accessories and/or subsequent restoration:

(M1) Section corner common to Sections 1, 36, 31 and 6 (Township corner). 1847: Henry Floyd, D.S. Set wood post witnessed by: Cedar 6 N25W 12 links; Cedar 8 S67W 6 links; Fir 5 N74E 27 links; Cedar 6 S55E 20 links. Used in subsequent original surveys by John Mullett, D.S. and James Mullett, D.S. 1955: Billy D. Buckler, RLS. Set 1" iron pipe w/ 4" brass cap witnessed by: 10" Cedar S82E 24 links; 9" Cedar N75W 15 links. Location was rewitnessed by unknown surveyor with four old cedar stakes in place, two cedar stumps and a fir stump in place. No identifying marks found on any of the stumps.
(8) West One-sixteenth corner of Section 11. Not set in original survey, no evidence of subsequent establishment.

B. Description of corner evidence found and/or method applied in restoring or reestablishing corner:

(M1) Found monument and NW NBT as described by Buckler. NBT is now an 11" Cedar in good condition. Rewitnessed monument as found.
(8) Corner position established mid-point and on-line between the West and Center Quarter corners of Section 11.

C. Description of monument for corner and accessories established to perpetuate locating the position of the corner:

(M1) 1" iron pipe w/ 4" brass cap
09" Cedar N60E 4.4'
07" Cedar S52E 26.0'
08" Cedar S13W 21.5'
11" Cedar N68W 9.9' (old NBT)
All trees are blazed, scribed (Section number, NBT) and painted. Measurements made to notch in butt blaze, bearings are magnetic.
(8) 1" pipe w/ 4" aluminum cap
4" Spruce N47E 28.3'
9" Cedar S60E 54.8'
8" Cedar S39W 10.45'
7" Hemlock S83N 25.05'
All trees are blazed, scribed (1/16S, BT) and painted. Measurements are to notch in butt blaze. Bearings are magnetic.

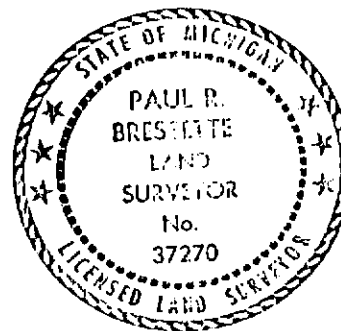

Signed by Paul R. Bressette Date 8-14-96
Surveyor's Michigan License No. 37270