

MAR 29 2000

SECTION

LAND CORNER RECORDATION CERTIFICATE  
Filing Requirement of Act 74, Mich. P.A. 1970

Approved by Menominee County  
Land Survey Remonumentation  
Peer Group Under Act 345 Of  
P.A. of 1990 On 12/23 1999  
McL Davis PLS  
Chairman

For corners in

<u>MENOMINEE</u> (County)	Located In:	Corner Code #
1. Public Land Survey	T <u>35</u> N R <u>27</u> W	<u>M-3</u>
	T <u>   </u> R <u>   </u>	<u>   </u>
	T <u>   </u> R <u>   </u>	<u>   </u>
	T <u>   </u> R <u>   </u>	<u>   </u>
2. Property Controlling in Section	S <u>   </u> T <u>   </u> R <u>   </u>	<u>   </u>
	S <u>   </u> T <u>   </u> R <u>   </u>	<u>   </u>
3. Miscellaneous Property in Sec.	S <u>   </u> T <u>   </u> R <u>   </u>	<u>   </u>
	S <u>   </u> T <u>   </u> R <u>   </u>	<u>   </u>

BK 6 Pg. 86

RECEIVED FOR RECORD  
28 DEC 1999 3:56:09 PM  
BARBARA MORRISON  
REGISTER OF DEEDS  
MENOMINEE, MI 49858

Register of Deeds Stamp & File Number

4. Lot No.    , Recorded Plat    

5. Private Claims    

SAME AS CORNER A-3, T35N-R26W

I, William Lenca, in a field survey on Oct. 1999 do hereby state that under requirements of P.A. 74, Michigan P.A. of 1970, the corner points mentioned in lines 1 and 2 above were in conformance with regulations and rules therefore as required in the current manual of survey instructions of the United States Department of the Interior, Bureau of Land Management or by a decree of a Court of Law and /or that the corner points mentioned in lines 3, 4 and 5 above were in conformance with the rules of the Michigan Board of Land Surveyors or by a Decree of a Court of Law; established, re-established, monumented, recovered, found as expressed below:

NOTE: Not more than 2 corners, all in the same town and range, may be recorded on this certificate.

A	B	C	D	E	F	G	H	I	J	K	L	M
1												
2	6	5	4	3	2	1						
3												
4	7	8	9	10	11	12						
5												
6	18	17	16	15	14	13						
7												
8	19	20	21	22	23	24						
9												
10	30	29	28	27	26	25						
11												
12	31	32	33	34	35	36						
13												

A. Description of original monument and accessories and/or subsequent restoration:

- 1847: Twp. Boundary by H. Floyd - B.T.'s - Beech, 6" - S46°W - 27 lks; Beech, 6" - N20°W - 9 lks
- 1848: Sectional Subdivision by James H. Mullett - B.T.'s - Beech, 6" - S87°E - 11 lks.; Beech, 6" - N25°E - 27 lks. All original evidence for this corner has been destroyed by years of decay.

B. Description of corner evidence found and/or method applied in restoring or reestablishing corner:

In a retracement of the East Line of Section 1, T35N-R27W, we found an ancient fence corner (fences run N-S-E-W) at a location of 2664.99 feet South of the E1/4 Corner of Section 1 and 2637.78 feet North of the E1/4 Corner of Section 12, T35N-R27W. We accepted this location as the best available evidence of the position of the original corner.

C. Description of monument for corner and accessories established to perpetuate locating the position of the corner:

Set 2" dia. Aluminum Pipe 30" long/3-1/4" dia. Alum cap stamped for corner location:

15" dia. Hemlock	S 55° E	10.61 feet	Scr. NBT
5" dia. Ironwood	S 56° W	51.99 feet	Scr. NBT
9" dia. H. Maple	N 54° W	61.77 feet	Scr. NBT
7" dia. Ironwood	N 04° E	64.70 feet	Scr. NBT
Metal Survey Sign Post	South	.50 feet	

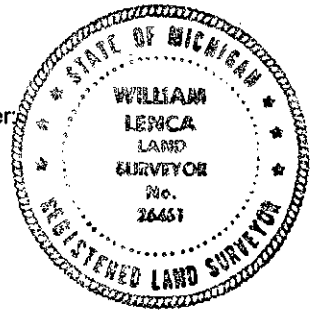

NOTE: All bearings are magnetic bearings. All distances are measured with steel tape. Distances to trees are to nail in side of tree.

Signed by William Lenca  
Surveyor's Michigan License No. 26461

Date Nov. 23, 1999