

MAR 29 2000

Approved by Menominee County  
Land Survey Remonumentation  
Peer Group Under Act 345 Of

P.A. Of 1999 On 10/11, 1999  
McL DAVIS BLS  
Chairman

SECTION

LAND CORNER RECORDATION CERTIFICATE  
Filing Requirement of Act 74, Mich. P.A. 1970

For corners in

MENOMINEE  
(County)

Located In:

Corner Code #

- |                                    |                             |            |
|------------------------------------|-----------------------------|------------|
| 1. Public Land Survey              | T <u>35</u> N R <u>27</u> W | <u>M-4</u> |
|                                    | T ___ R ___                 | _____      |
|                                    | T ___ R ___                 | _____      |
|                                    | T ___ R ___                 | _____      |
| 2. Property Controlling in Section | S ___ T ___ R ___           | _____      |
|                                    | S ___ T ___ R ___           | _____      |
| 3. Miscellaneous Property in Sec.  | S ___ T ___ R ___           | _____      |
|                                    | S ___ T ___ R ___           | _____      |

BK. 6 Pg. 118

RECEIVED FOR RECORD  
28 DEC 1999 3:58:09 PM  
BARBARA MORRISON  
REGISTER OF DEEDS  
MENOMINEE, MI 49858

Register of Deeds Stamp & File Number

4. Lot No. \_\_\_\_\_, Recorded Plat \_\_\_\_\_

5. Private Claims \_\_\_\_\_

SAME AS CORNER A-4, T35N-R26W

I, William Lenca, in a field survey on Nov., 1999 do hereby state that under requirements of P.A. 74, Michigan P.A. of 1970, the corner points mentioned in lines 1 and 2 above were in conformance with regulations and rules therefore as required in the current manual of survey instructions of the United States Department of the Interior, Bureau of Land Management or by a decree of a Court of Law and /or that the corner points mentioned in lines 3, 4 and 5 above were in conformance with the rules of the Michigan Board of Land Surveyors or by a Decree of a Court of Law; established, re-established, monumented, recovered, found as expressed below:

NOTE: Not more than 2 corners, all in the same town and range, may be recorded on this certificate.

	A	B	C	D	E	F	G	H	I	J	K	L	M
1													
2	6		5		4		3		2		1		
3													
4	7		8		9		10		11		12		
5													
6	18		17		16		15		14		13		
7													
8	19		20		21		22		23		24		
9													
10	30		29		28		27		26		25		
11													
12	31		32		33		34		35		36		
13													

A. Description of original monument and accessories and/or subsequent restoration:

1847: Twp. Boundary by H. Floyd - B.T.'s - Cedar, 6" - N80°W - 06 lks; Spruce, 6" - S88°E - 23 lks. All original evidence for this corner has been destroyed by county road improvements.

B. Description of corner evidence found and/or method applied in restoring or reestablishing corner:

Finding no evidence of the original corner accessories, or evidence of subsequent restoration, we accepted a corner position falling in line with the centerline of an East - West County Road and with ancient fences running North and South. This position fits well with measurements to corners 1 mile North (5302.84 feet) and 1/2 mile South (2639.31 feet), fits well with existing lines of occupation, and is accepted as the best available evidence of the position of the original corner.

C. Description of monument for corner and accessories established to perpetuate locating the position of the corner:

Set 5/8" x 24" Iron Rod/3-1/4" dia. Alum. cap stamped for corner location in Monument Box:

- |                        |         |            |          |
|------------------------|---------|------------|----------|
| 12" dia. Cedar         | N 32° E | 57.48 feet | Scr. NBT |
| 12" dia. Tamarack      | S 40° E | 52.69 feet | Scr. NBT |
| 11" dia. Tamarack      | S 33° W | 51.96 feet | Scr. NBT |
| 10" dia. Cedar         | N 32° W | 61.75 feet | Scr. NBT |
| Metal Survey Sign Post | N 03° W | 30.85 feet |          |

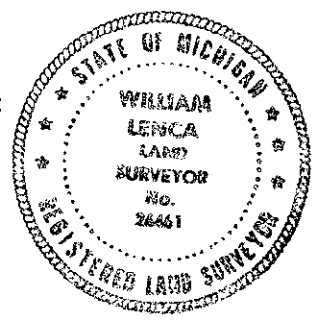

NOTE: All bearings are magnetic bearings. All distances are measured with steel tape. Distances to trees are to nail in side of tree.

Signed by William Lenca

Date Nov. 23, 1999

Surveyor's Michigan License No. 26461