

MAR 29 2000

Approved by Menominee County Land Survey Remonumentation Peer Group Under Act 345 Of P.A. Of 1990 On 12/28 1999 Mel Davis PLS Chairman

SECTION

LAND CORNER RECORDATION CERTIFICATE Filing Requirement of Act 74, Mich. P.A. 1970

For corners in

Table with columns: MENOMINEE (County), Located In:, Corner Code #. Rows include Public Land Survey, Property Controlling in Section, and Miscellaneous Property in Sec.

Bk. 6 Pg. 87

RECEIVED FOR RECORD 28 DEC 1999 3:56:09 PM BARBARA MORRISON REGISTER OF DEEDS MENOMINEE, MI 49858

Register of Deeds Stamp & File Number

4. Lot No. [Recorded Plat] 5. Private Claims SAME AS CORNER A-5, T35N-R26W

Grid table with columns A-M and rows 1-13. Contains numbers 1-36 in a grid pattern.

I, William Lenca, in a field survey on Nov. 1999 do hereby state that under requirements of P.A. 74, Michigan P.A. of 1970, the corner points mentioned in lines 1 and 2 above were in conformance with regulations and rules therefore as required in the current manual of survey instructions of the United States Department of the Interior, Bureau of Land Management or by a decree of a Court of Law and/or that the corner points mentioned in lines 3, 4 and 5 above were in conformance with the rules of the Michigan Board of Land Surveyors or by a Decree of a Court of Law, established, re-established, monumented, recovered, found as expressed below:

NOTE: Not more than 2 corners, all in the same town and range, may be recorded on this certificate.

A. Description of original monument and accessories and/or subsequent restoration:

1847: Twp. Boundary by H. Floyd - B.T.'s - Lynn, 10" - S68°W - 25 lks; Lynn, 36" - N47°W - 25 lks 1848: Sectional Subdivision by James H. Mullett - B.T.'s - Sugar, 8" - S46°E - 13 lks.; Sugar, 12" - N78°E - 38 lks. All original evidence for this corner has been destroyed by land clearing and farming activities.

B. Description of corner evidence found and/or method applied in restoring or reestablishing corner:

We set this corner at an ancient fence corner - fences run North - South and West from this position. This position fits well with the 1/16 fence line 1/4 mile South, is consistent with long standing lines of occupation and is accepted as the best available evidence of the position of the original corner.

C. Description of monument for corner and accessories established to perpetuate locating the position of the corner:

Set 3/4" dia. x 4' long aluminum rod/3-1/4" dia. Alum. cap stamped for corner.

Table listing monument details: 20" dia. Elm (North 38.05 feet, Scr. NBT), 6" dia. Maple (S 5° E 40.78 feet, Scr. NBT), 24" dia. Elm (West 1.75 feet, Scr. NBT), Nothing else nearby, Metal Survey Sign Post (East 3.50 feet).

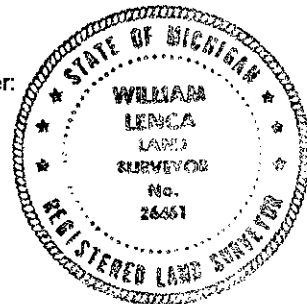

NOTE: All bearings are magnetic bearings. All distances are measured with steel tape. Distances to trees are to nail in side of tree.

Signed by William Lenca Surveyor's Michigan License No. 26461

Date Nov. 23, 1999