

APR 06 1999

Approved by Menominee County
Land Survey Remonumentation
Peer Group Under Act 345 Of

P.A. Of 1990 On 10/29 1998
Leanne J. Wynn P.S.
Chairman

SECTION

LAND CORNER RECORDATION CERTIFICATE
Filing Requirement of Act 74, Mich. P.A. 1970

For corners in

MENOMINEE

(County)

Located In:

Corner Code #

- | | | |
|------------------------------------|----------------------------|-------------|
| 1. Public Land Survey | T <u>35</u> NR <u>27</u> W | <u>M-09</u> |
| | T ___ R ___ | _____ |
| | T ___ R ___ | _____ |
| | T ___ R ___ | _____ |
| 2. Property Controlling in Section | S ___ T ___ R ___ | _____ |
| | S ___ T ___ R ___ | _____ |
| 3. Miscellaneous Property in Sec. | S ___ T ___ R ___ | _____ |
| | S ___ T ___ R ___ | _____ |

RECEIVED FOR RECORD
98 DEC 14 PM 3:20
PAGE # 657 BKS
BARBARA MORRISON
REGISTER OF DEEDS
MENOMINEE, MI 49858

Register of Deeds Stamp & File Number

4. Lot No. _____, Recorded Plat

5. Private Claims _____

(SAME AS CORNER A-09, T35N-R26W.)

	A	B	C	D	E	F	G	H	I	J	K	L	M
1													
2	6		5		4		3		2		1		
3													
4	7		8		9		10		11		12		
5													
6	18		17		16		15		14		13		
7													
8	19		20		21		22		23		24		
9													
10	30		29		28		27		26		25		
11													
12	31		32		33		34		35		36		
13													

I, William Lenca, in a field survey on Nov., 1998 do hereby state that under requirements of P.A. 74, Michigan P.A. of 1970, the corner points mentioned in lines 1 and 2 above were in conformance with regulations and rules therefore as required in the current manual of survey instructions of the United States Department of the Interior, Bureau of Land Management or by a decree of a Court of Law and /or that the corner points mentioned in lines 3, 4 and 5 above were in conformance with the rules of the Michigan Board of Land Surveyors or by a Decree of a Court of Law; established, re-established, monumented, recovered, found as expressed below:

NOTE: Not more than 2 corners, all in the same town and range, may be recorded on this certificate.

A. Description of original monument and accessories and/or subsequent restoration:

- 1847: Original Survey - Township Boundary - by H. Floyd - B.T.'s - B. Ash, 10" - S47°W - 44 lks.; Elm, 22" - N76°W - 75 lks.
- 1848: Original Survey - Sectional Subdivision - by James H. Mullett - B.T.'s - B. Ash, 12" - S23°E - 23 lks.; Cedar, 8" - N63°E - 08 lks. All original evidence for these corners have been destroyed by county road improvements.
- 1900: Albert Hass, Co. Surveyor; shows this corner in relation to other Cor.s in Sec. 24 - states set 4" Ced. Post in center of Rd.
- 1980: L.C.R.C. Number 261 by Gerald W. Carlson states, "FD. REMAINS OF SQ. CEDAR POST BELOW BLKTOP RD.; SET 5/8" x 24" IRON w/RLS CAP IN MONUMENT BOX, 2' NORTH OF CENTERLINE CO. RD. "G-12", ON CENTERLINE GRAVEL RD. N. & S." TIES: Power Pole - N30°W - 59.37'; Ash, 4" - N31°E - 63.54'; Ash, 16" - S49°E - 55.50'; Basswood, 3" - S26°W - 67.10'.

B. Description of corner evidence found and/or method applied in restoring or reestablishing corner:

We recovered a 5/8 inch diameter iron rod with plastic identification cap marked RLS 24589 inside of a square cast iron monument box 9 inches below the present asphalt road surface per L.C.R.C. No. 261. Based on Gerald Carlson's Land Corner Record, we accepted this position as a re-monumentation of Albert Hass' Cedar Post set in 1900. Since there is no record evidence that this post was established from Original Evidence, we accepted it as the best available evidence of the position of the original corner.

C. Description of monument for corner and accessories established to perpetuate locating the position of the corner:

Set 3-1/4" dia. Alum. cap stamped for corner location over existing 5/8" Iron Rod in Monument Box:

12" dia. White Ash	N47°E	92.40 feet	"X" cut in upper & lower blaze
12" dia. White Ash	S26°E	56.58 feet	"X" cut in upper & lower blaze
10" dia. White Ash	S22°W	85.25 feet	"X" cut in upper & lower blaze
12" dia. White Ash	N42°W	103.74 feet	"X" cut in upper & lower blaze
Metal Survey Sign Post	N35°E	46.5 feet	

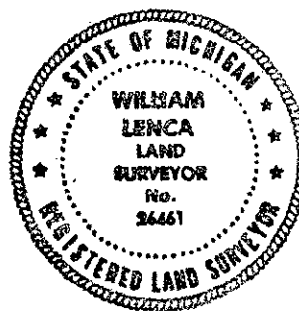

NOTE: All bearings are magnetic bearings. All distances are measured with steel tape. Distances to trees are to nail in side of tree.

Signed by William Lenca
Surveyor's Michigan License No. 26461

Date Dec. 12, 1997