

APR 06 1998

P.A. Of 1990 On 10/29, 1998
Terence J. Wain P.S.
Chairman

LAND CORNER RECORDATION CERTIFICATE
Filing Requirement of Act 74, Mich. P.A. 1970

For corners in SECTION

MENOMINEE

(County)

Located In:

Corner Code #

1. Public Land Survey	T <u>35</u> NR <u>27</u> W	<u>M-11</u>
	T ___ R ___	_____
	T ___ R ___	_____
	T ___ R ___	_____
2. Property Controlling in Section	S ___ T ___ R ___	_____
	S ___ T ___ R ___	_____
3. Miscellaneous Property in Sec.	S ___ T ___ R ___	_____
	S ___ T ___ R ___	_____

RECEIVED FOR RECORD
98 DEC 14 PM 3:20
PAGE # 658 BK 5
BARBARA MORRISON
REGISTER OF DEEDS
MENOMINEE, MI 49858

Register of Deeds Stamp & File Number.

4. Lot No. _____, Recorded Plat _____
5. Private Claims _____

(SAME AS CORNER A-11, T35N - R26W.)

I, William Lenca, in a field survey on June 09, 19 98 do hereby state that under requirements of P.A. 74, Michigan P.A. of 1970, the corner points mentioned in lines 1 and 2 above were in conformance with regulations and rules therefore as required in the current manual of survey instructions of the United States Department of the Interior, Bureau of Land Management or by a decree of a Court of Law and /or that the corner points mentioned in lines 3, 4 and 5 above were in conformance with the rules of the Michigan Board of Land Surveyors or by a Decree of a Court of Law; established, re-established, monumented, recovered, found as expressed below:

NOTE: Not more than 2 corners, all in the same town and range, may be recorded on this certificate.

A	B	C	D	E	F	G	H	I	J	K	L	M
1												
2	6		5		4		3		2		1	
3												
4	7		8		9		10		11		12	
5												
6	18		17		16		15		14		13	
7												
8	19		20		21		22		23		24	
9												
10	30		29		28		27		26		25	
11												
12	31		32		33		34		35		36	
13												

A. Description of original monument and accessories and/or subsequent restoration:

- 1847: Original Survey - Township Boundary - by H. Floyd - B.T.'s - Lynn, 20" - S67°W - 56 lks.; Lynn, 24" - N66°W - 31 lks.
- 1848: Original Survey - Sectional Subdivision - by James H. Mullett - B.T.'s - Beech, 10" - N41°E - 15 lks.; Beech, 12" - S62°E - 45 lks. All original evidence for these corners have been destroyed by county road improvements.
- 1994: Certified Survey Number 830 by William Lenca indicates he set a 5/8" x 24" Iron Rod / 3-1/4" Alum. cap at this corner.
TIES: Elm, 12" - S75°E - 119.60'; Maple, 7" - S58°W - 57.41'; Maple, 20" - N29°W - 50.07'; 5/8" x 24" Iron Rod @ Survey Sign Post - South - 33.00'.

B. Description of corner evidence found and/or method applied in restoring or reestablishing corner:

We found a 5/8" x 24" Iron Rod with a 3-1/4" aluminum cap and ties as indicated in Certified Survey Number 830 and described above. The corner falls 1' South of the centerline of an East - West county road and in line with the centerline of a county road to the North and an old fence South. This position has been used in other surveys, fits existing occupation, and is accepted as the best available evidence of the position of the original corner.

C. Description of monument for corner and accessories established to perpetuate locating the position of the corner:

Set Monument Box over existing 5/8" x 24" Iron Rod/3-1/4" dia. Alum. cap stamped for corner:

12" dia. Elm	S75°E	119.60 feet	Scr. NBT
7" dia. Maple	S58°W	57.41 feet	Scr. NBT
20" dia. Maple	N29°W	50.07 feet	Scr. NBT
5/8" x 24" Iron Rod/2" dia. Alum. cap marked "WITNESS MARKER"	South	33.00 feet	@ Sign Post
Metal Survey Sign Post	South	33.0 feet	

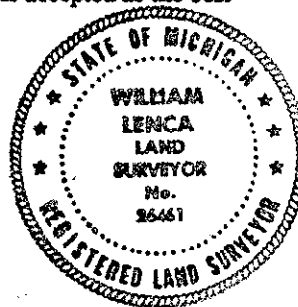

NOTE: All bearings are magnetic bearings. All distances are measured with steel tape. Distances to trees are to nail in side of tree.

Signed by William Lenca
Surveyor's Michigan License No. 26461

Date Oct. 21, 1998

658