

# SURVEY & REMONUMENTATION

JAN 09 2001

SECTION

LAND CORNER RECORDATION CERTIFICATE  
Filing Requirement of Act 74, Mich. P.A. 1970

Approved by Menominee County  
Land Survey Remonumentation  
Peer Group Under Act 345 of  
P.A. of 1990 On 7/13, 2000  
MEL PAUL RGS  
Chairman

Book 6 Page 133

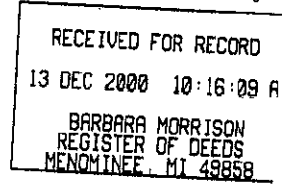

Register of Deeds Stamp & File Number

For corners in MENOMINEE (County)	Located In:	Corner Code #
1. Public Land Survey	T <u>35</u> N R <u>26</u> W	B-01
	T ___ R ___	_____
	T ___ R ___	_____
	T ___ R ___	_____
2. Property Controlling in Section	S ___ T ___ R ___	_____
	S ___ T ___ R ___	_____
3. Miscellaneous Property in Sec.	S ___ T ___ R ___	_____
	S ___ T ___ R ___	_____

4. Lot No. \_\_\_\_\_, Recorded Plat \_\_\_\_\_  
5. Private Claims \_\_\_\_\_  
SAME AS CORNER B-13 T36N-R26W

I, William Lenca, in a field survey on July 05, 1900 do hereby state that under requirements of P.A. 74, Michigan P.A. of 1970, the corner points mentioned in lines 1 and 2 above were in conformance with regulations and rules therefore as required in the current manual of survey instructions of the United States Department of the Interior, Bureau of Land Management or by a decree of a Court of Law and /or that the corner points mentioned in lines 3, 4 and 5 above were in conformance with the rules of the Michigan Board of Land Surveyors or by a Decree of a Court of Law, established, re-established, monumented, recovered, found as expressed below:

NOTE: Not more than 2 corners, all in the same town and range, may be recorded on this certificate.

	A	B	C	D	E	F	G	H	I	J	K	L	M
1		●											
2		6		5		4		3		2		1	
3													
4		7		8		9		10		11		12	
5													
6		18		17		16		15		14		13	
7													
8		19		20		21		22		23		24	
9													
10		30		29		28		27		26		25	
11													
12		31		32		33		34		35		36	
13													

A. Description of original monument and accessories and/or subsequent restoration:

- 1848: Original Survey by James H. Mullett - B.T.'s - Hemlock, 26" - S33°E - 17 lks.; Hemlock, 10" - N48°W - 41 lks. All original evidence for this corner has been destroyed by county road improvements.
- 1976: L.C.R.C. No. 152 by George B. Wilson, RLS No. 17607 - Set 3/4" x 18" Iron Pipe in c/l of C. R. No. 358 - Fits occupied fence line and woods line to the North & road R/W lines. B.T.'s - Power Pole - N04°W - 36.35'; Power Pole - S25°E - 52.53'; 24" Elm - N55°E - 62.05' (gone).

B. Description of corner evidence found and/or method applied in restoring or reestablishing corner:

We found a 3/4 inch x 18 inch iron pipe in the centerline of County Road No. 358 (East - West) and in line with an old fence line running North. This corner has been accepted and used by local surveyors for more than 20 years, and is accepted as the best available evidence of the position of the original corner.

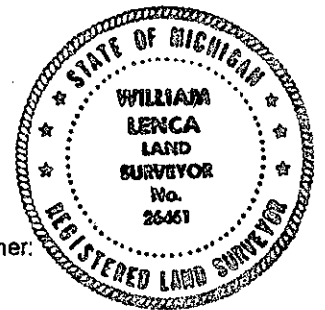

C. Description of monument for corner and accessories established to perpetuate locating the position of the corner:

Set 5/8" x 24" Iron Rod/3-1/4" dia. Alum. cap stamped for corner location in Monument Box:

5/8" x 24" Iron Rod/2" dia. Alum. cap marked "WITNESS MARKER"	North	28.54 feet	
5/8" x 24" Iron Rod/2" dia. Alum. cap marked "WITNESS MARKER"	S32°E	39.73 feet	1.0' E. of Tel. Box
5/8" x 24" Iron Rod/2" dia. Alum. cap marked "WITNESS MARKER"	S53°W	48.95 feet	
Metal Survey Sign Post	North	33.75 feet	

NOTE: All bearings are magnetic bearings. All distances are measured with steel tape. Distances to trees are to nail in side of tree.

Signed by William Lenca  
Surveyor's Michigan License No. 26461  
26461

Date July 13, 2000