

**SURVEY &  
REMONUMENTATION**

**JAN 09 2001**

**SECTION**

**LAND CORNER RECORDATION CERTIFICATE**  
Filing Requirement of Act 74, Mich. P.A. 1970

Approved by Menominee County  
Land Survey Remonumentation  
Peer Group Under Act 345 of  
P.A. Of 1990 On 12/22, 2000  
Mike Davis RLS  
Chairman

For corners in  
MENOMINEE

Located in: Corner Code #

(County)	Located in:	Corner Code #
1. Public Land Survey	T <u>35N</u> R <u>26W</u>	B-3
	T <u>    </u> R <u>    </u>	<u>    </u>
	T <u>    </u> R <u>    </u>	<u>    </u>
	T <u>    </u> R <u>    </u>	<u>    </u>
2. Property Controlling in Section	S <u>    </u> T <u>    </u> R <u>    </u>	<u>    </u>
	S <u>    </u> T <u>    </u> R <u>    </u>	<u>    </u>
3. Miscellaneous Property in Sec.	S <u>    </u> T <u>    </u> R <u>    </u>	<u>    </u>
	S <u>    </u> T <u>    </u> R <u>    </u>	<u>    </u>

*Blk. 6 Pg. 225*

RECEIVED FOR RECORD  
28 DEC 2000 2:31:31 PM  
BARBARA MORRISON  
REGISTER OF DEEDS  
MENOMINEE, MI 49858

Register of Deeds Stamp & File Number

4. Lot No. \_\_\_\_\_, Recorded Plat \_\_\_\_\_  
5. Private Claims \_\_\_\_\_

I, William Lenca, in a field survey on      Oct.     , 19     00 do hereby state that under requirements of P.A. 74, Michigan P.A. of 1970, the corner points mentioned in lines 1 and 2 above were in conformance with regulations and rules therefore as required in the current manual of survey instructions of the United States Department of the Interior, Bureau of Land Management or by a decree of a Court of Law and /or that the corner points mentioned in lines 3, 4 and 5 above were in conformance with the rules of the Michigan Board of Land Surveyors or by a Decree of a Court of Law; established, re-established, monumented, recovered, found as expressed below:

NOTE: Not more than 2 corners, all in the same town and range, may be recorded on this certificate.

	A	B	C	D	E	F	G	H	I	J	K	L	M
1													
2		6		5		4		3		2		1	
3		●											
4		7		8		9		10		11		12	
5													
6		18		17		16		15		14		13	
7													
8		19		20		21		22		23		24	
9													
10		30		29		28		27		26		25	
11													
12		31		32		33		34		35		36	
13													

A. Description of original monument and accessories and/or subsequent restoration:

1848: Original Survey by James H. Mullett - B.T.'s - Sugar, 12" - N55°E - 16 lks.; Birch, 8" - N67°W - 16 lks. All original evidence for this corner has been destroyed by farming activities.

B. Description of corner evidence found and/or method applied in restoring or reestablishing corner:

We computed the Single Proportioned Position for this corner, traversed in to it and searched the area. We found an old fence running North - South, but no intersecting fence. We placed the corner on the old fence line and on a straight line between Section Corners 1/2 mile East and 1/2 mile West. This position falls about 4 feet West of the single proportional location, and is accepted as the best available evidence of the position of the original corner.

C. Description of monument for corner and accessories established to perpetuate locating the position of the corner:

Set 3/4" dia. x 4' long aluminum rod/3-1/4" dia. Alum. cap stamped for corner.

5" dia. Ironwood	N72°E	12.69 feet	Scr. NBT
7" dia. Maple	S15°E	84.43 feet	Scr. NBT
9" dia. Maple	N67°W	27.63 feet	Scr. NBT
10" dia. Maple	N03°W	11.68 feet	Scr. NBT
Metal Survey Sign Post	South	1.1 feet	

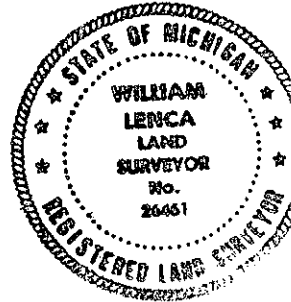

NOTE: All bearings are magnetic bearings. All distances are measured with steel tape. Distances to trees are to nail in side of tree.

Signed by William Lenca  
Surveyor's Michigan License No. 26461

Date Nov. 17, 2000