

LAND CORNER RECORDATION CERTIFICATE  
 Filing Requirement of Act 74, Mich. P.A. 1970

For corners in  
MENOMINEE  
 (County)

Located In: Corner Code #

1. Public Land Survey T35N R 26W B-07  
 T R  
 T R  
 T R

2. Property Controlling in Section S T R  
 S T R

3. Miscellaneous Property in Sec. S T R  
 S T R

4. Lot No. \_\_\_\_\_, Recorded Plat \_\_\_\_\_

5. Private Claims \_\_\_\_\_

RECEIVED FOR RECORD  
 97 JUL 23 PM 3:34  
 PAGE # 489, BK 5  
 BARBARA MORRISON  
 REGISTER OF DEEDS  
 MENOMINEE, WISCONSIN

Register of Deeds Stamp & File Number

1	A	B	C	D	E	F	G	H	I	J	K	L	M
2	6	5	4	3	2	1							
3													
4	7	8	9	10	11	12							
5													
6	10	17	16	15	14	13							
7	19	20	21	22	23	24							
8													
9													
10	30	29	28	27	26	25							
11													
12	31	32	33	34	35	36							
13													

I, William Lenca, in a field survey on May 20, 19 97 do hereby state that under requirements of P.A. 74, Michigan P.A. of 1970, the corner points mentioned in lines 1 and 2 above were in conformance with regulations and rules therefore as required in the current manual of survey instructions of the United States Department of the Interior, Bureau of Land Management or by a decree of a Court of Law and /or that the corner points mentioned in lines 3, 4 and 5 above were in conformance with the rules of the Michigan Board of Land Surveyors or by a Decree of a Court of Law; established, re-established, monumented, recovered, found as expressed below.

NOTE: Not more than 2 corners, all in the same town and range, may be recorded on this certificate.

A. Description of original monument and accessories and/or subsequent restoration:

- 1848: Original Survey by James H. Mullett - B.T.'s - Spruce, 4" - N70°E - 12 lks.; Tamarack, 6" - S35°E - 12 lks. Stump remains of 6" Tamarack - S35°E - 12 links, found in 1980, still visible.
- 1980: L.C.R.C. No. 262 by Gerald Carlson, RLS No. 24589, states: Fd 4" Sq. Cedar Post, broken - point in good condition; Fd. Stump for O.B.T. 6" Tam. - S35°E - 12L - Fences S. & W. in cedar swamp - set 5/8" x 24" Iron w/RLS cap. - B.T.'s: W. Birch - S60°E - 28.57'; 10" Cedar - S12°W - 18.47'; 9" Cedar - S50°W - 12.70'; 4" Cedar - N64°W - 7.95'.

B. Description of corner evidence found and/or method applied in restoring or reestablishing corner:

We recovered a 5/8" x 24" Iron Rod with RLS cap at an ancient fence corner - fences run South and West. We also recovered the following B.T.'s set forth in L.C.R.C. No. 262: W. Birch - S60°E - 28.57'; 10" Cedar - S12°W - 18.47'; 9" Cedar - S50°W - 12.70'. We also found the remains of an old tamarack stump matching the GLO call of - 6" Tam. - S35°E - 12 links. This Original B.T. is mentioned in L.C.R.C. No. 262 (See part A) and was used to re-establish the corner position. Since this corner was re-set from an original B.T., we accepted the corner position as a careful and faithful perpetuation of the position of the original corner.

C. Description of monument for corner and accessories established to perpetuate locating the position of the corner:

Set 3/4" x 4" long aluminum rod/3-1/4" dia. Alum. cap stamped for corner:

12" dia. Tamarack	N24°E	55.88 feet	Scr. NBT
12" dia. Cedar	S63°E	33.19 feet	Scr. NBT
10" dia. Cedar (Existing B.T.)	S12°W	18.47 feet	Scr. NBT
10" dia. Cedar (Existing B.T.)	S50°W	12.70 feet	Scr. NBT
Metal Survey Sign Post	North	1.0 feet	

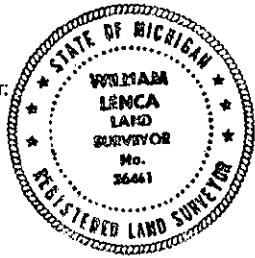

NOTE: All bearings are magnetic bearings. All distances are measured with steel tape. Distances to trees are to nail in side of tree.

Signed by William Lenca Date June 06, 1997  
 Surveyor's Michigan License No. 26461

STATE OF  
 REMONUMENTATION

489  
 DEC 22 1997  
 COMMISSION