

LAND CORNER RECORDATION CERTIFICATE
Filing Requirement of Act 74, Mich. P.A. 1970

Approved by Menominee County
 Land Survey Reestablishment
 Plan Group Under Act 345 Of

P.A. of 1970 On DEC 16, 1994
Mr. Davis RLS

For corners in

MENOMINEE
 (County)

Located In:

Corner Code #

- | | | |
|------------------------------------|-----------------------------|-------------|
| 1. Public Land Survey | T <u>35</u> N R <u>26</u> W | <u>C-10</u> |
| | T _____ R _____ | _____ |
| | T _____ R _____ | _____ |
| | T _____ R _____ | _____ |
| 2. Property Controlling in Section | S _____ T _____ R _____ | _____ |
| | S _____ T _____ R _____ | _____ |
| 3. Miscellaneous Property in Sec. | S _____ T _____ R _____ | _____ |
| | S _____ T _____ R _____ | _____ |

RECEIVED FOR RECORD
 DEC 27 AM 10:4
 ACTING CHAIRMAN
 BARBARA MORRISON
 REGISTER OF DEEDS
 REGISTERED PROFESSIONAL LAND SURVEYOR
 No. 178 BK. 4

Register of Deeds Stamp & File Number

4. Lot No. _____, Recorded Plat _____
 5. Private Claims _____

Same as C-10 T35N R26W

William Lenca

Apr. 5

94

I, _____, in a field survey on _____, 19____, do hereby certify that under requirements of P.A. 74, Michigan P.A. of 1970, the corner points mentioned in lines 1 and 2 above were in conformance with regulations and rules therefore as required in the current manual of survey instructions of the United States Department of the Interior, Bureau of Land Management or by a decree of a Court of Law and/or that the corner points mentioned in lines 3, 4 and 5 above were in conformance with the rules of the Michigan Board of Land Surveyors or by a Decree of a Court of Law; established, re-established, monumented, re-monumented, recovered, found as expressed below:

NOTE: Not more than 4 corners, all in the same town and range, may be recorded on this certificate.

A. Description of original monument and accessories and/or subsequent restoration:

ORIGINAL B.T.'s: Sugar, 10", N69°W, 18 lks
 Sugar, 12", S57°E, 20 lks

Original Survey by James H. Mullett in 1848. All original evidence for this corner has been destroyed by clearing and farming activities.

B. Description of corner evidence found and/or method applied in restoring or reestablishing corner:

Set corner on line with old fence lines running East - West and North - South from this location. This position fits for midpoint on line based on the intersection of County Road centerlines at the Southeast Corner. This location also fits well with a GLO Terrain North to a swamp edge, and is accepted as the best available evidence of the position of the original corner.

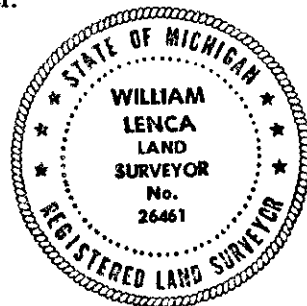

C. Description of monument for corner and accessories established to perpetuate locating the position of the corner:

Set 5/8" diameter Aluminum Rod 3 feet long/3-1/4" diameter Aluminum cap - stamped for corner:

15" dia. White Ash	Scr NBT	S78°E	35.49 feet
12" dia. White Ash	Scr NBT	S14°W	23.82 feet
8" dia. Cedar	Scr NBT	N83°W	43.62 feet
9" dia. Maple	Scr NBT	N19°W	48.07 feet
Carsonite Marker		N60°E	3.9 feet

NOTE: All bearings are magnetic bearings. All distances are measured with steel tape. Distances to trees are to nail in side of tree.

Signed by William Lenca

Date April 27, 1994

Surveyor's Michigan License No. 26461