

APR 06 1999

SECTION

LAND CORNER RECORDATION CERTIFICATE
Filing Requirement of Act 74, Mich. P.A. 1970

Approved by Menominee County
Land Survey Remonumentation
Peer Group Under Act 345 Of
P.A. Of 1990 On 12/14 1998
McDonnell RLS
Chairman

For corners in

MENOMINEE

(County)

Located in:

Corner Code #

1. Public Land Survey	T <u>35</u> N R <u>26</u> W	<u>D-13</u>
	T <u> </u> R <u> </u>	<u> </u>
	T <u> </u> R <u> </u>	<u> </u>
	T <u> </u> R <u> </u>	<u> </u>
2. Property Controlling in Section	S <u> </u> T <u> </u> R <u> </u>	<u> </u>
	S <u> </u> T <u> </u> R <u> </u>	<u> </u>
3. Miscellaneous Property in Sec.	S <u> </u> T <u> </u> R <u> </u>	<u> </u>
	S <u> </u> T <u> </u> R <u> </u>	<u> </u>

RECEIVED FOR RECORD
99 JAN 27 PM 1:33
PAGE # 750 BKS-
BARBARA MORRISON
REGISTER OF DEEDS
MENOMINEE, MI 49859

Register of Deeds Stamp & File Number

4. Lot No. , Recorded Plat
5. Private Claims
(SAME AS CORNER D-01, T34N - R26W)

I, William Lenca, in a field survey on June 30, 1998 do hereby state that under requirements of P.A. 74, Michigan P.A. of 1970, the corner points mentioned in lines 1 and 2 above were in conformance with regulations and rules therefore as required in the current manual of survey instructions of the United States Department of the Interior, Bureau of Land Management or by a decree of a Court of Law and for that the corner points mentioned in lines 3, 4 and 5 above were in conformance with the rules of the Michigan Board of Land Surveyors or by a Decree of a Court of Law; established, re-established, monumented, recovered, found as expressed below:

NOTE: Not more than 2 corners, all in the same town and range, may be recorded on this certificate.

A	B	C	D	E	F	G	H	I	J	K	L	M
1												
2	6		5		4		3		2		1	
3												
4	7		8		9		10		11		12	
5												
6	18		17		16		15		14		13	
7												
8	19		20		21		22		23		24	
9												
10	30		29		28		27		26		25	
11												
12	31		32		33		34		35		36	
13												

A. Description of original monument and accessories and/or subsequent restoration:

- 1847: Original Survey by Henry Floyd - B.T.'s - Sugar, 18" - N25°E - 28 lks.; Sugar, 26" - N40°W - 10 lks. All original evidence for this corner has been destroyed by county road improvements.
- 1989: L.C.R.C. Number 891 by William Lenca states, "Set corner in line with centerline of County Roads E-W and N." Set Railroad Spike. TIES: S.W. Corner of Stone Barn - N38°E - 50.30'; Power Pole - S69°E - 74.84'; Power Pole - S69°W - 45.43'; Power Pole - N27°W - 61.66'.
- 1989: Plat of Survey by William Lenca shows this corner in relation to other corners in Section 32, T35N - R26W.

B. Description of corner evidence found and/or method applied in restoring or reestablishing corner:

We found a Railroad Spike in a location as described in Land Corner Recordation Certificate Number 891 by William Lenca. This location has been used for many years and is accepted as the best available evidence of the position of the original corner.

C. Description of monument for corner and accessories established to perpetuate locating the position of the corner:

Set 5/8" x 24" Iron Rod/3-1/4" dia. Alum. cap stamped for corner location in Monument Box:

5/8" x 24" Iron Rod/2" dia. Alum. cap marked "WITNESS MARKER"	N40°E	49.79 feet	0.5' S.W. of S.W. Cor. Barn
5/8" x 24" Iron Rod/2" dia. Alum. cap marked "WITNESS MARKER"	S69°E	73.26 feet	1' W. of P.P.
5/8" x 24" Iron Rod/2" dia. Alum. cap marked "WITNESS MARKER"	S64°W	44.25 feet	1' E. of P.P.
5/8" x 24" Iron Rod/2" dia. Alum. cap marked "WITNESS MARKER"	N28°W	60.60 feet	1' S. of P.P.
Metal Survey Sign Post	N36°W	61.9 feet	

NOTE: All bearings are magnetic bearings. All distances are measured with steel tape. Distances to trees are to nail in side of tree.

Signed by William Lenca
Surveyor's Michigan License No. 26461

Date Aug. 24, 1998

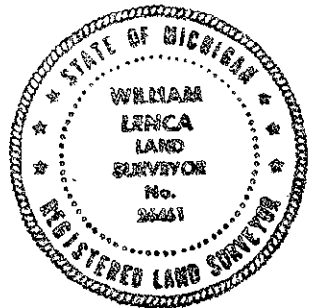

750