

**SURVEY & REMONUMENTATION**

JAN 09 2001

SECTION

**LAND CORNER RECORDATION CERTIFICATE**  
Filing Requirement of Act 74, Mich. P.A. 1970

Approved by Menominee County  
Land Survey Remonumentation  
Peer Group Under Act 345 of  
P.A. Of 1990 On 7/13, 2000  
M. Sawi RLS  
Chairman

For corners in  
MENOMINEE  
(County)

Located In: Corner Code #

1. Public Land Survey	T <u>35</u> N R <u>26</u> W	E-5
	T _____ R _____	_____
	T _____ R _____	_____
2. Property Controlling in Section	S _____ T _____ R _____	_____
3. Miscellaneous Property in Sec.	S _____ T _____ R _____	_____
	S _____ T _____ R _____	_____

Book 6 Page 151

RECEIVED FOR RECORD  
13 DEC 2000 10:16:09 A  
BARBARA MORRISON  
REGISTER OF DEEDS  
MENOMINEE, MI 49859

Register of Deeds Stamp & File Number

4. Lot No. \_\_\_\_\_, Recorded Plat \_\_\_\_\_  
5. Private Claims \_\_\_\_\_

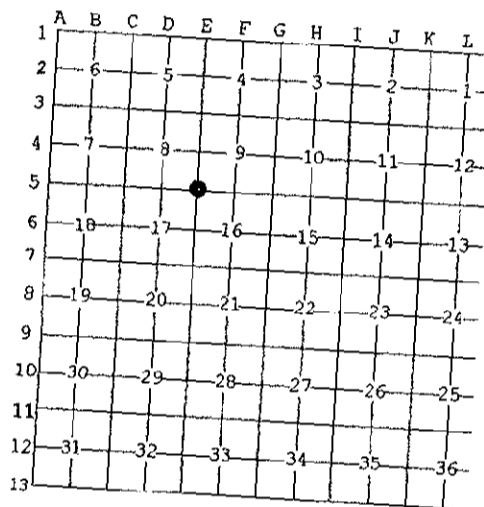

I, William Lenca, in a field survey on Sep., 1900 do hereby state that under requirements of P.A. 74, Michigan P.A. of 1970, the corner points mentioned in lines 1 and 2 above were in conformance with regulations and rules therefore as required in the current manual of survey instructions of the United States Department of the Interior, Bureau of Land Management or by a decree of a Court of Law and/or that the corner points mentioned in lines 3, 4 and 5 above were in conformance with the rules of the Michigan Board of Land Surveyors or by a Decree of a Court of Law; established, re-established, monumented, recovered, found as expressed below:

NOTE: Not more than 2 corners, all in the same town and range, may be recorded on this certificate.

A. Description of original monument and accessories and/or subsequent restoration:

1848: Original Survey by James H. Mullett - B.T.'s - Cedar, 9" - S60°E - 09 lks.; Cedar, 7" - N68°W - 05 lks.; All original evidence for this corner has been destroyed by County Road improvements.

B. Description of corner evidence found and/or method applied in restoring or reestablishing corner:

Set corner in line with centerline of County Roads East - West - South and in line with an old fence line running North. This position fits well with long standing lines of occupation to the East and with measurements to corners 1/2 mile East and 1/2 mile West, and is accepted as the best available evidence of the position of the original corner.

C. Description of monument for corner and accessories established to perpetuate locating the position of the corner:

Set 5/8" x 24" Iron Rod/3-1/4" dia. Alum. cap stamped for corner location in Monument Box:

6" dia. Tamarack	N53°E	71.86 feet	Scr. NBT
6" dia. Tamarack	S29°E	89.08 feet	Scr. NBT
5/8" x 24" Iron Rod/2" dia. Alum. cap marked "WITNESS MARKER"	S38°W	48.94 feet	1.0' East of Power Pole
6" dia. White Ash	N34°W	39.79 feet	Scr. NBT
Metal Survey Sign Post	North	21.0 feet	

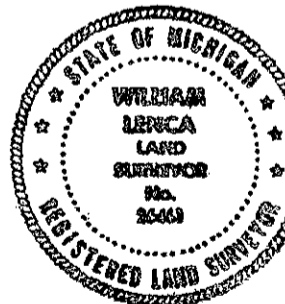

NOTE: All bearings are magnetic bearings. All distances are measured with steel tape. Distances to trees are to nail in side of tree.

Signed by William Lenca  
Surveyor's Michigan License No. 26461

Date Oct. 13, 2000