

APR 06 1999

Approved by Menominee County
Land Survey Reauthorization
Peer Group Under Act 345 Of

P.A. Of 1999 On 12/14 1998
Mr. Davis RLS
Chairman

SECTION

LAND CORNER RECORDATION CERTIFICATE
Filing Requirement of Act 74, Mich. P.A. 1970

For corners in

<u>MENOMINEE</u> (County)	Located In:	Corner Code #
1. Public Land Survey	<u>T35N R 26W</u>	<u>E-11</u>
	T ___ R ___	___
	T ___ R ___	___
	T ___ R ___	___
2. Property Controlling in Section	S ___ T ___ R ___	___
	S ___ T ___ R ___	___
3. Miscellaneous Property in Sec.	S ___ T ___ R ___	___
	S ___ T ___ R ___	___

RECEIVED FOR RECORD
99 JAN 27 PM 1:33
PAGE # 751 BKS-
BARBARA MORRISON
REGISTER OF DEEDS
MENOMINEE, MI 49858
Register of Deeds Stamp & File Number

4. Lot No. _____, Recorded Plat _____
5. Private Claims _____

I, William Lenca, in a field survey on July 01, 1998 do hereby state that under requirements of P.A. 74, Michigan P.A. of 1970, the corner points mentioned in lines 1 and 2 above were in conformance with regulations and rules therefore as required in the current manual of survey instructions of the United States Department of the Interior, Bureau of Land Management or by a decree of a Court of Law and /or that the corner points mentioned in lines 3, 4 and 5 above were in conformance with the rules of the Michigan Board of Land Surveyors or by a Decree of a Court of Law; established, re-established, monumented, recovered, found as expressed below:

NOTE: Not more than 2 corners, all in the same town and range, may be recorded on this certificate.

A	B	C	D	E	F	G	H	I	J	K	L	M
1												
2	6		5		4		3		2		1	
3												
4	7		8		9		10		11		12	
5												
6	18		17		16		15		14		13	
7												
8	19		20		21		22		23		24	
9												
10	30		29		28		27		26		25	
11												
12	31		32		33		34		35		36	
13												

A. Description of original monument and accessories and/or subsequent restoration:

1848: Original Survey by James H. Mullett - B.T.'s - Beech, 6" - N76°E - 27 lks.; Beech, 8" - S06°W - 27 lks. All original evidence for this corner has been destroyed by county road improvements.

B. Description of corner evidence found and/or method applied in restoring or reestablishing corner:

We found a 1/2 inch iron 10 inches long in the centerline of an East - West County Road and in line with an old fence North. The distance from this corner to the 1/4 corner between Sections 29 and 32 is 2516 feet, and the distance to the 1/4 corner between Sections 28 and 33 is 2534 feet. The distance from this corner to a small stream is 618 feet West compared to the GLO record distance of 640 feet. Based on these measurements and measurements to other long standing lines of occupation in the area, we accepted the position of the existing 1/2 inch diameter iron as the best available evidence of the position of the original corner. (SEE BACK FOR SKETCH)

C. Description of monument for corner and accessories established to perpetuate locating the position of the corner:

Set 2" dia. Aluminum Pipe 30" long/3-1/4" dia. Alum cap stamped for corner location:

14" dia. White Ash	North	56.70 feet	Scr. NBT
16" dia. White Ash	N67°E	67.28 feet	Scr. NBT
5/8" x 24" Iron Rod/2" dia. Alum. cap marked "WITNESS MARKER"	South	31.58 feet	@ sign post
8" dia. Cedar	S52°W	69.51 feet	Scr. NBT
Metal Survey Sign Post	South	32.1 feet	

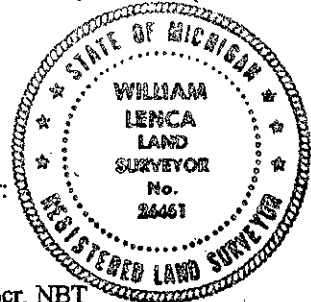

NOTE: All bearings are magnetic bearings. All distances are measured with steel tape. Distances to trees are to nail in side of tree.

Signed by William Lenca
Surveyor's Michigan License No. 26461

Date Aug. 25, 1998

