

**SURVEY &
REMONUMENTATION**

JAN 09 2001

SECTION

**LAND CORNER RECORDATION CERTIFICATE
Filing Requirement of Act 74, Mich. P.A. 1970**

Approved by Menominee County
Land Survey Remonumentation
Peer Group Under Act 345 of
P.A. Of 1990 On 12/22, 2000
Mark Davis DLS
Chairman

For corners in
MENOMINEE

(County)

Located In:

Corner Code #

1. Public Land Survey	T <u>35N</u> R <u>26W</u>	F-3
	T ___ R ___	_____
	T ___ R ___	_____
	T ___ R ___	_____
2. Property Controlling in Section	S ___ T ___ R ___	_____
	S ___ T ___ R ___	_____
3. Miscellaneous Property in Sec.	S ___ T ___ R ___	_____
	S ___ T ___ R ___	_____

Bk 6 Pg. 229

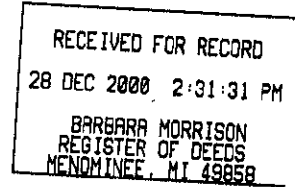

Register of Deeds Stamp & File Number

4. Lot No. _____, Recorded Plat _____
5. Private Claims _____

I, William Lenca, in a field survey on Oct., 1900 do hereby state that under requirements of P.A. 74, Michigan P.A. of 1970, the corner points mentioned in lines 1 and 2 above were in conformance with regulations and rules therefore as required in the current manual of survey instructions of the United States Department of the Interior, Bureau of Land Management or by a decree of a Court of Law and/or that the corner points mentioned in lines 3, 4 and 5 above were in conformance with the rules of the Michigan Board of Land Surveyors or by a Decree of a Court of Law; established, re-established, monumented, recovered, found as expressed below:

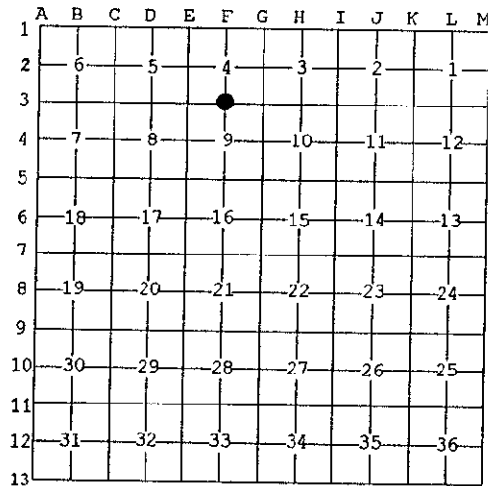

NOTE: Not more than 2 corners, all in the same town and range, may be recorded on this certificate.

A. Description of original monument and accessories and/or subsequent restoration:

- 1848: Original Survey by James H. Mullett - B.T.'s - Tamarack, 4" - S70°E - 33 lks.; Tamarack, 6" - N45°E - 39 lks.; All original evidence for this corner has been destroyed by years of decay.
- 1901: Survey by Albert Hass shows this corner and describes it as "Set 4" Cedar Post from Government B.T."

B. Description of corner evidence found and/or method applied in restoring or reestablishing corner:

We were unable to find any evidence for the original corner or for Albert Hass' Corner. We set the Corner in line with an old established fence line running East and midway between the Section Corners 1/2 mile East and West. This position fits well with a GLO stream call 11.6 feet West and falls at the end of the old fence, and is accepted as the best available evidence of the position of the original corner.

C. Description of monument for corner and accessories established to perpetuate locating the position of the corner:

Set 2" dia. Aluminum Pipe 30" long/3-1/4" dia. Alum cap stamped for corner location:

7" dia. Tamarack	N03°W	11.25 feet	Scr. NBT
9" dia. Cedar	S88°E	77.13 feet	Scr. NBT
8" dia. Cedar	S02°W	19.12 feet	Scr. NBT
12" dia. Tamarack	N70°W	24.71 feet	Scr. NBT
Metal Survey Sign Post	West	1.0 feet	

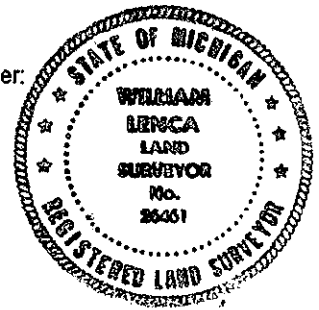

NOTE: All bearings are magnetic bearings. All distances are measured with steel tape. Distances to trees are to nail in side of tree.

Signed by William Lenca
Surveyor's Michigan License No. 26461

Date Nov. 09, 2000