

**SURVEY & REMONUMENTATION**

JAN 09 2001

SECTION

**LAND CORNER RECORDATION CERTIFICATE**  
Filing Requirement of Act 74, Mich. P.A. 1970

Approved by Menominee County  
Land Survey Remonumentation  
Peer Group Under Act 345 of  
P.A. Of 1990 On 7/13, 2000  
WILLIAM DAVIS RLS  
Chairman

Book 6 Page 161

| For corners in<br>MENOMINEE<br>(County) | Located In:       | Corner Code # |
|---|-------------------|---------------|
| 1. Public Land Survey                   | T35N R 26W        | G-1           |
|   | T ___ R ___       | _____         |
|   | T ___ R ___       | _____         |
|   | T ___ R ___       | _____         |
| 2. Property Controlling<br>in Section   | S ___ T ___ R ___ | _____         |
|   | S ___ T ___ R ___ | _____         |
| 3. Miscellaneous<br>Property in Sec.    | S ___ T ___ R ___ | _____         |
|   | S ___ T ___ R ___ | _____         |

RECEIVED FOR RECORD  
13 DEC 2000 10:16:09 A  
BARBARA MORRISON  
REGISTER OF DEEDS  
MENOMINEE, MI 49858

Register of Deeds Stamp & File Number

4. Lot No. \_\_\_\_\_, Recorded Plat \_\_\_\_\_  
5. Private Claims \_\_\_\_\_  
SAME AS CORNER G-13, T36N-R26W

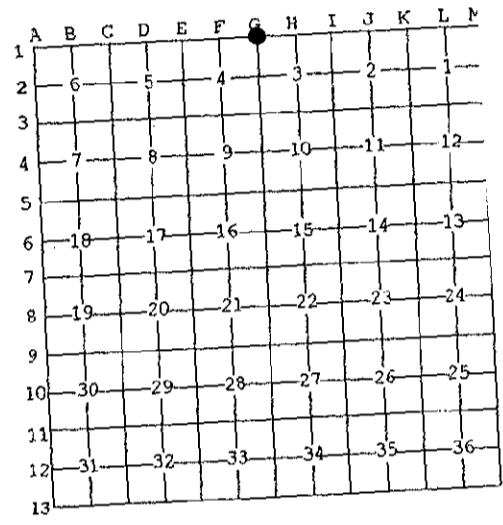

I, William Lenca, in a field survey on Jul., 1900 do hereby state that under requirements of P.A. 74, Michigan P.A. of 1970, the corner points mentioned in lines 1 and 2 above were in conformance with regulations and rules therefore as required in the current manual of survey instructions of the United States Department of the Interior, Bureau of Land Management or by a decree of a Court of Law and /or that the corner points mentioned in lines 3, 4 and 5 above were in conformance with the rules of the Michigan Board of Land Surveyors or by a Decree of a Court of Law, established, re-established, monumented, recovered, found as expressed below:

NOTE: Not more than 2 corners, all in the same town and range, may be recorded on this certificate.

A. Description of original monument and accessories and/or subsequent restoration:  
1848: Original Survey by James H. Mullett - B.T.'s - Cedar 12", - N49°E - 14 lks.; Cedar 12" - N64°W - 14 lks.; Cedar 12" - S65°E - 17 lks.; Tamarack 10" - S5°W - 20 lks. All original evidence for this corner has been destroyed by County Road improvements.

B. Description of corner evidence found and/or method applied in restoring or reestablishing corner:  
Found a Railroad Spike in the centerline of a county road intersection - county roads run East - West and North. This corner has been accepted and used by local surveyors for several years, and is accepted as the best available evidence of the position of the original corner.

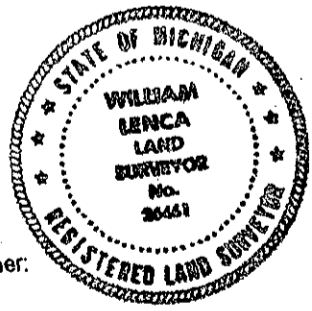

C. Description of monument for corner and accessories established to perpetuate locating the position of the corner:  
Set 5/8" x 24" Iron Rod/3-1/4" dia. Alum. cap stamped for corner location in Monument Box:

|                        |       |            |          |
|------------------------|-------|------------|----------|
| 12" White Pine         | N44°E | 102.4 feet | Scr. NBT |
| 8" Tamarack            | S53°E | 71.49 feet | Scr. NBT |
| 9" Tamarack            | S44°W | 80.05 feet | Scr. NBT |
| 6" Cedar               | N41°W | 65.54 feet | Scr. NBT |
| Metal Survey Sign Post | South | 27.9 feet  |          |

NOTE: All bearings are magnetic bearings. All distances are measured with steel tape. Distances to trees are to nail in side of tree.

Signed by William Lenca  
Surveyor's Michigan License No. 26461

Date Aug. 8, 2000