

SURVEY & REMONUMENTATION

JAN 09 2001

SECTION

LAND CORNER RECORDATION CERTIFICATE
Filing Requirement of Act 74, Mich. P.A. 1970

Approved by Menominee County
Land Survey Remonumentation
Peer Group Under Act 345 of
P.A. Of 1990 On 7/13, 2000
Michelle Davis RLS
Chairman

Book 6 Page 162

For corners in
MENOMINEE
(County)

Located In: Corner Code #

1. Public Land Survey	T <u>35</u> N R <u>26</u> W	G-3
	T ___ R ___	_____
	T ___ R ___	_____
	T ___ R ___	_____
2. Property Controlling in Section	S ___ T ___ R ___	_____
	S ___ T ___ R ___	_____
3. Miscellaneous Property in Sec.	S ___ T ___ R ___	_____
	S ___ T ___ R ___	_____

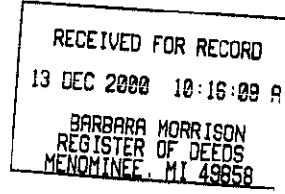

Register of Deeds Stamp & File Number

4. Lot No. _____, Recorded Plat _____
5. Private Claims _____

I, William Lenca, in a field survey on Jun., 1900 do hereby state that under requirements of P.A. 74, Michigan P.A. of 1970, the corner points mentioned in lines 1 and 2 above were in conformance with regulations and rules therefore as required in the current manual of survey instructions of the United States Department of the Interior, Bureau of Land Management or by a decree of a Court of Law and /or that the corner points mentioned in lines 3, 4 and 5 above were in conformance with the rules of the Michigan Board of Land Surveyors or by a Decree of a Court of Law; established, re-established, monumented, recovered, found as expressed below:

NOTE: Not more than 2 corners, all in the same town and range, may be recorded on this certificate.

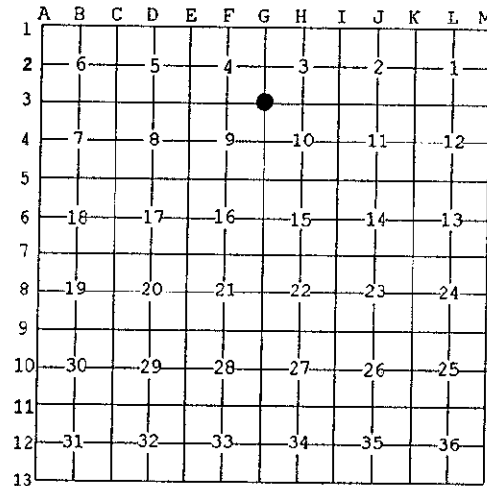

A. Description of original monument and accessories and/or subsequent restoration:

- 1848: Original Survey by James H. Mullett - B.T.'s - Birch, 14" - S33°W - 27 lks.; Hemlock, 14" - N19°E - 30 lks. All original evidence for this corner has been destroyed by farming activities.
- 1977: L.C.R.C. No. 171, Book 1 by George B. Wilson, RLS No. 17607 shows this corner on the back with a map showing distances to other corners in Section 4. The corner monument is shown as a concrete monument at a fence intersection - fences South and East.

B. Description of corner evidence found and/or method applied in restoring or reestablishing corner:

Found a 4 inch square concrete monument at an old fence intersection - fences run South and East from this location. This position matches with measurements to other corners as shown in L.C.R.C. No. 171, has been used for control for surveys in the area for over 23 years, and is accepted as the best available evidence of the position of the original corner.

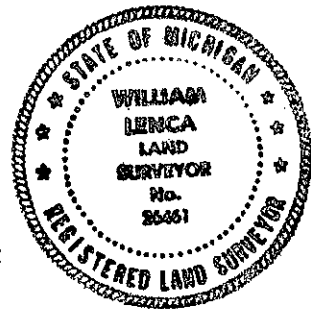

C. Description of monument for corner and accessories established to perpetuate locating the position of the corner:

Set 3/4" dia. Alum. cap stamped for corner location on existing 4" square concrete monument:

5" Elm	N10°E	23.95 feet	Scr. NBT
8" White Birch	S33°E	13.62 feet	Scr. NBT
6" Cedar	S56°W	31.99 feet	Scr. NBT
5" Cedar	N43°W	47.17 feet	Scr. NBT
Mctal Survey Sign Post	South	2.3 feet	

NOTE: All bearings are magnetic bearings. All distances are measured with steel tape. Distances to trees are to nail in side of tree.

Signed by William Lenca
Surveyor's Michigan License No. 26461

Date Aug. 8, 2000