

**SURVEY &  
REMONUMENTATION**

**JAN 09 2001**

**SECTION**

**LAND CORNER RECORDATION CERTIFICATE**  
Filing Requirement of Act 74, Mich. P.A. 1970

Approved by Menominee County  
Land Survey Remonumentation  
Peer Group Under Act 345 of  
P.A. Of 1990 On 7/13, 2000  
Mc Davis  
Chairman

*Book 6 Page 163*

For corners in <u>MENOMINEE</u> (County)	Located In:	Corner Code #
1. Public Land Survey	T <u>35</u> N R <u>26</u> W	G-4
	T ___ R ___	_____
	T ___ R ___	_____
	T ___ R ___	_____
2. Property Controlling in Section	S ___ T ___ R ___	_____
	S ___ T ___ R ___	_____
3. Miscellaneous Property in Sec.	S ___ T ___ R ___	_____
	S ___ T ___ R ___	_____

RECEIVED FOR RECORD  
13 DEC 2000 10:16:09 A  
BARBARA MORRISON  
REGISTER OF DEEDS  
MENOMINEE, MI 49858

Register of Deeds Stamp & File Number

4. Lot No. \_\_\_\_\_, Recorded Plat \_\_\_\_\_  
5. Private Claims \_\_\_\_\_

A	B	C	D	E	F	G	H	I	J	K	L	M
1												
2	6		5		4		3		2		1	
3												
4	7		8		9	●	10		11		12	
5												
6	18		17		16		15		14		13	
7												
8	19		20		21		22		23		24	
9												
10	30		29		28		27		26		25	
11												
12	31		32		33		34		35		36	
13												

I, William Lenca, in a field survey on Jul., 1900 do hereby state that under requirements of P.A. 74, Michigan P.A. of 1970, the corner points mentioned in lines 1 and 2 above were in conformance with regulations and rules therefore as required in the current manual of survey instructions of the United States Department of the Interior, Bureau of Land Management or by a decree of a Court of Law and /or that the corner points mentioned in lines 3, 4 and 5 above were in conformance with the rules of the Michigan Board of Land Surveyors or by a Decree of a Court of Law; established, re-established, monumented, recovered, found as expressed below:

NOTE: Not more than 2 corners, all in the same town and range, may be recorded on this certificate.

A. Description of original monument and accessories and/or subsequent restoration:

1848: Original Survey by James H. Mullett - B.T.'s - Beech, 6" - S43°W - 14 lks.; Beech, 14" - S63°E - 39 lks. All original evidence for this corner has been destroyed by County Road improvements.

B. Description of corner evidence found and/or method applied in restoring or reestablishing corner:

Set corner in line with old fences East and South and in line with the centerline of County Roads North - West. This location fits well with existing occupation lines 1/4 mile North and with measurements to corners 1/2 mile North and 1/2 mile South, and is accepted as the best available evidence of the position of the original corner.

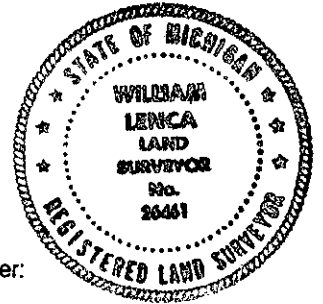

C. Description of monument for corner and accessories established to perpetuate locating the position of the corner:

Set 2" dia. Aluminum Pipe 30" long/3-1/4" dia. Alum cap stamped for corner location:

5/8" x 24" Iron Rod/2" dia. Alum. cap marked "WITNESS MARKER"	N64°E	42.73 feet	1' S of 15" Apple
5/8" x 24" Iron Rod/2" dia. Alum. cap marked "WITNESS MARKER"	S27°W	15.55 feet	1' NE of 6" Apple
5/8" x 24" Iron Rod/2" dia. Alum. cap marked "WITNESS MARKER"	N78°W	21.91 feet	1' E of Tel Box
Metal Survey Sign Post	S86°E	17.8 feet	

NOTE: All bearings are magnetic bearings. All distances are measured with steel tape. Distances to trees are to nail in side of tree.

Signed by William Lenca  
Surveyor's Michigan License No. 26461

Date Aug. 8, 2000