

MAR 29 2000

SECTION

LAND CORNER RECORDATION CERTIFICATE
Filing Requirement of Act 74, Mich. P.A. 1970

Approved by Menominee County
Land Survey Remonumentation
Peer Group Under Act 345 Of
P.A. Of 1990 On 12/22 1999
Mel Davis RLS
Chairman

For corners in
MENOMINEE
(County)

Located In: Corner Code #

- | | | |
|------------------------------------|-----------------------------|-------|
| 1. Public Land Survey | T <u>35</u> N R <u>26</u> W | G-9 |
| | T ___ R ___ | _____ |
| | T ___ R ___ | _____ |
| | T ___ R ___ | _____ |
| 2. Property Controlling in Section | S ___ T ___ R ___ | _____ |
| | S ___ T ___ R ___ | _____ |
| 3. Miscellaneous Property in Sec. | S ___ T ___ R ___ | _____ |
| | S ___ T ___ R ___ | _____ |

Bk. 6 Pg. 78

RECEIVED FOR RECORD
28 DEC 1999 3:56:09 PM
BARBARA MORRISON
REGISTER OF DEEDS
MENOMINEE, MI 49858

Register of Deeds Stamp & File Number

4. Lot No. _____, Recorded Plat _____
5. Private Claims _____

I, William Lenca, in a field survey on Aug., 1999 do hereby state that under requirements of P.A. 74, Michigan P.A. of 1970, the corner points mentioned in lines 1 and 2 above were in conformance with regulations and rules therefore as required in the current manual of survey instructions of the United States Department of the Interior, Bureau of Land Management or by a decree of a Court of Law and/or that the corner points mentioned in lines 3, 4 and 5 above were in conformance with the rules of the Michigan Board of Land Surveyors or by a Decree of a Court of Law; established, re-established, monumented, recovered, found as expressed below:

NOTE: Not more than 2 corners, all in the same town and range, may be recorded on this certificate.

	A	B	C	D	E	F	G	H	I	J	K	L	M
1													
2	6		5		4		3		2		1		
3													
4	7		8		9		10		11		12		
5													
6	18		17		16		15		14		13		
7													
8	19		20		21		22		23		24		
9													
10	30		29		28		27		26		25		
11													
12	31		32		33		34		35		36		
13													

A. Description of original monument and accessories and/or subsequent restoration:

- 1848: Original Survey by James H. Mullett - B.T.'s - Birch, 12" - S70°W - 24 lks.; Sugar, 35" - N36°E - 05 lks. All original evidence for this corner has been destroyed by county road improvements.
1975: L.C.R.C. No. 118 by David Babbitt, RLS No. 21558, states "set 1/2" dia. pipe in c/l rd intersection - could find no other evidence." B.T.'s: 8" Elm - N10°E - 151.3'; 3" Cedar - S42°W - 106.3'

B. Description of corner evidence found and/or method applied in restoring or reestablishing corner:

We recovered a 1/2 inch diameter iron pipe in the center of a 4 way county road intersection, along with 2 B.T.'s in location as described in L.C.R.C. No. 118 in part "A" above. This corner position fits well with existing lines of occupation, has been used by local surveyors for at least 24 years, and is accepted as the best available evidence of the position of the original corner.

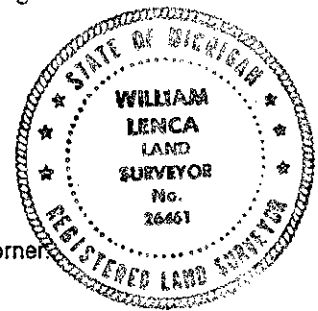

C. Description of monument for corner and accessories established to perpetuate locating the position of the corner:

Set 5/8" x 24" Iron Rod/3-1/4" dia. Alum. cap stamped for corner location in Monument Box:

- | | | | |
|---|-------|-------------|-------------------|
| 6" dia. White Ash | N14°E | 113.61 feet | Scr. NBT |
| 5/8" x 24" Iron Rod/plastic Ident. cap | S44°E | 47.30 feet | |
| 5/8" x 24" Iron Rod/2" dia. Alum. cap marked "WITNESS MARKER" | S49°W | 61.34 feet | 1' E. of Tel. Box |
| 5/8" x 24" Iron Rod/2" dia. Alum. cap marked "WITNESS MARKER" | N46°W | 48.10 feet | 1' W. of Tel. Box |
| Metal Survey Sign Post | S44°E | 47.8 feet | |

NOTE: All bearings are magnetic bearings. All distances are measured with EDM. Distances to trees are to nail in side of tree.

Signed by William Lenca
Surveyor's Michigan License No. 26461

Date Aug. 30, 1999