

**SURVEY & REMONUMENTATION**

JAN 09 2001

SECTION

**LAND CORNER RECORDATION CERTIFICATE**  
Filing Requirement of Act 74, Mich. P.A. 1970

Approved by Menominee County  
Land Survey Remonumentation  
Peer Group Under Act 345 of  
P.A. of 1990 On 12/22, 2000  
Me. David RLS  
Chairman

For corners in

MENOMINEE

(County)

Located In:

Corner Code #

- |                                    |                            |             |
|------------------------------------|----------------------------|-------------|
| 1. Public Land Survey              | T <u>35</u> NR <u>26</u> W | <u>I-11</u> |
|                                    | T ___ R ___                | _____       |
|                                    | T ___ R ___                | _____       |
|                                    | T ___ R ___                | _____       |
| 2. Property Controlling in Section | S ___ T ___ R ___          | _____       |
|                                    | S ___ T ___ R ___          | _____       |
| 3. Miscellaneous Property in Sec.  | S ___ T ___ R ___          | _____       |
|                                    | S ___ T ___ R ___          | _____       |

Br. 6 Pg. 238

RECEIVED FOR RECORD  
28 DEC 2000 2:31:31 PM  
BARBARA MORRISON  
REGISTER OF DEEDS  
MENOMINEE, MI 49858

Register of Deeds Stamp & File Number

4. Lot No. \_\_\_\_\_, Recorded Plat \_\_\_\_\_  
5. Private Claims \_\_\_\_\_

I, William Lenca, in a field survey on Oct., 19 00 do hereby state that under requirements of P.A. 74, Michigan P.A. of 1970, the corner points mentioned in lines 1 and 2 above were in conformance with regulations and rules therefore as required in the current manual of survey instructions of the United States Department of the Interior, Bureau of Land Management or by a decree of a Court of Law and /or that the corner points mentioned in lines 3, 4 and 5 above were in conformance with the rules of the Michigan Board of Land Surveyors or by a Decree of a Court of Law; established, re-established, monumented, recovered, found as expressed below:

NOTE: Not more than 2 corners, all in the same town and range, may be recorded on this certificate.

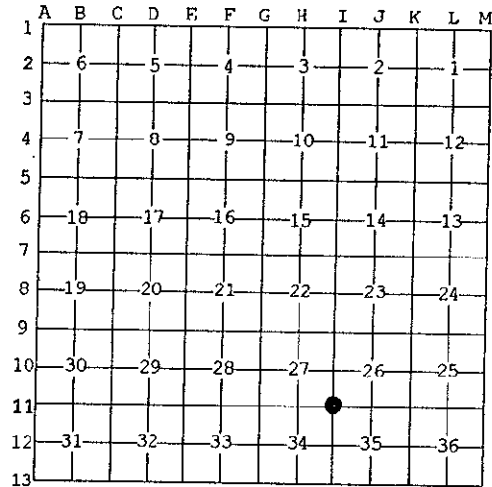

A. Description of original monument and accessories and/or subsequent restoration:

- 1848: Original Survey by James H. Mullett - B.T.'s - Tamarack, 6" - S63°W - 14 lks.; Tamarack, 6" - N63°E - 22 lks. All original evidence for this corner has been destroyed by years of decay.  
1975: L.C.R.C. No. 119, Book 1, by David B. Babbitt, RLS No, 21558 states "Set 1" pipe, 4" aluminum cap from 8" tam. stub with definite blaze (no scribe marks visible) for N.E. o.b.t. - stump remains in place for S.W. o.b.t. but almost completely rotted away." TIES: Cedar 3", N80°W, 20.1'; Cedar 6", N55°E, 18.5'. Partly dead.

B. Description of corner evidence found and/or method applied in restoring or reestablishing corner:

We found a 1 inch diameter Iron Pipe with a standard DNR 4 inch diameter aluminum cap in place as described in L.C.R.C. No. 119 (see part A). There is very little left of the Original B.T.'s used by David Babbitt - the Tamarack stub is down. The corner falls in a very large marsh and all of the surrounding trees are dead. We accepted the existing monument as a careful and faithful perpetuation of the position of the original corner.

C. Description of monument for corner and accessories established to perpetuate locating the position of the corner:

Accepted Existing 1" dia. Iron Pipe/4" Alum. Cap stamped for corner location.

- |                               |       |           |          |
|-------------------------------|-------|-----------|----------|
| 4" dia. Cedar (Existing B.T.) | N80°W | 20.1 feet | Scr. NBT |
| 6" dia. Cedar (Existing B.T.) | N55°E | 18.5 feet | Scr. NBT |
| Metal Survey Sign Post        | East  | 0.8 feet  |          |
| Nothing Else Nearby           |       |           |          |

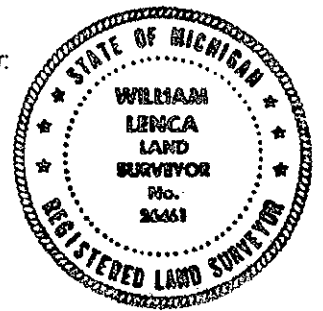

NOTE: All bearings are magnetic bearings. All distances are measured with steel tape. Distances to trees are to nail in side of tree.

Signed by William Lenca  
Surveyor's Michigan License No. 26461

Date Nov. 16, 2000