

**SURVEY & REMONUMENTATION**

JAN 09 2001

SECTION

**LAND CORNER RECORDATION CERTIFICATE**  
Filing Requirement of Act 74, Mich. P.A. 1970

Approved by Menominee County  
Land Survey Remonumentation  
Peer Group Under Act 345 of  
P.A. Of 1990 On 12/22 2000  
Mike Davis RLS  
Chairman

BR 6 Pg. 240

For corners in	Located in:	Corner Code #
MENOMINEE (County)		
1. Public Land Survey	T <u>35</u> N R <u>26</u> W	I-13
	T ___ R ___	_____
	T ___ R ___	_____
	T ___ R ___	_____
2. Property Controlling in Section	S ___ T ___ R ___	_____
	S ___ T ___ R ___	_____
3. Miscellaneous Property in Sec.	S ___ T ___ R ___	_____
	S ___ T ___ R ___	_____

RECEIVED FOR RECORD  
28 DEC 2000 2:31:31 PM  
BARBARA MORRISON  
REGISTER OF DEEDS  
MENOMINEE, MI 49859

Register of Deeds Stamp & File Number

4. Lot No. \_\_\_\_\_, Recorded Plat \_\_\_\_\_  
5. Private Claims \_\_\_\_\_  
SAME AS CORNER I-1, T34N-R26W

	A	B	C	D	E	F	G	H	I	J	K	L	P
1													
2	6		5		4		3		2		1		
3													
4	7		8		9		10		11		12		
5													
6	18		17		16		15		14		13		
7													
8	19		20		21		22		23		24		
9													
10	30		29		28		27		26		25		
11													
12	31		32		33		34		35		36		
13													

I, William Lenca, in a field survey on Dec., 1900 do hereby state that under requirements of P.A. 74, Michigan P.A. of 1970, the corner points mentioned in lines 1 and 2 above were in conformance with regulations and rules therefore as required in the current manual of survey instructions of the United States Department of the Interior, Bureau of Land Management or by a decree of a Court of Law and/or that the corner points mentioned in lines 3, 4 and 5 above were in conformance with the rules of the Michigan Board of Land Surveyors or by a Decree of a Court of Law; established, re-established, monumented, recovered, found as expressed below:

NOTE: Not more than 2 corners, all in the same town and range, may be recorded on this certificate.

A. Description of original monument and accessories and/or subsequent restoration:

- 1848: Original Survey by James H. Mullett - B.T.'s - Tamarack, 5" - N55°E - 7 lks.; Tamarack, 7" - N25°W - 9 lks.; Tamarack 8", S75°W, 7 lks.; Tamarack 8", S57°E, 18 lks. All original evidence for this corner has been destroyed by County Road improvements.
- 1975: L.C.R.C. No. 119, Book 1, by David B. Babbitt, RLS No. 21558 states "Set 1" pipe, 4" aluminum cap from blazed tam. stub for S.E. g.l.o. wit. line Tree south at 11.77 chs. g.l.o. notes say L.T. was at 13.90 but this has definite hack marks and is the right size etc." TIES: Cedar 6", NW, 18.0'; Cedar 7", West 25.4'.

B. Description of corner evidence found and/or method applied in restoring or reestablishing corner:

We recovered a 1 inch diameter iron pipe with 4 inch diameter aluminum cap and 1 B.T. (Cedar, 6" - NW - 18.0') in place per L.C.R.C. No. 119, Book 1 (see part A). The other B.T. is down. This entire area consists of brush and dead cedar trees in lake bog and marsh. Since this corner was re-set from original evidence, we accepted the existing monument as a careful and faithful perpetuation of the position of the original corner.

C. Description of monument for corner and accessories established to perpetuate locating the position of the corner:

Accepted Existing 1" dia. Iron Pipe/4" Alum. Cap stamped for corner location.

6" dia. Cedar (dead) - Ex. B.T. - Set new nail	N23°W	18.00 feet	Scr. NBT
6" dia. Cedar (dead)	S87°W	43.42 feet	Scr. NBT
Metal Survey Sign Post	East	1.0 feet	
Nothing else nearby, all dead cedar swamp & bog			

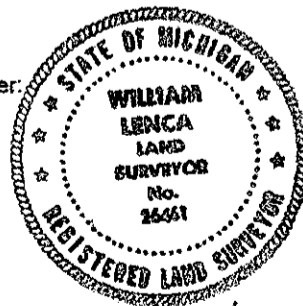

NOTE: All bearings are magnetic bearings. All distances are measured with steel tape. Distances to trees are to nail in side of tree.

Signed by William Lenca  
Surveyor's Michigan License No. 26461

Date Dec. 21, 2000