

# SURVEY & REMONUMENTATION

FEB 11 1998

Approved by Menominee County  
Land Survey Remonumentation  
Peer Group Under Act 345 Of  
P.A. Of 1990 On 12/30, 1997  
Mr. Davis BLS  
Chairman

## LAND CORNER RECORDATION CERTIFICATE Filing Requirement of Act 74, Mich. P.A. 1970

### SECTION

For corners in  
MENOMINEE  
(County)

Located in: Corner Code #

- |                                    |                             |       |
|------------------------------------|-----------------------------|-------|
| 1. Public Land Survey              | T <u>35</u> N R <u>26</u> W | K-03  |
|                                    | T ___ R ___                 | _____ |
|                                    | T ___ R ___                 | _____ |
|                                    | T ___ R ___                 | _____ |
| 2. Property Controlling in Section | S ___ T ___ R ___           | _____ |
|                                    | S ___ T ___ R ___           | _____ |
| 3. Miscellaneous Property in Sec.  | S ___ T ___ R ___           | _____ |
|                                    | S ___ T ___ R ___           | _____ |

REGISTERED LAND SURVEYOR  
97 DEC 30 PM 4:06  
PAGE # 624 BLS  
LARGATA MORGANSON  
REGISTERED LAND SURVEYOR  
MENOMINEE COUNTY  
Register of Deeds Stamp & File Number

4. Lot No. \_\_\_\_\_, Recorded Plat \_\_\_\_\_  
5. Private Claims \_\_\_\_\_

I, William Lenca, in a field survey on Oct. 30, 1997 do hereby state that under requirements of P.A. 74, Michigan P.A. of 1970, the corner points mentioned in lines 1 and 2 above were in conformance with regulations and rules therefore as required in the current manual of survey instructions of the United States Department of the Interior, Bureau of Land Management or by a decree of a Court of Law and/or that the corner points mentioned in lines 3, 4 and 5 above were in conformance with the rules of the Michigan Board of Land Surveyors or by a Decree of a Court of Law; established, re-established, monumented, recovered, found as expressed below:

NOTE: Not more than 2 corners, all in the same town and range, may be recorded on this certificate.

A	B	C	D	E	F	G	H	I	J	K	L	M
1												
2	6	5	4	3	2	1						
3												
4	7	8	9	10	11	12						
5												
6	18	17	16	15	14	13						
7												
8	19	20	21	22	23	24						
9												
10	30	29	28	27	26	25						
11												
12	31	32	33	34	35	36						
13												

A. Description of original monument and accessories and/or subsequent restoration:

1848: Original Survey by James H. Mullett - B.T.'s - Sugar, 12" - S25°W - 13 lks.; Birch, 10" - S17°E - 32 lks. All original evidence for this corner has been destroyed by county road improvements.

B. Description of corner evidence found and/or method applied in restoring or reestablishing corner:

We recovered a 3/4 inch x 19 inch iron rod with a point on one end in the centerline of county roads West and North and in line with the centerline of an old lane running East. This location fits well with measurements to other corners in the area and with existing lines of occupation, and is accepted as the best available evidence of the position of the original corner.

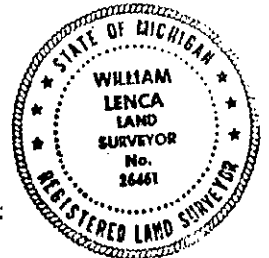

C. Description of monument for corner and accessories established to perpetuate locating the position of the corner:

Set 2" dia. Aluminum Pipe/3-1/4" dia. Alum cap stamped for corner location:

5/8" x 24" Iron Rod/2" dia. Alum. cap marked "WITNESS MARKER" at S. edge of stone pile	N38°E	23.28 feet
5/8" x 24" Iron Rod/2" dia. Alum. cap marked "WITNESS MARKER" 0.5' N.E. of P.P.	S53°E	52.25 feet
5/8" x 24" Iron Rod/2" dia. Alum. cap marked "WITNESS MARKER" 1.0' N.E. of Sign Post	S45°W	33.14 feet
5/8" x 24" Iron Rod/2" dia. Alum. cap marked "WITNESS MARKER" 1.0' S.E. of Twin 5" Apple	N48°W	42.32 feet
Metal Survey Sign Post	S45°W	33.9 feet

NOTE: All bearings are magnetic bearings. All distances are measured with steel tape. Distances to trees are to nail in side of tree.

Signed by William Lenca  
Surveyor's Michigan License No. 26461

Date Nov. 18, 1997