

SURVEY & REMONUMENTATION

OCT 27 1999

SECTION

LAND CORNER RECORDATION CERTIFICATE
Filing Requirement of Act 74, Mich. P.A. 1970

Approved by Menominee County
Land Survey Remonumentation
Peer Group Under Act 345 Of

P.A. of 1990 On 10/1 1999
Mc Davis RLS
Chairman

For corners in

<u>MENOMINEE</u> (County)	Located In:	Corner Code #
1. Public Land Survey	T <u>35N</u> R <u>27W</u>	<u>A-05</u>
	T _____ R _____	_____
	T _____ R _____	_____
	T _____ R _____	_____
2. Property Controlling in Section	S _____ T _____ R _____	_____
	S _____ T _____ R _____	_____
3. Miscellaneous Property in Sec.	S _____ T _____ R _____	_____
	S _____ T _____ R _____	_____

RECEIVED FOR RECORD
99 OCT 15 PM 1:41
PAGE # 16 BK 6
BARBARA MORRISON
REGISTER OF DEEDS
MENOMINEE MI 49888
Register of Deeds Stamp & File Number

4. Lot No. _____, Recorded Plat _____
5. Private Claims _____

(SAME AS CORNER M-05 T35N - R28W)

I, William Lenca, in a field survey on Sep, 1999 do hereby state that under requirements of P.A. 74, Michigan P.A. of 1970, the corner points mentioned in lines 1 and 2 above were in conformance with regulations and rules therefore as required in the current manual of survey instructions of the United States Department of the Interior, Bureau of Land Management or by a decree of a Court of Law and /or that the corner points mentioned in lines 3, 4 and 5 above were in conformance with the rules of the Michigan Board of Land Surveyors or by a Decree of a Court of Law; established, re-established, monumented, recovered, found as expressed below:

A	B	C	D	E	F	G	H	I	J	K	L	M
1												
2	6	5	4	3	2	1						
3												
4	7	8	9	10	11	12						
5												
6	18	17	16	15	14	13						
7												
8	19	20	21	22	23	24						
9												
10	30	29	28	27	26	25						
11												
12	31	32	33	34	35	36						
13												

NOTE: Not more than 2 corners, all in the same town and range, may be recorded on this certificate.

A. Description of original monument and accessories and/or subsequent restoration:

- 1847: Original Survey by H. Floyd - B.T.'s - Cedar, 14" - N63°W - 40 lks.; Cedar, 15" - S41°W - 28 lks. All original evidence for this corner has been destroyed by county road improvements.
- 1848: Sectional Subdivision by James H. Mullett - B.T.'s - Tamarack, 14" - N54°E - 26 lks.; Tamarack, 16" - S08°E - 14 lks. All original evidence for this corner has been destroyed by county road improvements.
- 1986: Certified Survey No. 468 by William Lenca, RLS No. 26461 shows this corner as it relates to other corners in Section 12, T35N-R28W.

B. Description of corner evidence found and/or method applied in restoring or reestablishing corner:

Field Notes in my office from a 1983 survey state that we set a railroad spike in the centerline of an East - West County Road and in line with an ancient fence line running South along with 2 ties - Power Pole - NW - 29.10 feet and Tamarack, 8" - NE - 59.23 feet. We recovered the railroad spike and 2 ties in the location as described. This position fits with ties to corners as shown in Certified Survey No. 468, and is accepted as the best available evidence of the position of the original corner.

C. Description of monument for corner and accessories established to perpetuate locating the position of the corner:

Set 5/8" x 24" Iron Rod/3-1/4" dia. Alum. cap stamped for corner location in Monument Box:

10" dia. Black Spruce	N40°E	59.21 feet	Scr. NBT
4" dia. Maple	S24°W	31.32 feet	Scr. NBT
12" dia. Black Spruce	N58°W	79.08 feet	Scr. NBT
10" dia. Black Spruce	North	50.05 feet	Scr. NBT
Metal Survey Sign Post	S08°W	29.5 feet	

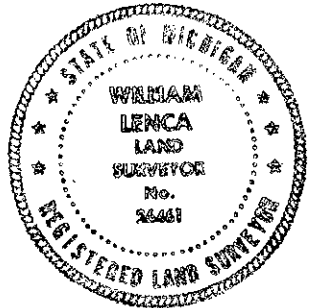

NOTE: All bearings are magnetic bearings. All distances are measured with steel tape. Distances to trees are to nail in side of tree.

Signed by William Lenca Date Sep. 22, 1999
Surveyor's Michigan License No. 26461