

**SURVEY & REMONUMENTATION**

OCT 27 1999

SECTION

**LAND CORNER RECORDATION CERTIFICATE**  
Filing Requirement of Act 74, Mich. P.A. 1970

Approved by Menominee County  
Land Survey Remonumentation  
Peer Group Under Act 345 Of  
P.A. Of 1990 On 10/11, 1999  
Mac Davis RLS  
Chairman

For corners in

<u>MENOMINEE</u> (County)	Located In:	Corner Code #
1. Public Land Survey	T <u>35N</u> R <u>27W</u>	<u>A-07</u>
	T _____ R _____	_____
	T _____ R _____	_____
	T _____ R _____	_____
2. Property Controlling in Section	S _____ T _____ R _____	_____
	S _____ T _____ R _____	_____
3. Miscellaneous Property in Sec.	S _____ T _____ R _____	_____
	S _____ T _____ R _____	_____

RECEIVED FOR RECORD  
99 OCT 15 PM 1:41  
PAGE # 17 BK 6  
BARBARA MORRISON  
REGISTER OF DEEDS  
MENOMINEE, MI 49858  
Register of Deeds Stamp & File Number

4. Lot No. \_\_\_\_\_, Recorded Plat \_\_\_\_\_  
5. Private Claims \_\_\_\_\_  
(SAME AS CORNER M-07 T35N - R28W)

I, William Lenca, in a field survey on Feb. 2, 1999 do hereby state that under requirements of P.A. 74, Michigan P.A. of 1970, the corner points mentioned in lines 1 and 2 above were in conformance with regulations and rules therefore as required in the current manual of survey instructions of the United States Department of the Interior, Bureau of Land Management or by a decree of a Court of Law and/or that the corner points mentioned in lines 3, 4 and 5 above were in conformance with the rules of the Michigan Board of Land Surveyors or by a Decree of a Court of Law; established, re-established, monumented, recovered, found as expressed below:

NOTE: Not more than 2 corners, all in the same town and range, may be recorded on this certificate.

A	B	C	D	E	F	G	H	I	J	K	L	M
1												
2	6		5		4		3		2		1	
3												
4	7		8		9		10		11		12	
5												
6	18		17		16		15		14		13	
7												
8	19		20		21		22		23		24	
9												
10	30		29		28		27		26		25	
11												
12	31		32		33		34		35		36	
13												

A. Description of original monument and accessories and/or subsequent restoration:

- 1847: Original Survey by John Mullett - B.T.'s - Tamarack, 10" - N40°W - 11 lks.; Tamarack, 8" - S32°W - 35 lks. All original evidence for this corner has been destroyed by logging activities.
- 1848: Sectional Subdivision by James H. Mullett - B.T.'s - Tamarack, 12" - N71°E - 23 lks.; Tamarack, 12" - S25°E - 17 lks. All original evidence for this corner has been destroyed by logging activities.

B. Description of corner evidence found and/or method applied in restoring or reestablishing corner:

The position for this corner was re-established based on single proportional measurement between the W1/4 Corner of Section 18 (A-6) and the W1/4 Corner of Section 19 (A-8). Measuring East from this position, we intersect a stream at 257 feet, which matches the GLO call of 3.9 chains. We accepted this corner location as a careful and faithful reestablishment of the position of the original corner.

C. Description of monument for corner and accessories established to perpetuate locating the position of the corner:

Set 3/4" dia. x 4' long aluminum rod/3-1/4" dia. Alum. cap stamped for corner.

This entire area has been cut over and flooded and there are no live trees nearby.

Metal Survey Sign Post North 1.0 feet

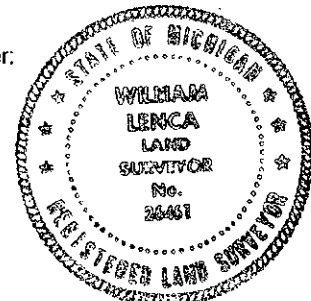

NOTE: All bearings are magnetic bearings. All distances are measured with steel tape. Distances to trees are to nail in side of tree.

Signed by William Lenca  
Surveyor's Michigan License No. 26461

Date Sep. 7, 1999