

APR 06 1999

Approved by Menominee County
Land Survey Remonumentation
Peer Group Under Act 345 Of
P.A. Of 1990 On 12/30 1998
McBain RLS
Chairman

LAND CORNER RECORDATION CERTIFICATE
Filing Requirement of Act 74, Mich. P.A. 1970

For corners in

MENOMINEE

(County)

Located In:

Corner Code #

- 1. Public Land Survey T 35N R 27W C-08
T _____ R _____
T _____ R _____
T _____ R _____
- 2. Property Controlling in Section S _____ T _____ R _____
S _____ T _____ R _____
- 3. Miscellaneous Property in Sec. S _____ T _____ R _____
S _____ T _____ R _____

RECEIVED FOR RECORD
99 JAN -6 AM 8:54
PAGE # 713 BK 5
BARBARA MORRISON
REGISTER OF DEEDS
MENOMINEE, MI 49858

Register of Deeds Stamp & File Number

- 4. Lot No. _____, Recorded Plat _____
- 5. Private Claims _____

I, William Lenca, in a field survey on Mar. 12, 19 98 do hereby state that under requirements of P.A. 74, Michigan P.A. of 1970, the corner points mentioned in lines 1 and 2 above were in conformance with regulations and rules therefore as required in the current manual of survey instructions of the United States Department of the Interior, Bureau of Land Management or by a decree of a Court of Law and /or that the corner points mentioned in lines 3, 4 and 5 above were in conformance with the rules of the Michigan Board of Land Surveyors or by a Decree of a Court of Law; established, re-established, monumented, recovered, found as expressed below:

NOTE: Not more than 2 corners, all in the same town and range, may be recorded on this certificate.

	A	B	C	D	E	F	G	H	I	J	K	L	M
1													
2		6		5		4		3		2		1	
3													
4		7		8		9		10		11		12	
5													
6		18		17		16		15		14		13	
7													
8		19		20		21		22		23		24	
9													
10		30		29		28		27		26		25	
11													
12		31		32		33		34		35		36	
13													

A. Description of original monument and accessories and/or subsequent restoration:

1848: Original Survey by James H. Mullett - B.T.'s - Cedar, 10" - N20°W - 13 lks.; Cedar, 6" - S67°W - 12 lks. All original evidence for this corner has been destroyed by logging activities.

B. Description of corner evidence found and/or method applied in restoring or reestablishing corner:

We computed the single proportional location for this corner, traversed in to it and searched the area. We found no evidence of the original corner accessories, or evidence of subsequent restoration. We set this corner midpoint and on a line between Corner C-7 and Corner C-9. The measurements to corners 1/2 mile North and 1/2 mile South are 2629.68 feet. This location is accepted as a careful and faithful re-establishment of the position of the original corner.

C. Description of monument for corner and accessories established to perpetuate locating the position of the corner:

Set 3/4" x 4' Alum. Rod/3-1/4" dia. Alum. cap stamped for corner location:

5" dia. Spruce	N70°E	8.24 feet	Scr. NBT
8" dia. Tamarack	S30°E	3.35 feet	Scr. NBT
6" dia. Cedar	S46°W	16.97 feet	Scr. NBT
9" dia. Tamarack	N20°W	7.43 feet	Scr. NBT
Metal Survey Sign Post	North	0.85 feet	

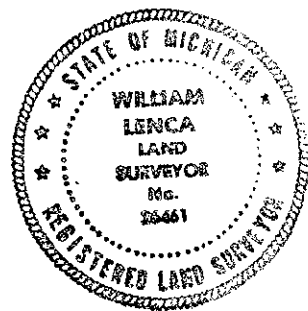

NOTE: All bearings are magnetic bearings. All distances are measured with steel tape. Distances to trees are to nail in side of tree.

Signed by William Lenca
Surveyor's Michigan License No. 26461

Date Dec. 22, 1998