

SURVEY 2
RECORDATION

APR 06 1999

Approved by Menominee County
Land Survey Remonumentation
Peer Group Under Act 345 Of
P.A. Of 1990 On 12/30, 1998
McNair RLS
Chairman

SECTION

LAND CORNER RECORDATION CERTIFICATE
Filing Requirement of Act 74, Mich. P.A. 1970

For corners in

<u>MENOMINEE</u> (County)	Located In:	Corner Code #
1. Public Land Survey	T <u>35NR</u> <u>27W</u>	<u>C-09</u>
	T _____ R _____	_____
	T _____ R _____	_____
	T _____ R _____	_____
2. Property Controlling in Section	S _____ T _____ R _____	_____
	S _____ T _____ R _____	_____
3. Miscellaneous Property in Sec.	S _____ T _____ R _____	_____
	S _____ T _____ R _____	_____

RECEIVED FOR RECORD
99 JAN -6 AM 8:56
PAGE # 714 BK 5
BARBARA MORRISON
REGISTER OF DEEDS
MENOMINEE MI 49828

Register of Deeds Stamp & File Number

4. Lot No. _____, Recorded Plat _____
5. Private Claims _____

I, William Lenca, in a field survey on May 07, 19 98 do hereby state that under requirements of P.A. 74, Michigan P.A. of 1970, the corner points mentioned in lines 1 and 2 above were in conformance with regulations and rules therefore as required in the current manual of survey instructions of the United States Department of the Interior, Bureau of Land Management or by a decree of a Court of Law and/or that the corner points mentioned in lines 3, 4 and 5 above were in conformance with the rules of the Michigan Board of Land Surveyors or by a Decree of a Court of Law, established, re-established, monumented, recovered, found as expressed below:

NOTE: Not more than 2 corners, all in the same town and range, may be recorded on this certificate.

A	B	C	D	E	F	G	H	I	J	K	L	M
1												
2	6	5	4	3	2	1						
3												
4	7	8	9	10	11	12						
5												
6	18	17	16	15	14	13						
7												
8	19	20	21	22	23	24						
9												
10	30	29	28	27	26	25						
11												
12	31	32	33	34	35	36						
13												

A. Description of original monument and accessories and/or subsequent restoration:

- 1848: Original Survey by James H. Mullett - B.T.'s - Elm, 15" - S68°E - 14 lks.; Cedar, 15" - N35°E - 36 lks. All original evidence for this corner has been destroyed by county road improvements.
- 1988: L.C.R.C. Number 821 by William Lenca, RLS 26461, states: "Re-established corner in centerline of East - West County Road and proportionately between the N1/4 Corner of Section 30 and the N1/4 Corner of Section 29." Set Railroad Spike - TIES: Tamarack, 9" - N67°E - 115.28'; Anchor Pole - N62°W - 84.37'; Power Pole - S57°E - 86.39'.

B. Description of corner evidence found and/or method applied in restoring or reestablishing corner:

We found a railroad spike and 3 witnesses in location as indicated in Land Corner Recordation Certificate Number 821. The corner falls in the centerline of an East - West county road and at a proportionate location between the N1/4 Corner of Section 30 and the N1/4 Corner of Section 29, T35N-R27W, and is accepted as the best available evidence of the position of the original corner.

C. Description of monument for corner and accessories established to perpetuate locating the position of the corner:

Set 5/8" x 24" Iron Rod/3-1/4" dia. Alum. cap stamped for corner location in Monument Box:

12" dia. Tamarack (New nail in Ex. B.T.)	N67°E	114.91 feet	Scr. NBT
10" dia. Balsam	S54°E	108.35 feet	Scr. NBT
5/8" x 24" Iron Rod/2" dia. Alum. cap marked "WITNESS MARKER"	South	34.55 feet	@ Sign Post
5/8" x 24" Iron Rod/2" dia. Alum. cap marked "WITNESS MARKER"	N35°W	59.64 feet	1' E. of 2" Steel Gate Post
Metal Survey Sign Post	South	35.5 feet	

NOTE: All bearings are magnetic bearings. All distances are measured with steel tape. Distances to trees are to nail in side of tree.

Signed by William Lenca
Surveyor's Michigan License No. 26461

Date Dec. 22, 1998

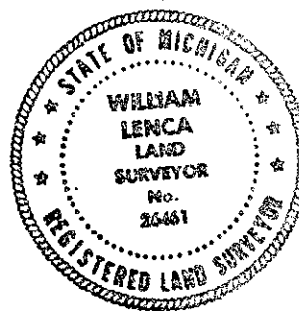

714