

MAR 29 2000

SECTION

Approved by Menominee County
Land Survey Remonumentation
Peer Group Under Act 345 Of
P.A. Of 1990 On 10/11, 1999
McC Davis RLS
Chairman

LAND CORNER RECORDATION CERTIFICATE
Filing Requirement of Act 74, Mich. P.A. 1970

For corners in
MENOMINEE
(County)

Located In:	Corner Code #
1. Public Land Survey	T <u>35</u> N R <u>27</u> W D-3
	T___ R___
	T___ R___
	T___ R___
2. Property Controlling in Section	S___ T___ R___
	S___ T___ R___
3. Miscellaneous Property in Sec.	S___ T___ R___
	S___ T___ R___

Bx 6 Pg. 96
RECEIVED FOR RECORD
28 DEC 1999 3:56:09 PM
BARBARA MORRISON
REGISTER OF DEEDS
MENOMINEE, MI 49858

Register of Deeds Stamp & File Number

4. Lot No. _____, Recorded Plat _____
5. Private Claims _____

I, William Lenca, in a field survey on Dec., 1999 do hereby state that under requirements of P.A. 74, Michigan P.A. of 1970, the corner points mentioned in lines 1 and 2 above were in conformance with regulations and rules therefore as required in the current manual of survey instructions of the United States Department of the Interior, Bureau of Land Management or by a decree of a Court of Law and /or that the corner points mentioned in lines 3, 4 and 5 above were in conformance with the rules of the Michigan Board of Land Surveyors or by a Decree of a Court of Law, established, re-established, monumented, recovered, found as expressed below:

NOTE: Not more than 2 corners, all in the same town and range, may be recorded on this certificate.

A	B	C	D	E	F	G	H	I	J	K	L	M
1												
2	6		5		4		3		2		1	
3			●									
4	7		8		9		10		11		12	
5												
6	18		17		16		15		14		13	
7												
8	19		20		21		22		23		24	
9												
10	30		29		28		27		26		25	
11												
12	31		32		33		34		35		36	
13												

A. Description of original monument and accessories and/or subsequent restoration:

1848: Original Survey by James H. Mullett - B.T.'s - Ironwood, 8" - N68°W - 22 lks; Birch, 10" - S47°E - 29 lks. All original evidence for this corner has been destroyed by county road improvements.

B. Description of corner evidence found and/or method applied in restoring or reestablishing corner:

We re-established this corner in line with the centerline of county roads running North and South, and in line with an ancient fence line running East. This position falls 7 feet South of the centerline of a county road running West, fits existing lines of occupation, and with measurements to corners 1/2 mile East (2623.58 feet) and 1/2 mile West (2684.28 feet), and is accepted as the best available evidence of the position of the original corner.

C. Description of monument for corner and accessories established to perpetuate locating the position of the corner:

Set 2" dia. Aluminum Pipe 30" long/3-1/4" dia. Alum cap stamped for corner location:

12" dia. White Pine	S52°E	53.47 feet	Scr. NBT
7" dia. Cherry	S20°W	68.45 feet	Scr. NBT
5" dia. White Pine	N32°W	55.27 feet	Scr. NBT
Nothing else nearby			
Metal Survey Sign Post	N82°W	30.6 feet	

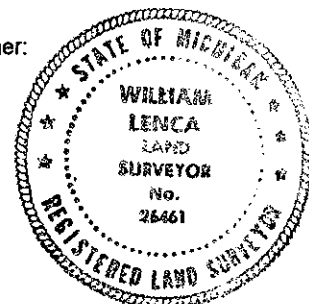

NOTE: All bearings are magnetic bearings. All distances are measured with steel tape. Distances to trees are to nail in side of tree.

Signed by William Lenca
Surveyor's Michigan License No. 26461

Date Dec. 17, 1999