

APR 06 1999

SECTION

LAND CORNER RECORDATION CERTIFICATE
Filing Requirement of Act 74, Mich. P.A. 1970

Approved by Menominee County
Lead Survey Remonumentation
Peer Group Under Act 345 Of

P.A. of 1998 On 10/29 19998
James J. Warren P.S.

For corners in

MENOMINEE

(County)

Located In:

Corner Code #

1. Public Land Survey

T 35NR 27W E-10

T _____ R _____

T _____ R _____

T _____ R _____

2. Property Controlling
in Section

S _____ T _____ R _____

S _____ T _____ R _____

3. Miscellaneous
Property in Sec.

S _____ T _____ R _____

S _____ T _____ R _____

4. Lot No. _____, Recorded Plat _____

5. Private Claims _____

I, William Lenca, in a field survey on Mar. 20, 1998 do hereby state that under requirements of P.A. 74, Michigan P.A. of 1970, the corner points mentioned in lines 1 and 2 above were in conformance with regulations and rules therefore as required in the current manual of survey instructions of the United States Department of the Interior, Bureau of Land Management or by a decree of a Court of Law and /or that the corner points mentioned in lines 3, 4 and 5 above were in conformance with the rules of the Michigan Board of Land Surveyors or by a Decree of a Court of Law; established, re-established, monumented, recovered, found as expressed below:

NOTE: Not more than 2 corners, all in the same town and range, may be recorded on this certificate.

98 NOV 16 AM 9:59
RECEIVED FOR RECORD

PAGE # 635 285
BARBARA MORRISON
REGISTER OF DEEDS
MENOMINEE MI 49868

Register of Deeds Stamp & File Number

	A	B	C	D	E	F	G	H	I	J	K	L	M
1													
2	6		5		4		3		2		1		
3													
4	7		8		9		10		11		12		
5													
6	18		17		16		15		14		13		
7													
8	19		20		21		22		23		24		
9													
10	30		29	⊕	28		27		26		25		
11													
12	31		32		33		34		35		36		
13													

A. Description of original monument and accessories and/or subsequent restoration:

- 1848: Original Survey by James H. Mullett - B.T.'s - Birch, 10" - N16°W - 22 lks.; B. Ash, 8" - N32°E - 26 lks. All original evidence for this corner has been destroyed by logging activities.
- 1984: L.C.R.C. Number 603 by George B. Wilson states, "NO ORIG. EVIDENCE FOUND: USED OLD FENCE CORNER" - Set 4" dia. Berntsen HDR Monument. TIES: Deep 1 set 2' North and 2' East.

B. Description of corner evidence found and/or method applied in restoring or reestablishing corner:

We found an existing HDR Monument in a position as described in Land Corner Recordation Certificate Number 603 by George B. Wilson, RLS 17607. This position has been used for many years, fits existing fence lines West and North, and is accepted as the best available evidence of the position of the original corner.

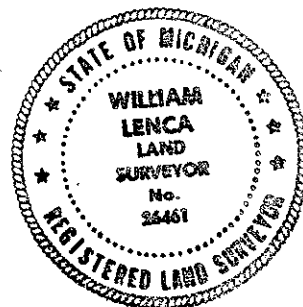

C. Description of monument for corner and accessories established to perpetuate locating the position of the corner:

Accepted existing HDR monument and stamped it for corner location:

- 20" dia. Spruce N51°E 62.05 feet Scr. NBT
- 4" dia. Balsam N77°W 39.43 feet Scr. NBT
- 7" dia. Balsam N09°W 41.81 feet Scr. NBT
- Metal Survey Sign Post North 1.0 feet
- Nothing else nearby

NOTE: All bearings are magnetic bearings. All distances are measured with steel tape. Distances to trees are to nail in side of tree.

Signed by William Lenca
Surveyor's Michigan License No. 26461

Date Oct. 24, 1998

635