

SURVEY & REMONUMENTATION

APR 06 1999

Approved by Menominee County
Land Survey Remonumentation
Four Group Under Act 345 OF

LAND CORNER RECORDATION CERTIFICATE
Filing Requirement of Act 74, Mich. P.A. 1970

P.A. 011998 On 10/29 1998
Terence A. Wanic P.S.
Chairman

SECTION

For corners in

<u>MENOMINEE</u> (County)	Located In:	Corner Code #
1. Public Land Survey	T <u>35NR</u> <u>27W</u>	<u>E-11</u>
	T ___ R ___	_____
	T ___ R ___	_____
	T ___ R ___	_____
2. Property Controlling in Section	S ___ T ___ R ___	_____
	S ___ T ___ R ___	_____
3. Miscellaneous Property in Sec.	S ___ T ___ R ___	_____
	S ___ T ___ R ___	_____

RECEIVED FOR RECORD
98 NOV 16 AM 9:59
PAGE # 636 B/C S
BARBARA MORRISON
REGISTER OF DEEDS
MENOMINEE, MI 49850
Register of Deeds Stamp & File Number

4. Lot No. _____, Recorded Plat _____
5. Private Claims _____

I, William Lenca, in a field survey on Sep., 1998 do hereby state that under requirements of P.A. 74, Michigan P.A. of 1970, the corner points mentioned in lines 1 and 2 above were in conformance with regulations and rules therefore as required in the current manual of survey instructions of the United States Department of the Interior, Bureau of Land Management or by a decree of a Court of Law and/or that the corner points mentioned in lines 3, 4 and 5 above were in conformance with the rules of the Michigan Board of Land Surveyors or by a Decree of a Court of Law; established, re-established, monumented, recovered, found as expressed below:

NOTE: Not more than 2 corners, all in the same town and range, may be recorded on this certificate.

A	B	C	D	E	F	G	H	I	J	K	L	M
1												
2	6		5		4		3		2		1	
3												
4	7		8		9		10		11		12	
5												
6	18		17		16		15		14		13	
7												
8	19		20		21		22		23		24	
9												
10	30		29		28		27		26		25	
11												
12	31		32		33		34		35		36	
13												

A. Description of original monument and accessories and/or subsequent restoration:

- 1848: Original Survey by James H. Mullett - B.T.'s - W. Pine, 15" - S16°W - 29 lks.; W. Pine, 15" - N35°W - 03 lks. All original evidence for this corner has been destroyed by farming activities.
- 1984: Certified Survey Number 380 by George B. Wilson shows this corner as "LOST COR. PLOWED FIELD".
- 1995: Plat of Survey by William Lenca shows this corner in relation to other corners in Sections 28 and 33, T35N-R27W.

B. Description of corner evidence found and/or method applied in restoring or reestablishing corner:

Certified Survey No. 380, by George B. Wilson - RLS No. 17607, indicates that corner E-12 was re-set from 2 original B.T.'s. It also indicates that the stump of an original line tree was recovered at a distance of 1166.8 feet North of this position as compared to the GLO distance of 1157.0 feet. To establish corner E-11, Wilson proportioned this distance, arriving at a distance of 2662 feet compared to the original distance of 2640 feet, and extended the line between corner E-12 and the original pine stump to the North. We accepted this position as a careful and faithful reestablishment of the position of the original corner.

C. Description of monument for corner and accessories established to perpetuate locating the position of the corner:

Set 2" dia. Aluminum Pipe 30" long/3-1/4" dia. Alum cap stamped for corner location:

The corner monument falls in the middle of a large farm field with no witnesses nearby. The monument was set 12 inches below the surface to avoid destruction by farm machinery.

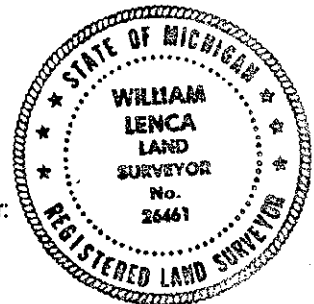

Signed by William Lenca
Surveyor's Michigan License No. 26461

Date Oct. 24, 1998