

APR 06 1999

SECTION

LAND CORNER RECORDATION CERTIFICATE
Filing Requirement of Act 74, Mich. P.A. 1970

Approved by Monominee County
Land Survey Remonumentation
Peer Group Under Act 345 of

P.A. of 1990 On 10/29 1998
James J. Wain P.S.

For corners in

MENOMINEE

(County)

Located In:

Corner Code #

- | | | | |
|------------------------------------|---------------|------------|-------------|
| 1. Public Land Survey | T <u>35NR</u> | <u>27W</u> | <u>F-09</u> |
| | T | R | |
| | T | R | |
| | T | R | |
| 2. Property Controlling in Section | S | T | R |
| | S | T | R |
| 3. Miscellaneous Property in Sec. | S | T | R |
| | S | T | R |

4. Lot No. _____, Recorded Plat _____
5. Private Claims _____

I, William Lenca, in a field survey on May 18, 19 98 do hereby state that under requirements of P.A. 74, Michigan P.A. of 1970, the corner points mentioned in lines 1 and 2 above were in conformance with regulations and rules therefore as required in the current manual of survey instructions of the United States Department of the Interior, Bureau of Land Management or by a decree of a Court of Law and/or that the corner points mentioned in lines 3, 4 and 5 above were in conformance with the rules of the Michigan Board of Land Surveyors or by a Decree of a Court of Law; established, re-established, monumented, recovered, found as expressed below:

NOTE: Not more than 2 corners, all in the same town and range, may be recorded on this certificate.

Chairman
AGE # 638 JKS
ARBARA MORRISON
REGISTER OF DEEDS
MENOMINEE MI 49858
NOV 16 AM 9:59
RECEIVED FOR RECORD
Register of Deeds Stamp & File Number

A	B	C	D	E	F	G	H	I	J	K	L	M
1												
2	6		5		4		3		2		1	
3												
4	7		8		9		10		11		12	
5												
6	18		17		16		15		14		13	
7												
8	19		20		21		22		23		24	
9												
10	30		29		28		27		26		25	
11												
12	31		32		33		34		35		36	
13												

A. Description of original monument and accessories and/or subsequent restoration:

- 1848: Original Survey by James H. Mullett - B.T.'s - Cedar, 6" - N44°W - 16 lks.; Birch, 8" - S25°E - 16 lks. All original evidence for this corner has been destroyed by county road improvements.
1984: L.C.R.C. No. 603 & Certified Survey No. 380 by George B. Wilson, RLS No. 17607, indicate location of this corner.
1988: L.C.R.C. Number 804 by William Lenca states, "Found corner in location indicated by retracement of Sectional Subdivision made by George B. Wilson, RLS 17607." Set 30" Alum. Mon./4" dia. Alum. cap stamped for corner location. TIES: Power Pole - N22°W - 40.77'; Power Pole - S49°E - 58.15'; Power Pole - South - 27.81'.

B. Description of corner evidence found and/or method applied in restoring or reestablishing corner:

We found a W-1-B monument sheared off in a location as indicated in Land Corner Recordation Certificate Number 804 by William Lenca, RLS No. 26461, which also matches the location shown in Certified Survey No. 380. Existing monument is in the centerline of an East - West county road and 15' West of the centerline of a county road to the North. This location has been used in several surveys, and is accepted as the best available evidence of the position of the original corner.

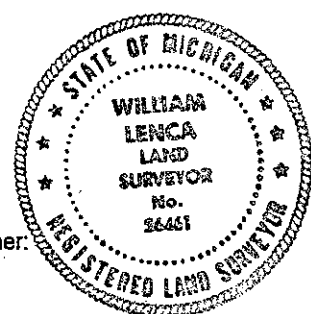

C. Description of monument for corner and accessories established to perpetuate locating the position of the corner:

- Set 5/8" x 24" Iron Rod/3-1/4" dia. Alum. cap stamped for corner location in Monument Box:
- | | | | |
|---|-------|-------------|---------------------|
| 4" dia. White Pine | N37°E | 106.12 feet | Scr. NBT |
| 5/8" x 24" Iron Rod/2" dia. Alum. cap marked "WITNESS MARKER" | S43°E | 56.76 feet | 1' W. of P.P. |
| 20" dia. Elm | S45°W | 111.65 feet | Scr. NBT |
| 5/8" x 24" Iron Rod/2" dia. Alum. cap marked "WITNESS MARKER" | N28°W | 41.68 feet | 2.5' W. of Tel. Box |
| Metal Survey Sign Post | South | 31.0 feet | |

NOTE: All bearings are magnetic bearings. All distances are measured with steel tape. Distances to trees are to nail in side of tree.

Signed by William Lenca
Surveyor's Michigan License No. 26461

Date Oct. 21, 1998