

APR 06 1999

SECTION

**LAND CORNER RECORDATION CERTIFICATE**  
Filing Requirement of Act 74, Mich. P.A. 1970

Approved by Menominee County  
Land Survey Remonumentation  
Peer Group Under Act 345 Of

P.A. Of 1990 On 10/29 1998  
James S. Wainwright P.S.  
Chairman

For corners in

<u>MENOMINEE</u> (County)	Located In:	Corner Code #
1. Public Land Survey	T <u>34</u> N R <u>27</u> W	<u>F-01</u>
	T ___ R ___	_____
	T ___ R ___	_____
	T ___ R ___	_____
2. Property Controlling in Section	S ___ T ___ R ___	_____
	S ___ T ___ R ___	_____
3. Miscellaneous Property in Sec.	S ___ T ___ R ___	_____
	S ___ T ___ R ___	_____

RECEIVED FOR RECORD  
98 NOV 16 AM 10:00  
PAGE # 646 BK 5  
BARBARA MORRISON  
REGISTER OF DEEDS  
MENOMINEE MI 49338  
Register of Deeds Stamp & File Number

4. Lot No. \_\_\_\_\_, Recorded Plat \_\_\_\_\_

5. Private Claims \_\_\_\_\_

(SAME AS CORNER F-13, T35N - R27W)

I, William Lenca, in a field survey on June 09, 1998 do hereby state that under requirements of P.A. 74, Michigan P.A. of 1970, the corner points mentioned in lines 1 and 2 above were in conformance with regulations and rules therefore as required in the current manual of survey instructions of the United States Department of the Interior, Bureau of Land Management or by a decree of a Court of Law and /or that the corner points mentioned in lines 3, 4 and 5 above were in conformance with the rules of the Michigan Board of Land Surveyors or by a Decree of a Court of Law, established, re-established, monumented, recovered, found as expressed below:

NOTE: Not more than 2 corners, all in the same town and range, may be recorded on this certificate.

	A	B	C	D	E	F	G	H	I	J	K	L	M
1						⊙							
2	6			5		4		3		2		1	
3													
4	7			8		9		10		11		12	
5													
6	18			17		16		15		14		13	
7													
8	19			20		21		22		23		24	
9													
10	30			29		28		27		26		25	
11													
12	31			32		33		34		35		36	
13													

A. Description of original monument and accessories and/or subsequent restoration:

- 1847: Original Survey by H. Floyd - B.T.'s - W. Pine, 30" - N70°E - 40 lks.; W. Pine, 14" - N30°W - 30 lks. All original evidence for this corner has been destroyed by county road improvements.  
Terrain Call: Enter swamp 3 Chains West and 2.5 Chains East of Corner.
- 1976: Certified Survey Number 59 by George B. Wilson shows a 1" round steel pin at this corner location.
- 1977: L.C.R.C. Number 160 by George B. Wilson states, "Found Long Iron Spike. Re-set 1-1/4" Iron Bar, 2 feet south of Road Centerline. Nothing near for direct ties. Should pick up strong on audio meter."

B. Description of corner evidence found and/or method applied in restoring or reestablishing corner:

We found a 1-1/4" diameter iron rod 30 inches long in a location as indicated in Land Corner Recordation Certificate Number 160 by George B. Wilson, RLS No. 17607. The corner falls in line with the county road centerline running South and 2 feet south of the East - West centerline. This location has been used in many surveys, and is accepted as the best available evidence of the position of the original corner.

C. Description of monument for corner and accessories established to perpetuate locating the position of the corner:

Set 5/8" x 36" Iron Rod/3-1/4" dia. Alum. cap stamped for corner location in Monument Box:

5/8" x 24" Iron Rod/2" dia. Alum. cap marked "WITNESS MARKER"	N35°E	33.06 feet	1' S. of 10" Spruce
9" dia. Cedar	S50°E	83.85 feet	Scr. NBT
5/8" x 24" Iron Rod/2" dia. Alum. cap marked "WITNESS MARKER"	S51°W	26.45 feet	1' N. of PP
5/8" x 24" Iron Rod/2" dia. Alum. cap marked "WITNESS MARKER"	N38°W	91.63 feet	1' SE of 26" W. Pine
Metal Survey Sign Post	N05°E	33.4 feet	

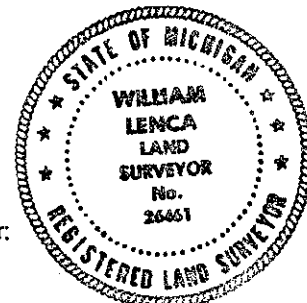

NOTE: All bearings are magnetic bearings. All distances are measured with steel tape. Distances to trees are to nail in side of tree.

Signed by William Lenca  
Surveyor's Michigan License No. 26461

Date Oct. 21, 1998