

APR 06 1999

SECTION

LAND CORNER RECORDATION CERTIFICATE
Filing Requirement of Act 74, Mich. P.A. 1970

Approved by Menominee County
Land Survey Remonumentation
Peer Group Under Act 345 Of
P.A. Of 1990 On 12/14 1998
MEL DAVIS RLS
Chairman

For corners in

<u>MENOMINEE</u> (County)	Located In:	Corner Code #
1. Public Land Survey	T <u>35</u> N R <u>27</u> W	<u>G-11</u>
	T ___ R ___	_____
	T ___ R ___	_____
	T ___ R ___	_____
2. Property Controlling in Section	S ___ T ___ R ___	_____
	S ___ T ___ R ___	_____
3. Miscellaneous Property in Sec.	S ___ T ___ R ___	_____
	S ___ T ___ R ___	_____

RECEIVED FOR RECORD
99 JAN 27 PM 1:33
PAGE # 75-3 BK 5
BARBARA MORRISON
REGISTER OF DEEDS
MENOMINEE, MI 49850

Register of Deeds Stamp & File Number

4. Lot No. _____, Recorded Plat _____
5. Private Claims _____

I, William Lenca, in a field survey on Oct. 26, 1998 do hereby state that under requirements of P.A. 74, Michigan P.A. of 1970, the corner points mentioned in lines 1 and 2 above were in conformance with regulations and rules therefore as required in the current manual of survey instructions of the United States Department of the Interior, Bureau of Land Management or by a decree of a Court of Law and /or that the corner points mentioned in lines 3, 4 and 5 above were in conformance with the rules of the Michigan Board of Land Surveyors or by a Decree of a Court of Law; established, re-established, monumented, recovered, found as expressed below:

NOTE: Not more than 2 corners, all in the same town and range, may be recorded on this certificate.

A	B	C	D	E	F	G	H	I	J	K	L	M
1												
2	6		5		4		3		2		1	
3												
4	7		8		9		10		11		12	
5												
6	18		17		16		15		14		13	
7												
8	19		20		21		22		23		24	
9												
10	30		29		28		27		26		25	
11												
12	31		32		33		34		35		36	
13												

A. Description of original monument and accessories and/or subsequent restoration:

1848: Original Survey by James H. Mullett - B.T.'s - Tamarack, 10" - N51°E - 09 lks.; Tamarack, 10" - S22°W - 09 lks. All original evidence for this corner has been destroyed by logging activities.

B. Description of corner evidence found and/or method applied in restoring or reestablishing corner:

We computed the double proportional location for this corner, traversed in to it and searched the area. We found no evidence of the original corner accessories, or evidence of subsequent restoration. This location is accepted as a careful and faithful re-establishment of the position of the original corner.

C. Description of monument for corner and accessories established to perpetuate locating the position of the corner:

Set 2" dia. Aluminum Pipe 30" long/3-1/4" dia. Alum. cap stamped for corner location:

12" dia. Cedar	N59°E	15.50 feet	"X" Cut in upper & lower blaze
6" dia. Cedar	S31°E	17.89 feet	"X" Cut in upper & lower blaze
10" dia. Cedar	S48°W	21.21 feet	"X" Cut in upper & lower blaze
8" dia. Cedar	N43°W	22.99 feet	"X" Cut in upper & lower blaze
Carsonite Survey Marker	East	0.8 feet	

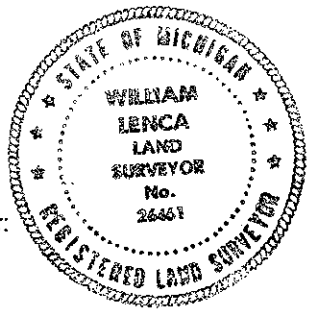

NOTE: All bearings are magnetic bearings. All distances are measured with steel tape. Distances to trees are to nail in side of tree.

Signed by William Lenca
Surveyor's Michigan License No. 26461

Date Nov. 04, 1998

753