

PA. Of 1990 On 07/26 1995

William Lenca  
Chairman

**LAND CORNER RECORDATION CERTIFICATE**  
Filing Requirement of Act 74, Mich. P.A. 1970

For corners in

|                                    |                           |                |
|------------------------------------|---------------------------|----------------|
| <u>MENOMINEE</u><br>(County)       | Located In:               | Corner Code #/ |
|                                    | T <u>35N</u> R <u>27W</u> | H-5            |
| 1. Public Land Survey              | T _____ R _____           | _____          |
|                                    | T _____ R _____           | _____          |
|                                    | T _____ R _____           | _____          |
|                                    | T _____ R _____           | _____          |
| 2. Property Controlling in Section | S _____ T _____ R _____   | _____          |
|                                    | S _____ T _____ R _____   | _____          |
| 3. Miscellaneous Property in Sec.  | S _____ T _____ R _____   | _____          |
|                                    | S _____ T _____ R _____   | _____          |

RECEIVED FOR RECORD  
95 NOV - 8 11:11:31  
PAGE 231 BK 4  
BARBARA JOHNSON  
REGISTERED LAND SURVEYOR  
MICHIGAN LICENSE NO. 26461

Register of Deeds Stamp & File Number

4. Lot No. \_\_\_\_\_, Recorded Plat \_\_\_\_\_  
5. Private Claims \_\_\_\_\_

William Lenca, in a field survey on Jul 18, 1995

do hereby certify that under requirements of P.A. 74, Michigan P.A. of 1970, the corner points mentioned in lines 1 and 2 above were in conformance with regulations and rules therefore as required in the current manual of survey instructions of the United States Department of the Interior, Bureau of Land Management or by a decree of a Court of Law and/or that the corner points mentioned in lines 3, 4 and 5 above were in conformance with the rules of the Michigan Board of Land Surveyors or by a Decree of a Court of Law; established, re-established, monumented, re-monumented, recovered, found as expressed below:

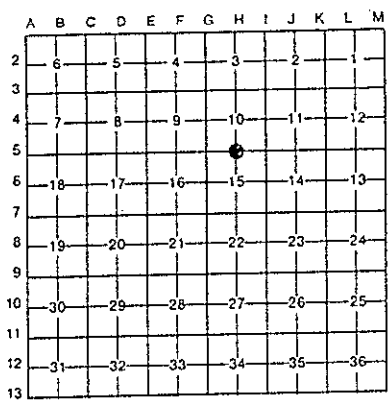

NOTE: Not more than 4 corners, all in the same town and range, may be recorded on this certificate.

Description of original monument and accessories and/or subsequent restoration:

- 1848: Original Survey by James H. Mullett - B.T.'s - Cedar, 6" - S21°W - 10 lks; Cedar, 10" - N50°W - 06 lks. All original evidence for this corner has been destroyed by county road improvements.
- 1985: LCRC No. 685, Book 2, recorded by William Lenca, RLS No. 26461, states that due to frost depth, a P.K. Nail was set in the centerline a county road East - West and in line with an old fence North. New Witnesses - 8" W. Ash - N28°W - 53.67'; 5" Cedar - N55°E - 48.69'; 6" Cedar - S24°E - 41.28'; 6" Elm - S65°W - 50.89'.

Description of corner evidence found and/or method applied in restoring or reestablishing corner:

In a February, 1995 survey of Section 10, T35N-R27W, we recovered a 5/8 inch diameter iron rod in a location matching the witnesses given in LCRC No. 685, mentioned in part "A" above. The corner position thus established fits well with existing lines of occupation and is accepted as the best available evidence of the position of the original corner.

Description of monument for corner and accessories established to perpetuate locating the position of the corner:

Set 5/8" x 24" Iron Rod/3-1/4" dia. Alum. cap stamped for corner location in Monument Box:

|                    |       |            |         |
|--------------------|-------|------------|---------|
| 5" dia. Cedar      | N55°E | 48.70 feet | Scr NBT |
| 8" dia. Cedar      | S57°E | 73.84 feet | Scr NBT |
| 6" dia. Cedar      | S11°E | 39.77 feet | Scr NBT |
| 11" dia. White Ash | N25°W | 54.05 feet | Scr NBT |

NOTE: All bearings are magnetic bearings. All distances are measured with a steel tape. Distances to trees are to nail in side of tree.

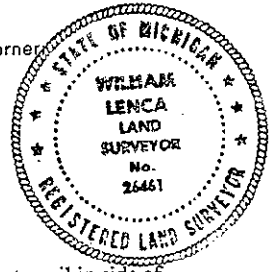

signed by William Lenca Date July 31, 1995  
Surveyor's Michigan License No. 26461

SURVEY & MONUMENTATION