

SURVEY & REMONUMENTATION

APR 06 1999

SECTION

LAND CORNER RECORDATION CERTIFICATE
Filing Requirement of Act 74, Mich. P.A. 1970

Approved by Menominee County
Land Survey Remonumentation
Peer Group Under Act 345 Of

P.A. of 1990 On 10/29 1998
James J. Upton P.S.

For corners in

MENOMINEE

(County)

Located In:

Corner Code #

- | | | | |
|------------------------------------|---------------|------------|-------------|
| 1. Public Land Survey | T <u>35NR</u> | <u>27W</u> | <u>H-11</u> |
| | T | R | |
| | T | R | |
| | T | R | |
| 2. Property Controlling in Section | S | T | R |
| | S | T | R |
| 3. Miscellaneous Property in Sec. | S | T | R |
| | S | T | R |

4. Lot No. _____, Recorded Plat _____
5. Private Claims _____

I, William Lenca, in a field survey on June 15, 19 98 do hereby state that under requirements of P.A. 74, Michigan P.A. of 1970, the corner points mentioned in lines 1 and 2 above were in conformance with regulations and rules therefore as required in the current manual of survey instructions of the United States Department of the Interior, Bureau of Land Management or by a decree of a Court of Law and/or that the corner points mentioned in lines 3, 4 and 5 above were in conformance with the rules of the Michigan Board of Land Surveyors or by a Decree of a Court of Law, established, re-established, monumented, recovered, found as expressed below:

NOTE: Not more than 2 corners, all in the same town and range, may be recorded on this certificate.

Chairman
PAGE # 641 BKS
BARBARA MORRISON
REGISTER OF DEEDS
MENOMINEE, MI 49858
98 NOV 16 AM 10:00
RECEIVED FOR RECORD
Register of Deeds Stamp & File Number

	A	B	C	D	E	F	G	H	I	J	K	L	M
1													
2		6		5		4		3		2		1	
3													
4		7		8		9		10		11		12	
5													
6		10		17		16		15		14		13	
7													
8		19		20		21		22		23		24	
9													
10		30		29		28		27		26		25	
11													
12		31		32		33		34		35		36	
13													

A. Description of original monument and accessories and/or subsequent restoration:

- 1848: Original Survey by James H. Mullett - B.T.'s - B. Ash, 6" - N05°E - 22 lks.; W. Ash, 6" - S36°W - 21 lks. All original evidence for this corner has been destroyed by logging activities.
Terrain Call: 0.79 Chains East intersect Little Cedar River, 2.79 Chains East leave swamp.
- 1901: Survey by Albert Hass shows he set a 4" Cedar post from Government B.T. on bank of Cedar River.
- 1982: L.C.R.C. Number 386 by George B. Wilson, RLS No. 17607, states, "Found old fence line North and South. Tie to West Bank of River." Set HDR Monument at Corner, magnet in cover. TIES: Deep 1 Magnet 1' North and 1' East.

B. Description of corner evidence found and/or method applied in restoring or reestablishing corner:

We found a Berntsen HDR monument in line with an ancient fence running North and South, as described in Land Corner Recordation Certificate Number 386. The location of the monument matches well with the GLO tie to the West Bank of the Little Cedar River and with measurements to the SE Corner and SW Corner of Section 27. This position has been accepted and used by local surveyors for at least 16 years, and is accepted as the best available evidence of the position of the original corner.

C. Description of monument for corner and accessories established to perpetuate locating the position of the corner:

Accepted existing Berntsen HDR Monument and stamped it for corner location:

12" dia. White Ash	N70°E	22.38 feet	Scr. NBT
14" dia. White Ash	S06°E	28.51 feet	Scr. NBT
9" dia. Cedar	S79°W	29.08 feet	Scr. NBT
11" dia. Cedar	N03°W	32.12 feet	Scr. NBT
Metal Survey Sign Post	N50°W	0.9 feet	
W. Bank Little Cedar River	East	55 feet	

NOTE: All bearings are magnetic bearings. All distances are measured with steel tape. Distances to trees are to nail in side of tree.

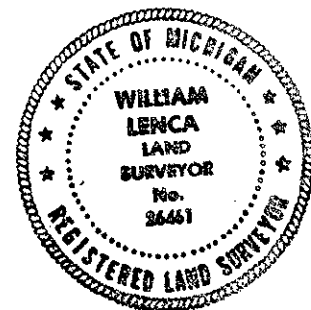

Signed by William Lenca
Surveyor's Michigan License No. 26461

Date Oct. 21, 1998

641