

P.A. Of 1990 On 10/26 19995

Mc Davis RLS
Chairman

RECEIVED FOR RECORD
NOV - 8 AM 11:31
PAGE # 234 BK 4
BARBARA HARRISON
REGISTERED LAND SURVEYOR
IRONSTONE COUNTY MICHIGAN

LAND CORNER RECORDATION CERTIFICATE
Filing Requirement of Act 74, Mich. P.A. 1970

For corners in

MENOMINEE
(County)

Located In: Corner Code #

1. Public Land Survey T 35N R 27W I-3
T R
T R
T R

2. Property Controlling S T R
in Section S T R

3. Miscellaneous S T R
Property in Sec. S T R

Register of Deeds Stamp & File Number

4. Lot No. _____, Recorded Plat _____
5. Private Claims _____

| | A | B | C | D | E | F | G | H | I | J | K | L | M |
|----|----|----|----|----|----|----|---|---|---|---|---|---|---|
| 2 | 6 | 5 | 4 | 3 | 2 | 1 | | | | | | | |
| 3 | | | | | | | | | | | | | |
| 4 | 7 | 8 | 9 | 10 | 11 | 12 | | | | | | | |
| 5 | | | | | | | | | | | | | |
| 6 | 18 | 17 | 16 | 15 | 14 | 13 | | | | | | | |
| 7 | | | | | | | | | | | | | |
| 8 | 19 | 20 | 21 | 22 | 23 | 24 | | | | | | | |
| 9 | | | | | | | | | | | | | |
| 10 | 30 | 29 | 28 | 27 | 26 | 25 | | | | | | | |
| 11 | | | | | | | | | | | | | |
| 12 | 31 | 32 | 33 | 34 | 35 | 36 | | | | | | | |
| 13 | | | | | | | | | | | | | |

William Lenca in a field survey on July 18, 1995
do hereby certify that under requirements of P.A. 74, Michigan P.A. of 1970, the corner points mentioned in lines 1 and 2 above were in conformance with regulations and rules therefore as required in the current manual of survey instructions of the United States Department of the Interior, Bureau of Land Management or by a decree of a Court of Law and/or that the corner points mentioned in lines 3, 4 and 5 above were in conformance with the rules of the Michigan Board of Land Surveyors or by a Decree of a Court of Law; established, re-established, monumented, re-monumented, recovered, found as expressed below:

NOTE: Not more than 4 corners, all in the same town and range, may be recorded on this certificate.

1. Description of original monument and accessories and/or subsequent restoration:

1848: Original Survey by James H. Mullett - B.T.'s - Hemlock, 10" - N26°E - 20 lks; Cedar, 14" - S45°W - 31 lks. All original evidence for this corner has been destroyed by county road improvements.

1979: Certified Survey No. 170 recorded by George B. Wilson, RLS No. 17607, indicates in the legend that a 1/2" diameter iron pin was set. A bearing and distance of N01°21'33"W, 2689.28 feet is shown between this corner and the 1/4 corner to the South.

2. Description of corner evidence found and/or method applied in restoring or reestablishing corner:

In a April 1995 survey of Section 3, T35N-R27W, we recovered a 1/2" diameter iron pin in the centerline of county roads East - West and South, and in line with an old fence running north. We found that the distance between this corner and the 1/4 corner to the south measured 2689.22 feet, which matches closely with Wilson's distance of 2689.28 feet as recorded in Certified Survey No. 170. This corner position has been used consistently for several years by local surveyors, and is accepted as the best available evidence of the position of the original corner.

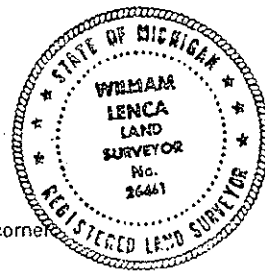

Description of monument for corner and accessories established to perpetuate locating the position of the corner:

Set 2" dia. Aluminum Pipe/3-1/4" dia. Alum cap stamped for corner location;

| | | | |
|---|-------|------------|---------|
| 6" dia. Balsam | N48°E | 42.13 feet | Scr NBT |
| 9" dia. Cedar | S50°W | 39.48 feet | Scr NBT |
| 6" dia. Cedar | N48°W | 38.21 feet | Scr NBT |
| 5/8" x 24" Iron Rod/2" dia. Alum. cap marked "WITNESS MARKER" | S41°E | 46.03 feet | |

NOTE: All bearings are magnetic bearings. All distances are measured with a steel tape. Distances to trees are to nail in side of tree.

signed by William Lenca Date Sept. 6, 1995
Surveyor's Michigan License No. 26461