

MAR 29 2000

SECTION

LAND CORNER RECORDATION CERTIFICATE
Filing Requirement of Act 74, Mich. P.A. 1970

Approved by Menominee County
Land Survey Remonumentation
Peer Group Under Act 345 Of
P.A. Of 1996 On 12/23 1999
Mc Davis RLS
Chairman

For corners in

<u>MENOMINEE</u> (County)	Located In:	Corner Code #
1. Public Land Survey	T <u>35</u> N R <u>27</u> W	<u>L-3</u>
	T ___ R ___	_____
	T ___ R ___	_____
	T ___ R ___	_____
2. Property Controlling in Section	S ___ T ___ R ___	_____
	S ___ T ___ R ___	_____
3. Miscellaneous Property in Sec.	S ___ T ___ R ___	_____
	S ___ T ___ R ___	_____

Bk. 6 Pg. 85

RECEIVED FOR RECORD
28 DEC 1999 3:56:09 PM
BARBARA MORRISON
REGISTER OF DEEDS
MENOMINEE, MI 49858

Register of Deeds Stamp & File Number

4. Lot No. _____, Recorded Plat _____
5. Private Claims _____

I, William Lenca, in a field survey on Oct., 1999 do hereby state that under requirements of P.A. 74, Michigan P.A. of 1970, the corner points mentioned in lines 1 and 2 above were in conformance with regulations and rules therefore as required in the current manual of survey instructions of the United States Department of the Interior, Bureau of Land Management or by a decree of a Court of Law and /or that the corner points mentioned in lines 3, 4 and 5 above were in conformance with the rules of the Michigan Board of Land Surveyors or by a Decree of a Court of Law; established, re-established, monumented, recovered, found as expressed below:

NOTE: Not more than 2 corners, all in the same town and range, may be recorded on this certificate.

A	B	C	D	E	F	G	H	I	J	K	L	M
1												
2	6	5	4	3	2	1						
3												
4	7	8	9	10	11	12						
5												
6	18	17	16	15	14	13						
7												
8	19	20	21	22	23	24						
9												
10	30	29	28	27	26	25						
11												
12	31	32	33	34	35	36						
13												

A. Description of original monument and accessories and/or subsequent restoration:

- 1848: Sectional Subdivision by James H. Mullett - B.T.'s - Cedar, 9" - N55°E - 06 lks.; Black Ash, 4" - S24°W - 21 lks. All original evidence for this corner has been destroyed by years of decay.
- 1896: Subd. of Section 11 by Justus Little shows measurements across the North Line of Section 11. These measurements are considerably short compared to present distances between existing monuments. The corner monument is not shown or described.
- 1980: L.C.R.C. No. 223 by Edward Kazianka, RLS No. 14765 - Set 5/8" x 24" Re-rod at old fence junction. This fits well with stream 6 chains east of corner. TIES: Cedar, 7" - S23°E - 29.75'; Black Ash, 7" - N87°W - 10.20'.

B. Description of corner evidence found and/or method applied in restoring or reestablishing corner:

We found a 5/8 inch x 24 inch re-rod at an ancient fence corner, along with the 2 B.T.'s as described in LCRC No. 223 (see part "A" above). The corner position falls 2662.91 feet East of the SW Corner and 2588.61 feet West of the SE Corner of Section 2, T35N-R27W. The distance East to the Little Cedar River fits well with the GLO call of 6 chains. We accepted the position of the existing 5/8" x 24" re-rod as the best available evidence of the position of the original corner.

C. Description of monument for corner and accessories established to perpetuate locating the position of the corner:

Set 3/4" dia. x 4' long aluminum rod/3-1/4" dia. Alum. cap stamped for corner.

7" dia. Maple	N 04° W	26.54 feet	Scr. NBT
12" dia. Willow	S 72° E	37.21 feet	Scr. NBT
7" dia. W Ash	S 16° E	22.52 feet	Scr. NBT
10 " B. Ash	S 77° W	39.45 feet	Scr. NBT
Metal Survey Sign Post	North	1.05 feet	

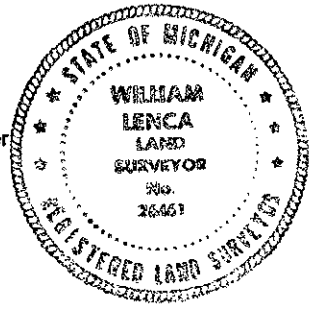

NOTE: All bearings are magnetic bearings. All distances are measured with steel tape. Distances to trees are to nail in side of tree.

Signed by William Lenca Date Nov. 2, 1999
Surveyor's Michigan License No. 26461

85