

APR 06 1999

P.A. Of 1990 On 10/29 1998
James J. Wain P.S.
Chairman

LAND CORNER RECORDATION CERTIFICATE
Filing Requirement of Act 74, Mich. P.A. 1970

For corners in SECTION

MENOMINEE (County)	Located In:	Corner Code #
1. Public Land Survey	T 35N R 27W	K-09
	T ___ R ___	_____
	T ___ R ___	_____
	T ___ R ___	_____
2. Property Controlling in Section	S ___ T ___ R ___	_____
	S ___ T ___ R ___	_____
3. Miscellaneous Property in Sec.	S ___ T ___ R ___	_____
	S ___ T ___ R ___	_____

RECEIVED FOR RECORD
98 DEC 14 PM 3:20
PAGE # 663 BK 5
BARBARA MORRISON
REGISTER OF DEEDS
MENOMINEE MI 49858

Register of Deeds Stamp & File Number

4. Lot No. _____, Recorded Plat _____
5. Private Claims _____

I, William Lenca, in a field survey on May 06, 19 98 do hereby state that under requirements of P.A. 74, Michigan P.A. of 1970, the corner points mentioned in lines 1 and 2 above were in conformance with regulations and rules therefore as required in the current manual of survey instructions of the United States Department of the Interior, Bureau of Land Management or by a decree of a Court of Law and /or that the corner points mentioned in lines 3, 4 and 5 above were in conformance with the rules of the Michigan Board of Land Surveyors or by a Decree of a Court of Law; established, re-established, monumented, recovered, found as expressed below:

NOTE: Not more than 2 corners, all in the same town and range, may be recorded on this certificate.

A	B	C	D	E	F	G	H	I	J	K	L	M
1												
2	6	5	4	3	2	1						
3												
4	7	8	9	10	11	12						
5												
6	18	17	16	15	14	13						
7												
8	19	20	21	22	23	24						
9												
10	30	29	28	27	26	25						
11												
12	31	32	33	34	35	36						
13												

A. Description of original monument and accessories and/or subsequent restoration:

- 1848: Original Survey by James H. Mullett - B.T.'s - Cedar, 42" - S61°E - 28 lks.; Spruce, 7" - N46°W - 12 lks. All original evidence for this corner has been destroyed by county road improvements. Terrain Call: Leave swamp 2.2 Chains West.
- 1900: Albert Hass, County Surveyor, shows this corner as it relates to other corners in Section 24, T35N-R27W. The corner is described as 4" Cedar Post from Gov't B.T. (destroyed by county road improvements.)
- 1981: L.C.R.C. Number 327 by Edward Kazianka states, "Accepted centerlines of county roads to the North, South, East and West as the Section corner and set steel pin below surface of black-top road." Set 5/8" x 12" Iron Pin. TIES: Power Pole - N45°E - 43.43'; Stop Sign - S20°E - 45.07'; Tamarack, 12" - N20°W - 98.43'.

B. Description of corner evidence found and/or method applied in restoring or reestablishing corner:

We found a 5/8" iron pin 12 inches long in the centerline of county roads East - West - North - South as indicated in L.C.R.C. No. 327 by Edward Kazianka, RLS No. 14765. The location of this corner monument matches very closely with Albert Hass' record measurements to corners 1/2 mile East and 1/2 mile North. This position has been used consistently by local surveyors for at least 17 years, and is accepted as the best available evidence of the position of the original corner.

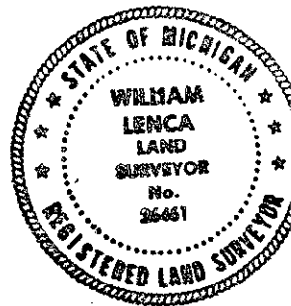

C. Description of monument for corner and accessories established to perpetuate locating the position of the corner:

Set 5/8" x 24" Iron Rod/3-1/4" dia. Alum. cap stamped for corner location in Monument Box:

5/8" x 24" Iron Rod/2" dia. Alum. cap marked "WITNESS MARKER"	N42°E	52.54 feet	@ Sign Post
5/8" x 24" Iron Rod/2" dia. Alum. cap marked "WITNESS MARKER"	S34°E	44.13 feet	1' E. of Rd. Sign
5/8" x 24" Iron Rod/2" dia. Alum. cap marked "WITNESS MARKER"	S58°W	53.11 feet	1.5' S. of Tel. Box
6" dia. Cedar	N38°W	75.17 feet	Scr. NBT
Metal Survey Sign Post	N42°E	53.5 feet	

NOTE: All bearings are magnetic bearings. All distances are measured with steel tape. Distances to trees are to nail in side of tree.

Signed by William Lenca
Surveyor's Michigan License No. 26461

Date Oct. 21, 1998

663