

APR 06 1999

P.A. Of 1990 On 10/29 1998

James L. Winnie, P.S. Chairman

SECTION

LAND CORNER RECORDATION CERTIFICATE Filing Requirement of Act 74, Mich. P.A. 1970

For corners in

Table with columns: MENOMINEE (County), Located In, Corner Code #. Includes entries for Public Land Survey, Property Controlling in Section, and Miscellaneous Property in Sec.

REGISTERED FOR RECORD 98 DEC 14 PM 3:20 PAGE # 666, BKS

Register of Deeds Stamp & File Number

4. Lot No. , Recorded Plat
5. Private Claims

I, William Lenca, in a field survey on June 15, 1998 do hereby state that under requirements of P.A. 74, Michigan P.A. of 1970, the corner points mentioned in lines 1 and 2 above were in conformance with regulations and rules therefore as required in the current manual of survey instructions of the United States Department of the Interior, Bureau of Land Management or by a decree of a Court of Law and /or that the corner points mentioned in lines 3, 4 and 5 above were in conformance with the rules of the Michigan Board of Land Surveyors or by a Decree of a Court of Law, established, re-established, monumented, recovered, found as expressed below:

NOTE: Not more than 2 corners, all in the same town and range, may be recorded on this certificate.

Grid table with columns A-M and rows 1-13. Cell 12, 35 contains a small circle with a dot.

A. Description of original monument and accessories and/or subsequent restoration:

- 1848: Original Survey by James H. Mullett - B.T.'s - Hemlock, 5" - N40°E - 10 fks.; Hemlock, 10" - S66°E - 37 fks. All original evidence for this corner has been destroyed by logging activities.
1989: Certified Survey Number 669 by William Lenca shows this corner in relation to other corners in Section 35, T35N-R27W.

B. Description of corner evidence found and/or method applied in restoring or reestablishing corner:

My Field Notes from a 1988 Survey of Section 35, T35N-R27W, show we found a 1-1/2" diameter Iron Pipe in line with old fences East and North. We took the following ties: Cedar, 8" - N03°E - 4.45'; Cedar, 16" - N89°E - 13.80'; W. Ash, 14" - N72°W - 16.68'. In our 1998 Remonumentation Survey, we recovered a 1-1/2" diameter Iron Pipe 48" long as well as the 3 B.T.'s described above. This location has been used for many years, fits well with established lines of occupation, and is accepted as the best available evidence of the position of the original corner.

C. Description of monument for corner and accessories established to perpetuate locating the position of the corner:

Set 2" dia. Aluminum Pipe/3-1/4" dia. Alum cap stamped for corner location:

Table listing monument types and bearings/distances: 8" dia. Cedar N03°E 4.45 feet, 16" dia. Cedar N89°E 13.75 feet, 12" dia. Cedar S28°W 28.88 feet, 16" dia. White Ash N72°W 16.68 feet, Metal Survey Sign Post South 1.0 feet

NOTE: All bearings are magnetic bearings. All distances are measured with steel tape. Distances to trees are to nail in side of tree.

Signed by [Signature] Surveyor's Michigan License No. 26461

Date Oct. 29, 1998

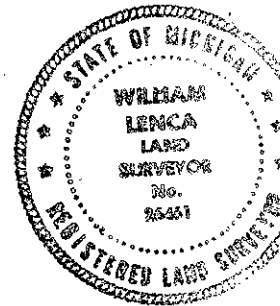

666