

MAR 29 2000

SECTION

LAND CORNER RECORDATION CERTIFICATE
Filing Requirement of Act 74, Mich. P.A. 1970

Approved by Menominee County
Land Survey Remonumentation
Peer Group Under Act 345 Of

PA of 1990 On 12/11 1999
MEL DAVIS RLS
Chairman

BK 6 Pg. 116

RECEIVED FOR RECORD
28 DEC 1999 3:56:09 PM
BARBARA MORRISON
REGISTER OF DEEDS
MENOMINEE, MI 49858

Register of Deeds Stamp & File Number

For corners in

MENOMINEE
(County)

Located In:

Corner Code #

- | | | |
|------------------------------------|--|------------|
| 1. Public Land Survey | T <u>35</u> N R <u>27</u> W | <u>L-5</u> |
| | T <u> </u> R <u> </u> | <u> </u> |
| | T <u> </u> R <u> </u> | <u> </u> |
| | T <u> </u> R <u> </u> | <u> </u> |
| 2. Property Controlling in Section | S <u> </u> T <u> </u> R <u> </u> | <u> </u> |
| | S <u> </u> T <u> </u> R <u> </u> | <u> </u> |
| 3. Miscellaneous Property in Sec. | S <u> </u> T <u> </u> R <u> </u> | <u> </u> |
| | S <u> </u> T <u> </u> R <u> </u> | <u> </u> |

4. Lot No. _____, Recorded Plat _____
5. Private Claims _____

I, William Lenca, in a field survey on Oct., 1999 do hereby state that under requirements of P.A. 74, Michigan P.A. of 1970, the corner points mentioned in lines 1 and 2 above were in conformance with regulations and rules therefore as required in the current manual of survey instructions of the United States Department of the Interior, Bureau of Land Management or by a decree of a Court of Law and /or that the corner points mentioned in lines 3, 4 and 5 above were in conformance with the rules of the Michigan Board of Land Surveyors or by a Decree of a Court of Law; established, re-established, monumented, recovered, found as expressed below:

NOTE: Not more than 2 corners, all in the same town and range, may be recorded on this certificate.

1	A	B	C	D	E	F	G	H	I	J	K	L	M
2	6		5		4		3		2		1		
3													
4	7		8		9		10		11		12		
5													
6	10		17		16		15		14		13		
7													
8	19		20		21		22		23		24		
9													
10	30		29		28		27		26		25		
11													
12	31		32		33		34		35		36		
13													

A. Description of original monument and accessories and/or subsequent restoration:

- 1848: Sectional Subdivision by James H. Mullett - B.F.'s - Hemlock, 8" - S57°W - 06 lks.; Sugar, 8" - N11°W - 05 lks. All original evidence for this corner has been destroyed by county road improvements.
1987: Certified Survey No. 518, by William Lenca, RLS No. 26461, shows a tie to this corner.

B. Description of corner evidence found and/or method applied in restoring or reestablishing corner:

We recovered a railroad spike in the centerline of county roads running North - South and East, and in line with an ancient fence line running West. The position of this corner matches with the tie shown in Certified Survey No. 518, fits with existing lines of occupation, and is accepted as the best available evidence of the position of the original corner.

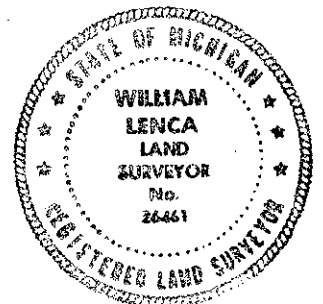

C. Description of monument for corner and accessories established to perpetuate locating the position of the corner:

Set 2" dia. Aluminum Pipe 30" long/3-1/4" dia. Alum cap stamped for corner location:

- | | | | |
|--|---------|------------|-------------------------|
| 5/8" x 24" Iron Rod/2" Alum. cap marked WITNESS MARKER | N 45° E | 42.37 feet | 1' N. of Tel. Cable Box |
| 14" dia. Cedar | S 52° E | 59.35 feet | Scr. NBT |
| 9" dia. Cedar | S 20° W | 62.60 feet | Scr. NBT |
| 12" dia. Maple | S 65° W | 24.33 feet | Scr. NBT |
| Metal Survey Sign Post | N 45° E | 43.10 feet | |

NOTE: All bearings are magnetic bearings. All distances are measured with steel tape. Distances to trees are to nail in side of tree.

Signed by William Lenca
Surveyor's Michigan License No. 26461

Date Nov. 23, 1999