

Approved by Menominee County
 Land Survey Reimbursement
 Peer Group Under Act 345 Of
 P.A. of 1990 On 10/26 19995
Mr. Davis RLS
 Chairman

LAND CORNER RECORDATION CERTIFICATE
 Filing Requirement of Act 74, Mich. P.A. 1970

For corners in

MENOMINEE Located In: Corner Code M-1
 (County)

1. Public Land Survey T 35N R 27W
 T _____ R _____
 T _____ R _____
 T _____ R _____

2. Property Controlling S _____ T _____ R _____
 in Section S _____ T _____ R _____

3. Miscellaneous S _____ T _____ R _____
 Property in Sec. S _____ T _____ R _____

RECEIVED FOR RECORD
 95 NOV - 8 AM 11:32
 BUREAU OF LAND SURVEY
 REGISTERED LAND SURVEYORS
 LANSING, MICHIGAN 48906

Register of Deeds Stamp & File Number

4. Lot No. _____, Recorded Plat _____
 5. Private Claims _____

(T36N-R27W - M-13) (T35N-R26W - A-1) (T36N-R26W - A-13)

I, William Lenca, in a field survey on Aug. 31, 19 95, do hereby certify that under requirements of P.A. 74, Michigan P.A. of 1970, the corner points mentioned in lines 1 and 2 above were in conformance with regulations and rules theretofore as required in the current manual of survey instructions of the United States Department of the Interior, Bureau of Land Management or by a decree of a Court of Law and/or that the corner points mentioned in lines 3, 4 and 5 above were in conformance with the rules of the Michigan Board of Land Surveyors or by a Decree of a Court of Law; established, re-established, monumented, re-monumented, recovered, found as expressed below:

	A	B	C	D	E	F	G	H	I	J	K	L	M
2	6	5	4	3	2	1							
3													
4	7	8	9	10	11	12							
5													
6	13	17	15	14	13								
7													
8	19	20	21	22	23	24							
9													
10	30	29	28	27	26	25							
11													
12	31	32	33	34	35	36							
13													

NOTE: Not more than 4 corners, all in the same town and range, may be recorded on this certificate.

A. Description of original monument and accessories and/or subsequent restoration:

1847: Original Survey by H. Floyd (Township Exterior) - B.T.'s - Hemlock, 14" - S25°E - 35 lks; Hemlock, 22" - N68°W - 32 lks. All original evidence has been destroyed by County Road improvements.

1985: L.C.R.C. No. 712 recorded by William Lenca, RLS No. 26461, states that a Deep-1 Magnet was set in place of an existing P.K. Nail in the centerline of county roads running East - West and North, and in line with an ancient fence running South. TIES: 10" Poplar - N56°W - 68.58'; Tel. Cable Box - S55°W - 47.63'; Stop Sign Post - N18°W - 50.40'; 4" Ced. - N23°E - 120.87'.

B. Description of corner evidence found and/or method applied in restoring or reestablishing corner:

In an August, 1995 survey of Section 1, T35N-R27W, we found a Deep-1 Magnet in the centerline of County Road No. 358 (East - West), and in line with the centerline of a County Road running North and in line with an ancient fence running South from this location. We also found 2 bearing trees (10" Poplar - N56°W - 68.58 feet & 4" Cedar - N23°E - 120.87 feet), as recorded in L.C.R.C. No. 712, described in part "A". The measured distance from this corner to Corner M-2 (E1/4 Cor. of Sec. 1, T35N-R27W) is 2426.97 feet. This compares closely to the GLO distance of 2412.3 feet. This position has been used consistently for several years by local surveyors, and is accepted as the best available evidence of the position of the original corner.

C. Description of monument for corner and accessories established to perpetuate locating the position of the corner:

Set 5/8" x 24" Iron Rod/3-1/4" dia. Alum. cap stamped for corner location in Monument Box:

5/8" x 24" Iron Rod/2" dia. Alum. cap marked "WITNESS MARKER"	N26°E	48.36 feet
5/8" x 24" Iron Rod/2" dia. Alum. cap marked "WITNESS MARKER"	S03°E	34.97 feet
5/8" x 24" Iron Rod/2" dia. Alum. cap marked "WITNESS MARKER"	S55°W	46.11 feet
5/8" x 24" Iron Rod/2" dia. Alum. cap marked "WITNESS MARKER"	N62°W	61.01 feet
Metal Survey Sign Post	S03°W	35.3 feet

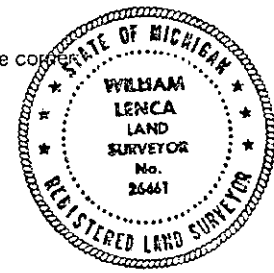

NOTE: All bearings are magnetic bearings. All distances are measured with a steel tape. All distances to trees are to nail in side of tree.

Signed by William Lenca Date Sept. 06, 1995
 Surveyor's Michigan License No. 26461