

P.A. Of 1990 On 10/26 19995

LAND CORNER RECORDATION CERTIFICATE
Filing Requirement of Act 74, Mich. P.A. 1970

Chairman
DANIEL J. DANFORTH
REGISTER OF DEEDS
MICHIGAN
RECEIVED FOR RECORDING
5 NOV - 8 AM 11:32
BK 4

For corners in

MENOMINEE <small>County</small>	Located In:	Corner Code //
1. Public Land Survey	T 35N R 27W	M-2
	T _____ R _____	
	T _____ R _____	
2. Property Controlling in Section	S _____ T _____ R _____	
	S _____ T _____ R _____	
3. Miscellaneous Property in Sec.	S _____ T _____ R _____	
	S _____ T _____ R _____	

Register of Deeds Stamp & File Number

4. Lot No. _____ Recorded Plat _____
5. Private Claims _____
(T35N-R26W - A-2)

	A	B	C	D	E	F	G	H	I	J	K	L	M
2	6	5	4	3	2	1							
3													
4	7	0	9	10	11	12							
5													
6	18	17	16	15	14	13							
7													
8	19	20	21	22	23	24							
9													
10	30	29	28	27	26	25							
11													
12	31	32	33	34	35	36							
13													

I, William Lenca, in a field survey on Aug. 31, 1995, do hereby certify that under requirements of P.A. 74, Michigan P.A. of 1970, the corner points mentioned in lines 1 and 2 above were in conformance with regulations and rules therofore as required in the current manual of survey instructions of the United States Department of the Interior, Bureau of Land Management or by a decree of a Court of Law and/or that the corner points mentioned in lines 3, 4 and 5 above were in conformance with the rules of the Michigan Board of Land Surveyors or by a Decree of a Court of Law; established, re-established, monumented, re-monumented, recovered, found as expressed below:

NOTE: Not more than 4 corners, all in the same town and range, may be recorded on this certificate.

A. Description of original monument and accessories and/or subsequent restoration:

- 1847: Original Survey by H. Floyd (Township Exterior) - B.T.'s - Becch, 8" - N31°W - 27 lks; Becch, 12" - N55°E - 09 lks. All original evidence has been destroyed by farming activities.
- 1986: Certified Survey No. 474 recorded by William Lenca, RLS No. 26461, shows Corner M-2 as it relates to Corner K-2 (W1/4 Cor. Sec. 1, 35/27). The corner monument is not described.

B. Description of corner evidence found and/or method applied in restoring or reestablishing corner:

In an August, 1995 survey of Section 1, T35N-R27W, we found a 1/2 inch diameter Iron Pin in line with ancient fence lines running North and West from this location. The measured distance from this corner North to the NE Corner of Sec. 1, T35N-R27W is 2426.97 feet. This matches very closely with the GLO distance of 2412.3 feet. This position has been used consistently for several years by local surveyors, and is accepted as the best available evidence of the position of the original corner.

C. Description of monument for corner and accessories established to perpetuate locating the position of the corner:

Set 5/8" x 30" Iron Rod/3-1/4" dia. Alum. cap stamped for corner location:

5/8" x 24" Iron Rod/2" dia. Alum. cap marked "WITNESS MARKER"	N17°E	9.58 feet
13" dia. Maple	N88°E	21.31 feet
Metal Survey Sign Post	N27°W	4.6 feet

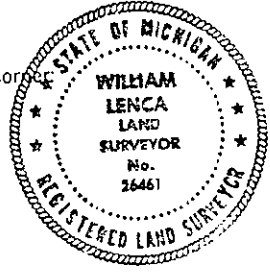

NOTE: All bearings are magnetic bearings. All distances are measured with a steel tape. All distances to trees are to nail in side of tree.

Signed by William Lenca Date Sept. 06, 1995
Surveyor's Michigan License No. 26461

SURVEY 3
 DEC 1995