

LAND CORNER RECORDATION CERTIFICATE
 Filing Requirement of Act 74, Mich. P.A. 1970

For corners in
MENOMINEE
 (County)

Located In: Corner Code #

1. Public Land Survey T35N R. 28W B-7
 T R
 T R
 T R

2. Property Controlling in Section S T R
 S T R

3. Miscellaneous Property in Sec. S T R
 S T R

4. Lot No. _____, Recorded Plat _____
 5. Private Claims _____

RECORDED FOR RECORD
 97 JUL 23 PM 3:34
 PAGE # 491, 495
 BARBARA MORRISON
 REGISTER OF DEEDS
 MENOMINEE, MI 49858
 Register of Deeds Stamp & File Number

I, William Lenca, in a field survey on Apr. 03, 19 97 do hereby state that under requirements of P.A. 74, Michigan P.A. of 1970, the corner points mentioned in lines 1 and 2 above were in conformance with regulations and rules therefore as required in the current manual of survey instructions of the United States Department of the Interior, Bureau of Land Management or by a decree of a Court of Law and/or that the corner points mentioned in lines 3, 4 and 5 above were in conformance with the rules of the Michigan Board of Land Surveyors or by a Decree of a Court of Law; established, re-established, monumented, recovered, found as expressed below:

NOTE: Not more than 2 corners, all in the same town and range, may be recorded on this certificate.

	A	B	C	D	E	F	G	H	I	J	K	L	M
1													
2		6		5		4		3		2		1	
3													
4		7		8		9		10		11		12	
5													
6		18		17		16		15		14		13	
7													
8		19		20		21		22		23		24	
9													
10		30		29		28		27		26		25	
11													
12		31		32		33		34		35		36	
13													

A. Description of original monument and accessories and/or subsequent restoration:

- 1852: Original Survey by Francis Coleman - B.T.'s - Y. Pine, 18" - N11°W - 2.63 lks.; Y. Pine, 18" - S33°E - 4.87 lks. All original evidence for this corner has been destroyed by logging activities.
- 1949: Park Survey by Robert Olsen states "Iron Pin on fence line" - B.T.'s - 10" J. Pine - S05°E - 25.8 feet, 4" J. Pine - S45°E - 10.6 feet.
- 1961: Subd. of Section 18 by Dean Delamater indicates a monument at this location with ties to other corners. The monument is not described, but the map symbol is identical to other symbols described as "T" iron. No B.T.'s are given.

B. Description of corner evidence found and/or method applied in restoring or reestablishing corner:

In a 1992 survey of Section 18, we recovered a "T" iron with a 1" diameter metal cap marked DELAMATER/MUSCHELL, ENGINEERS/SURVEYORS, CHEBOYGAN MICH. The corner falls on an ancient fence line running East as indicated in the 1949 Park Survey and matches closely with the distance East to the SE Corner of Section 18. Robert Olsen's Survey indicates this distance as 2640'; Delamater's distance shows the distance as 2638.37 feet. Our measured distance between these corners is 2637.65 feet. We set a 3/4" x 30" aluminum rod with a 2-1/2" aluminum cap in place of the existing "T" iron. Olsen's B.T.'s had been destroyed. In April of 1997, we recovered our monument which we had set in 1992 and accepted it as the best available evidence of the position of the original corner.

C. Description of monument for corner and accessories established to perpetuate locating the position of the corner:
 Accepted existing 3/4" dia. Alum. rod/2-1/2 Alum. cap stamped for corner location:

12" Norway	N05°E	104.46 feet	Scr. NBT
8" dia. Oak	S49°E	24.74 feet	Scr. NBT
9" dia. Oak	S14°W	46.73 feet	Scr. NBT
9" dia. Oak	S78°W	36.45 feet	Scr. NBT
Carsonite Marker	N71°E	1.8 feet	

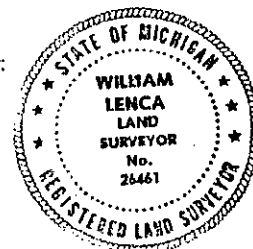

NOTE: All bearings are magnetic bearings. All distances are measured with steel tape. Distances to trees are to nail in side of tree.

Signed by William Lenca Date Apr. 07, 1997
 Surveyor's Michigan License No. 26461

REMONUMENTATION

DEC 22 1997

COMMISSION

491