

LAND CORNER RECORDATION CERTIFICATE  
 Filing Requirement of Act 74, Mich. P.A. 1970

For corners in

<u>MENOMINEE</u> (County)	Located In:	Corner Code #
1. Public Land Survey	T <u>35N</u> R <u>28W</u>	<u>C-6</u>
	T <u>    </u> R <u>    </u>	<u>    </u>
	T <u>    </u> R <u>    </u>	<u>    </u>
	T <u>    </u> R <u>    </u>	<u>    </u>
2. Property Controlling in Section	S <u>    </u> T <u>    </u> R <u>    </u>	<u>    </u>
	S <u>    </u> T <u>    </u> R <u>    </u>	<u>    </u>
3. Miscellaneous Property in Sec.	S <u>    </u> T <u>    </u> R <u>    </u>	<u>    </u>
	S <u>    </u> T <u>    </u> R <u>    </u>	<u>    </u>

RECEIVED FOR RECORD  
 97 JUL 23 PM 3:34  
 PAGE # 492 BK 5  
 BARBARA MORRISON  
 REGISTER OF DEEDS  
 MENOMINEE COUNTY  
 Register of Deeds Stamp & File Number

4. Lot No. \_\_\_\_\_, Recorded Plat \_\_\_\_\_  
 5. Private Claims \_\_\_\_\_

I, William Lenca, in a field survey on Apr. 03, 19 97 do hereby state that under requirements of P.A. 74, Michigan P.A. of 1970, the corner points mentioned in lines 1 and 2 above were in conformance with regulations and rules therefore as required in the current manual of survey instructions of the United States Department of the Interior, Bureau of Land Management or by a decree of a Court of Law and for that the corner points mentioned in lines 3, 4 and 5 above were in conformance with the rules of the Michigan Board of Land Surveyors or by a Decree of a Court of Law; established, re-established, monumented, recovered, found as expressed below:

NOTE: Not more than 2 corners, all in the same town and range, may be recorded on this certificate.

A	B	C	D	E	F	G	H	I	J	K	L	M
1												
2	6	5	4	3	2	1						
3												
4	7	8	9	10	11	12						
5												
6	10	17	16	15	14	13						
7												
8	19	20	21	22	23	24						
9												
10	30	29	28	27	26	25						
11												
12	31	32	33	34	35	36						
13												

A. Description of original monument and accessories and/or subsequent restoration:

- 1852: Original Survey by Francis Coleman - B.T.'s - W. Pine, 18" - N34°E - 88 lks.; Y. Pine, 12" - S63°W - 119 lks. All original evidence for this corner has been destroyed by fire.
- 1961: Subd. of Section 18 by Dean Delamater indicates a "T" iron was set by single proportion - B.T.'s: 8" W. Pine - S73°E - 16.35'; 20" R. Pine - N40°W - 35.00'; 12" J. Pine - S43°W - 23.00'.
- 1961: PLAT OF FOREST ACRES, recorded by Dean Delamater shows a tie to this corner.
- 1991: CERTIFIED SURVEY No. 769 by William Lenca, RLS No. 26461, shows this corner as it relates to other corners in Section 18.

B. Description of corner evidence found and/or method applied in restoring or reestablishing corner:

In a 1997 survey of Section 18, we recovered a "T" iron with a 1" diameter metal cap marked DELAMATER/MUSCHELL, ENGINEERS/SURVEYORS, CHEBOYGAN MICH. along with the 3 B.T.'s described in part A above. The corner falls within 0.7 feet of splitting the mile and 0.31 feet from a straight line between section corners, and is accepted as a careful and faithful reestablishment of the position of the original corner.

C. Description of monument for corner and accessories established to perpetuate locating the position of the corner:  
 Set 2" dia. Aluminum Pipe/3-1/4" dia. Alum cap stamped for corner location over existing "T" iron:

20" dia. White Pine (Ex. B.T.)	S73°E	16.30 feet	Scr. NBT
10" dia. Jack Pine	S00°E	26.86 feet	Scr. NBT
16" dia. Jack Pine (Ex. B.T.)	S43°W	23.04 feet	Scr. NBT
24" dia. Norway Pine (Ex. B.T.)	N40°W	35.18 feet	Scr. NBT
Metal Survey Sign Post	East	0.8 feet	

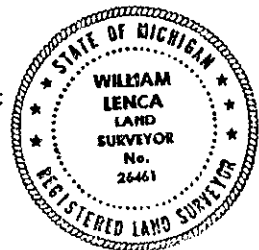

NOTE: All bearings are magnetic bearings. All distances are measured with steel tape. Distances to trees are to nail in side of tree.

Signed by William Lenca Date Apr. 07, 1997  
 Surveyor's Michigan License No. 26461

REMONUMENTATION

DEC 22 1997

COMMISSION

492